

40-05 CRESCENT STREET
QUEENS, NEW YORK

Remedial Action Report

NYC VCP Number: 15CVCP021Q
NYC OER Project Number: 14EHAZ208Q

Prepared For:
Crescent Owners, LLC
40-05 Crescent Street
Queens, New York 11101
gregk@centralcmlc.com; mdifonzo@centralcmlc.com

Prepared By:



ATHENICA ENVIRONMENTAL
SERVICES, INC.
Environmental Engineering Consultants
Spiro Dongaris, P.E.
Athenica Environmental Services
45-09 Greenpoint Avenue, Queens, NY 11104
(718) 784-7490
sdongaris@athenica.com

OCTOBER 2018

REMEDIAL ACTION REPORT

TABLE OF CONTENTS

LIST OF ACRONYMS	6
CERTIFICATION	7
EXECUTIVE SUMMARY	8
REMEDIAL ACTION REPORT	17
1.0 SITE BACKGROUND	17
1.1 SITE LOCATION AND BACKGROUND	17
1.2 REDEVELOPMENT PLAN.....	17
1.3 DESCRIPTION OF SURROUNDING PROPERTY.....	18
1.4 SUMMARY OF PAST SITE USES AND AREAS OF CONCERN.....	18
1.5 SUMMARY OF WORK PERFORMED UNDER THE REMEDIAL INVESTIGATION....	19
1.6 SUMMARY OF FINDINGS OF REMEDIAL INVESTIGATION	19
2.0 DESCRIPTION OF REMEDIAL ACTIONS.....	22
3.0 COMPLIANCE WITH REMEDIAL ACTION WORK PLAN	26
3.1 CONSTRUCTION HEALTH & SAFETY PLAN.....	26
3.2 COMMUNITY AIR MONITORING PLAN.....	26
3.3 SOIL/MATERIALS MANAGEMENT PLAN.....	26
3.4 STORM-WATER POLLUTION PREVENTION	26
3.5 DEVIATIONS FROM THE REMEDIAL ACTION WORK PLAN.....	27
4.0 REMEDIAL PROGRAM	29
4.1 PROJECT ORGANIZATION.....	29
4.2 SITE CONTROLS	29
4.3 MATERIALS EXCAVATION AND REMOVAL ACTION.....	31
4.4 MATERIALS DISPOSAL.....	34
4.5 BACKFILL IMPORT	36
4.6 DEMARCATION	36
5.0 ENGINEERING CONTROLS.....	37
6.0 INSTITUTIONAL CONTROLS.....	39
7.0 SITE MANAGEMENT PLAN	40
8.0 SUSTAINABILITY REPORT	41

FIGURES

Figure 1: Site Location Map

Figure 2: Site Boundary Map

Figure 3: Development Plan

Figure 4: Map of end-point sample locations

Figure 5: Map showing location and approximate depth of excavations

Figure 6: Map showing location of lead hotspot, UST & associated end-point sample locations

Figure 7: As-built design detail for Composite Cover & Vapor Barrier System

Figure 8: Map of location of Composite Cover

Figure 9: Map of location of Vapor Barrier System

TABLES

Table 1: Summary of end-point analytical results

Table 2: List of SCOs

Table 3: Disposal quantities and disposal facilities

APPENDICES

Appendix A: Remedial Investigation Report and Addendum to Remedial Investigation Report

Appendix B: Remedial Action Work Plan & Stipulation List

Appendix C: Daily and Monthly Reports to OER

Appendix D: CAMP Results

Appendix E: Photographs of Remedial Action

Appendix F: Disposal Facility Requests, Historic Fill Notification Forms, and Approval Letters

Appendix G: Shipping and Disposal Manifests

Appendix H: Disposal Characterization Sample Laboratory Testing Results

Appendix I: End-point Sample Analytical Laboratory Data

Appendix J: Documentation for Vapor Barrier System

Appendix K: UST Tank Closure Documentation

LIST OF ACRONYMS

Acronym	Definition
CAMP	Community Air Monitoring Plan
DER-10	NYS DEC Division of Environmental Remediation Technical Guidance Manual 10
DUSR	Data Usability Summary Report
EC	Engineering Control
HASP	Health and Safety Plan
IC	Institutional Control
NYC VCP	New York City Voluntary Cleanup Program
NYC DEP	New York City Department of Environmental Protection
NYC DOHMH	New York City Department of Health and Mental Hygiene
NYC OER	New York City Office of Environmental Remediation
NYS DEC	New York State Department of Environmental Conservation
ORC	Oxygen Release Compound
PID	Photoionization Detector
QA/QC	Quality Assurance/Quality Control
QEP	Qualified Environmental Professional
RAR	Remedial Action Report
RAWP	Remedial Action Work Plan
RCA	Recycled Concrete Aggregate
SCG	Standards, Criteria and Guidance
SCO	Soil Cleanup Objective
SMMP	Soil/Materials Management Plan
SMP	Site Management Plan
SPDES	State Pollutant Discharge Elimination System
SVOCs	Semi-Volatile Organic Compounds
UST	Underground Storage Tank
VOCs	Volatile Organic Compounds

CERTIFICATION

I, Spiro Dongaris, certify the following:

- I am currently a registered professional engineer licensed by the State of New York.
- I performed professional engineering services and had primary direct responsibility for implementation of the remedial program for the 40-05 Crescent Street site, site number 15CVCP021Q.
- I have reviewed this document, to which my signature and seal are affixed.
- The vapor barrier and composite cover system constructed during this remedial action were designed by me or a person under my direct supervision and achieve the goals established in the Remedial Action Work Plan for this site.
- The vapor barrier and composite cover system constructed during this remedial action were professionally observed by me or by a person under my direct supervision are accurately reflected in the text and drawings for as-built design reported in this Remedial Action Report.
- The NYC OER-approved Remedial Action Work Plan dated July 2014 and Stipulations in a letter dated February 5, 2015 were implemented and that all requirements in those documents have been substantively complied with. I certify that contaminated soil, fill, liquid or other material from the property was taken to facilities licensed to accept this material in full compliance with applicable laws and regulations.

Name

Spiro I. Dongaris

PE License Number

095954.

Signature



Date

10/20/18.



EXECUTIVE SUMMARY

Crescent Owners, LLC has enrolled in the New York City Voluntary Cleanup Program (NYC VCP) to investigate and remediate a property located at 40-01 to 40-07 Crescent Street in the Dutch Kills section of Queens, New York. A Remedial Investigation (RI) was performed to compile and evaluate data and information necessary to develop a Remedial Action Work Plan (RAWP). A remedial action was performed pursuant to the NYC OER-approved RAWP in a manner that has rendered the Site protective of public health and the environment consistent with the proposed use of the property. This RAR describes the remedial action performed under the RAWP. The remedial action described in this document provides for the protection of public health and the environment and complies with applicable environmental standards, criteria and guidance and applicable laws and regulations.

Site Location and Background

The Site is located at 40-01 to 40-07 Crescent Street in the Dutch Kills section of Queens, New York and is identified as Block 406 and Lot 24 on the New York City Tax Map. The Site is 12,524-square feet and is bounded by 40th Avenue to the north, a storage yard to the south, 1-story warehouse to the east, and Crescent Street to the west.

Prior to redevelopment, the Site was used for offices and storage and contained a 1-story commercial warehouse that covered the entire footprint of the Site.

Summary of Redevelopment Plan

The use of the Site consists of a new 5-story mixed commercial and residential use building with a cellar and sub-cellar. The lot is 12,524-square feet in area and the total gross square footage of the building is 65,234-square feet. There are two setbacks of 25 feet at the 4th and 5th floors facing 40th Avenue and Crescent Street. The 1st floor consists of accessory parking and loading areas, accessory storage space, warehouse space, commercial office lobby, recreation area, and residential lobby. The 2nd floor consists of commercial office space, tenant courtyard area, and residential apartments. Floors 3 through 5 consist of residential apartments and tenant

terraces. Open space will be located in three indentations of the building along 40th Avenue and Crescent Street as well as the residential lobby.

The cellar and sub-cellar are utilized as a 48-space parking garage, sprinkler room, trash room, storage, mechanical and electrical rooms, meter room, and elevator control rooms. The cellar and sub-cellar floor area is approximately 12,276-square feet each. For development purposes, the entire Site was excavated between approximately 24 and 28 feet across the Site (due to natural slope of Site) and approximately 31 feet for the elevator pit. The foundations of the building are spread footings with slab on grade. A total of approximately 18,205 tons of soil was excavated and removed from the site. Groundwater is approximately 34 to 38 feet below grade at the Site and was not encountered during excavation.

Summary of Description of Surrounding Property

The area surrounding the property consists of primarily commercial and residential buildings. The north-adjacent property, across 40th Avenue, consists of a 1-story commercial upholstery studio, and a 3- to 4-story mixed commercial and residential use structure occupied on the ground floor by a restaurant and construction company. The west-adjacent property, across Crescent Street, consists of a 5-story mixed commercial and residential building. The south-adjacent property is currently undeveloped and utilized as a yard for a water tank contracting company. The east-adjacent property consists of a 1-story commercial warehouse. There are two sensitive receptors (such as schools, hospitals and day-care facilities) within a 500-foot radius of the Site. Growing Up Green Charter School is located approximately 250 feet east of the Site. Newcomers High School is located approximately 475 feet south-southeast of the Site.

Summary of Past Site Uses and Areas of Concern

Based upon the review of the Phase I Environmental Site Assessment (ESA) Report prepared by Merritt Environmental Consulting in May 2012, a Site history was established. The Site was developed prior to 1898 with multiple 1 and 2-story structures. The uses of the buildings were not listed. The Site was then utilized as a heating equipment warehouse in 1950 and as a 1-story commercial building between 1970 and 2006. Prior to redevelopment, the 1-story commercial building was utilized for commercial offices and storage.

The only AOC identified for the Site during the remedial investigation was urban fill to 8 feet below grade.

Summary of the Work Performed under the Remedial Investigation

Athenica performed the following scope of work at the Site utilizing a phased approach between June 2012 and February 2014:

1. Conducted a Site inspection to identify AOCs and physical obstructions (i.e. structures, buildings, etc.);
2. Installed seven (7) soil borings across the entire project Site, and collected fourteen (14) soil samples for chemical analysis from the soil borings to evaluate soil quality;
3. Installed three (3) groundwater monitoring wells throughout the Site to establish groundwater flow and collected two (2) groundwater samples for chemical analysis to evaluate groundwater quality (the third well was dry during the groundwater sampling event);
4. Installed four (4) soil vapor probes around Site perimeter and collected four (4) soil vapor samples for chemical analysis;
5. Installed an additional two (2) soil borings in the northern portion of the Site after building demolition, and collected four (4) additional soil samples to complete the scope of the remedial investigation; and
6. Installed one (1) additional groundwater monitoring well on the eastern portion of the Site after building demolition, and collected an additional one (1) groundwater sample to complete the scope of the remedial investigation.

Summary of Findings of Remedial Investigation

1. Elevation of the property ranges from 65 to 79 feet.
2. Depth to groundwater ranges from 33.90 to 37.55 feet at the Site.

3. Since only two (2) wells could be monitored and sampled during the initial phase of the RI, the actual direction of groundwater flow could not be determined during the RI. The groundwater flow is presumed to be generally towards west, following the topography.
4. Bedrock was not encountered during the RI.
5. The stratigraphy of the Site, from the surface down, consists of 8 feet of urban fill, 4 feet of medium sand with gravel, and 12 to 24 feet of fine grained silty sand.
6. Soil/fill samples collected during the RI were compared to 6 NYCRR Part 375-6.8 Track 1 Unrestricted Soil Cleanup Objectives (SCOs) and Track 2 Restricted Residential Use SCOs. No PCBs were detected, and no SVOCs or Pesticides above Track 1 Unrestricted SCOs were identified in any of the soil samples. Soil sampling results showed no VOCs except for acetone (max. of 0.0682 ppm) above Unrestricted Use SCOs. Trichloroethene (TCE, max 4.4 ppb) and tetrachloroethene (PCE, max 4.6 ppb) were detected only at trace levels. Four (4) metals, copper (max. of 52.6 ppm), lead (max. of 238 ppm), zinc (max. of 239 ppm) and mercury (max. of 0.69 ppm) were identified above Track 1 Unrestricted SCOs in five of the soil samples. None of these metals exceeded their respective Track 2 Residential SCOs in five shallow soil samples. Overall, the findings were consistent with observations for historic fill sites in areas throughout NYC.
7. Groundwater samples collected during the RI showed no pesticides or PCBs and no SVOCs above Class GA Groundwater Standards (GQS). Three (3) VOCs, 1,1,1-trichloroethane (10 µg/L), 1,1-dichloroethylene (7.9 µg/L), and PCE (20 µg/L) exceeded their respective GQS in one of the groundwater samples. Trace levels of TCE, tert-butylbenzene, and chloroform were also detected. No other VOCs were identified above GQS in any of the groundwater samples. Several metals were identified in both groundwater samples, but only four (4) dissolved metals, magnesium, manganese, selenium and sodium were identified above their respective GQS.
8. Soil vapor samples collected during the RI showed low to moderate levels of petroleum-related and chlorinated VOCs. BTEX were detected at a maximum concentration of 131.4 µg/m³. PCE was detected in all four of the soil vapor samples, at a maximum concentration of 220 µg/m³. TCE was detected in two of the soil vapor samples, at a

maximum concentration of 48 $\mu\text{g}/\text{m}^3$. 1,1,1-Trichloroethane (TCA) was detected in all four samples, at maximum concentration of 29 $\mu\text{g}/\text{m}^3$. Carbon tetrachloride was not detected in any of the samples.

9. Soil/fill samples collected during the additional RI were compared to NYSDEC 6NYCRR Part 375-6.8 Unrestricted Use Soil Cleanup Objectives (SCOs) and Restricted Residential Use SCOs. Only two VOCs; acetone and 2-butanone were detected at trace concentration during the additional RI (acetone is a common lab contaminant), but both were detected below their respective Unrestricted Use SCOs. No SVOCs, pesticides or PCBs were detected above their respective method detection limits (MDLs) in any of the soil samples. Several metals were detected in the soil samples above their MDLs, however none were above their respective Unrestricted Use SCOs.
10. Groundwater samples collected during the additional RI were compared to NYSDEC 6NYCRR Part 703.5 Class GA Groundwater Quality Standards (GQS). Several VOCs were detected above their respective MDLs; with three (3) of them exceeding their respective GQS. These VOCs are 1,2,4-trimethylbenzene (90 $\mu\text{g}/\text{L}$), 1,3,5-trimethylbenzene (31 $\mu\text{g}/\text{L}$), and n-propylbenzene (27 $\mu\text{g}/\text{L}$). Several SVOCs were detected above their respective MDLs; with one (1) of them exceeding their respective GQS. This SVOC is naphthalene (46.8 $\mu\text{g}/\text{L}$). Several dissolved metals were detected above their respective MDLs, with three (3) of them exceeding their respective GQS. These dissolved metals are antimony (6 $\mu\text{g}/\text{L}$), manganese (1,610 $\mu\text{g}/\text{L}$), and sodium (80,600 $\mu\text{g}/\text{L}$). One PCB was detected above their respective MDL, but was below its respective GQS.

For more detailed results, consult the RIR and the RIR Addendum. Based on an evaluation of the data and information from the RIR and this RAWP, disposal of significant amounts of hazardous waste was not suspected at this site.

Summary of the Remedial Action

The Remedial Action achieved protection of public health and the environment for the intended use of the property. The Remedial Action achieved all of the Remedial Action Objectives established for the project; addressed applicable standards, criteria, and guidance;

reduced mobility, toxicity and volume of contaminants; was cost effective and implementable; and used standard methods that are well established in the industry. The remedial action is effective in the short-term and long-term.

A summary of the milestones achieved in the Remedial Action is as follows: A Pre-Application Meeting was held on October 22, 2013. A Remedial Investigation (RI) was performed from June, 2012 and May, 2016. A RI Report was prepared to evaluate data and information necessary to develop a Remedial Action Work Plan (RAWP). A Site Contact List was established. A draft RAWP was prepared and released with a Fact Sheet on September 26, 2014 for a 30-day public comment period. The RAWP and Stipulation List dated February 5, 2015 was approved by the New York City Office of Environmental Remediation (NYC OER) on February 26, 2015. Site briefings were conducted with New York State Department of Environmental Conservation (NYSDEC) on October 3, 2014. A Pre-Construction Meeting was held on October 20, 2015. A Fact Sheet providing notice of the start of the remedial action was issued on October 27, 2015. The remedial action was begun on September 23, 2016 and completed in July 2017.

The remedial action consisted of the following tasks:

1. Prepared a Community Protection Statement and implemented a Citizen Participation Plan.
2. Mobilized site security and equipment; completed utility mark outs; and marked and staked excavation areas.
3. Additional soil and groundwater investigations were performed to supplement investigation data due to site access issues. Four (4) soil and one (1) groundwater samples were collected, and results were submitted to the NYC OER on May 26, 2016 through the Addendum to Remedial Investigation Report.
4. Performed Waste Characterization Study prior to excavation activities. Nine (9) waste characterization soil samples were collected on May 5, 2016. Two (2) soil samples were collected on May 20, 2016 to delineate a lead hotspot identified in waste characterization sample WC-3 (0-4'). Ten (10) extractable petroleum hydrocarbons (EPH) soil samples for waste characterization were collected on September 16, 2016. Waste characterization samples were collected at a frequency dictated by disposal facility(s).

5. Performed a Community Air Monitoring Program for particulates and volatile organic carbon compounds.
6. Selected NYSDEC Part 375 Track 1 Unrestricted Use Soil Cleanup Objectives (SCOs).
7. The following excavations were performed: soil was excavated to a depth of 24 to 28 feet below grade surface across the Site with an additional 5-foot excavation for the elevator pit. Prior to soil excavation, soil/fill containing hazardous lead was removed from the lead hotspot area identified during waste characterization. A total of 18,204.85 tons of soil/fill was excavated and removed from the property.
8. Excavated 2,629.64 tons of non-hazardous soil/fill and transported it to Kearny Point Industrial Park Site (KPIP), 77 Hackensack Avenue, Kearny, New Jersey; excavated 48.70 tons of hazardous characteristic soil/fill and transported to Clean Earth of North Jersey (CENJ), 115 Jacobus Avenue, Kearny, New Jersey; excavated approximately 9,780 tons of clean soil and transported it to Evergreen Recycling of Corona, Willets Point Boulevard and 35th Avenue, Flushing, New York; excavated 706.51 tons of clean soil and transported to Wards Island Waste Water Treatment Facility, 7 Central Road, New York, New York utilizing the NYC Clean Soil Bank; excavated approximately 1,440 tons of clean soil and transported to 832 Lexington Avenue, Brooklyn, New York utilizing the NYC Clean Soil Bank; and excavated approximately 3,600 tons of clean soil and transported to 1525 Bedford Avenue, Brooklyn, New York utilizing the NYC Clean Soil Bank.
9. Screened excavated soil/fill during intrusive work for indications of contamination by visual means, odor, and monitoring with a PID.
10. Conducted materials management of excavated materials including temporarily stockpiling and segregating in accordance with defined material types and to prevent co-mingling of contaminated material and non-contaminated materials.
11. Appropriately segregated excavated media onsite prior to disposal. Transported and disposed all soil/fill material at permitted facilities in accordance with all applicable laws and regulations for handling, transporting, and disposing, and the RAWP.
12. Collected and analyzed five (5) post-excavation confirmation samples to determine attainment of SCOs. Track 1 Unrestricted Use SCOs were achieved.

13. Removed one (1) 5000-gal fuel oil underground storage tank in compliance with applicable laws and regulations. A FDNY tank removal affidavit and NYSDEC tank registration were obtained.
14. As part of development, constructed an engineered Composite Cover System consisting of 30 inches of reinforced concrete slab, including 2 inches of rigid insulation board, underlain by compacted native soil covering the entire footprint of the Site. The contractor for the Composite Cover System construction was Central Construction Management.
15. As part of development, installed a Vapor Barrier System that consisted of Soprema Colphene BSW H, a 140-mil styrene-butadiene-styrene (SBS)-modified bitumen, self-adhered membrane which is sealed utilizing a heat welding device below the building slab and Soprema Colphene BSW V, a 120-mil barrier behind foundation sidewalls. The contractor for the Vapor Barrier System construction was Central Construction Management.
16. On February 2, 2017, as requested by the NYC OER, Athenica performed a second round of soil vapor sampling in the planned locations of the storage and sprinkler rooms (areas that were not to be utilized as parking garage). These results showed lower PCE and TCE concentrations than were detected in the initial soil vapor samples. As a result, it was concluded that the vapor barrier system to be installed below the foundation would sufficiently mitigate potential vapor intrusion in these areas. Further, the construction of a cellar and sub-cellar ventilated parking garage minimizes the potential risk of exposure to soil vapor. As such, Athenica received NYC OER authorization to waive the requirements for a passive sub-slab depressurization system. The NYC OER correspondence waiving the requirements for the SSDS is presented in Appendix L.
17. As part of development, constructed a multi-level sub-grade ventilated parking garage, which will be operated as per NYC Department of Building's codes and requirements.
18. Performed all activities required for the Remedial Action, including permitting requirements and pretreatment requirements, in compliance with applicable laws and regulations.
19. Implemented storm-water pollution prevention measures in compliance with applicable laws and regulations.

20. Submitted daily and monthly reports during construction oversight activities. Daily and monthly reports were submitted from September 23, 2016 to February 26, 2016.
21. Submitted a Sustainability Report.
22. Submitted a Remedial Action Report (RAR) that describes the Remedial Action; certifies that the remedial requirements defined in the RAWP have been achieved; defines the Site boundaries; and lists any changes from the RAWP.

REMEDIAL ACTION REPORT

1.0 SITE BACKGROUND

Crescent Owners, LLC has enrolled in the New York City Voluntary Cleanup Program (NYC VCP) to investigate and remediate a property located at 40-01 to 40-07 Crescent Street in the Dutch Kills section of Queens, New York. The boundary of the property subject to this Remedial Action is shown in Figure 1 and includes, in its entirety, Queens Block 406 and Lot 24. The Remedial Action was performed pursuant to the NYC OER-approved RAWP in a manner that has rendered the property protective of public health and the environment consistent with its intended use. This RAR describes the Remedial Action performed under the RAWP. The remedial action described in this document provides for the protection of public health and the environment and complies with applicable environmental standards, criteria and guidance (SCGs) and applicable laws and regulations.

1.1 SITE LOCATION AND BACKGROUND

The Site is located at 40-01 to 40-07 Crescent Street in the Dutch Kills section of Queens, New York and is identified as Block 406 and Lot 24 on the New York City Tax Map. The Site is 12,524-square feet and is bounded by 40th Avenue to the north, a storage yard to the south, 1-story warehouse to the east, and Crescent Street to the west. A map of the site boundary is shown in Figure 2. Prior to redevelopment, the Site was used for offices and storage and contained a 1-story commercial warehouse that covered the entire footprint of the Site.

The Site Location Map is shown in Figure 1. The Site Boundary Map is shown in Figure 2.

1.2 REDEVELOPMENT PLAN

The use of the Site consists of a new 5-story mixed commercial and residential use building with a cellar and sub-cellar. The lot is 12,524-square feet in area and the total gross square footage of the building is 65,234-square feet. There are two setbacks of 25 feet at the 4th and 5th floors facing 40th Avenue and Crescent Street. The 1st floor consists of accessory parking and loading areas, accessory storage space, warehouse space, commercial office lobby, recreation area, and residential lobby. The 2nd floor consists of commercial office space, tenant courtyard

area, and residential apartments. Floors 3 through 5 consist of residential apartments and tenant terraces. Open space will be located in three indentations of the building along 40th Avenue and Crescent Street as well as the residential lobby.

The cellar and sub-cellar are utilized as a 48-space parking garage, sprinkler room, trash room, storage, mechanical and electrical rooms, meter room, and elevator control rooms. The cellar and sub-cellar floor area is approximately 12,276-square feet each. For development purposes, the entire Site was excavated between approximately 24 and 28 feet across the Site (due to natural slope of Site) and approximately 31 feet for the elevator pit. The foundations of the building are spread footings with slab on grade. A total of approximately 18,205 tons of soil was excavated and removed from the site. Groundwater is approximately 34 to 38 feet below grade at the Site and was not encountered during excavation.

A map showing the building location, basement location and open space location is shown in the Development Plan in Figure 3.

1.3 DESCRIPTION OF SURROUNDING PROPERTY

The area surrounding the property consists of primarily commercial and residential buildings. The north-adjacent property, across 40th Avenue, consists of a 1-story commercial upholstery studio, and a 3- to 4-story mixed commercial and residential use structure occupied on the ground floor by a restaurant and construction company. The west-adjacent property, across Crescent Street, consists of a 5-story mixed commercial and residential building. The south-adjacent property is currently undeveloped and utilized as a yard for a water tank contracting company. The east-adjacent property consists of a 1-story commercial warehouse. There are two sensitive receptors (such as schools, hospitals and day-care facilities) within a 500-foot radius of the Site. Growing Up Green Charter School is located approximately 250 feet east of the Site. Newcomers High School is located approximately 475 feet south-southeast of the Site.

1.4 SUMMARY OF PAST SITE USES AND AREAS OF CONCERN

Based upon the review of the Phase I Environmental Site Assessment (ESA) Report prepared by Merritt Environmental Consulting in May 2012, a Site history was established. The Site was developed prior to 1898 with multiple 1 and 2-story structures. The uses of the buildings were not listed. The Site was then utilized as a heating equipment warehouse during 1950 and a 1-

story commercial building between 1970 and 2006. Prior to redevelopment, the 1-story commercial building was utilized as commercial offices and storage.

The only AOC identified for the Site during the remedial investigation was urban fill to 8 feet below grade.

1.5 SUMMARY OF WORK PERFORMED UNDER THE REMEDIAL INVESTIGATION

Athenica performed the following scope of work at the Site utilizing a phased approach between June 2012 and February 2014:

1. Conducted a Site inspection to identify AOCs and physical obstructions (i.e. structures, buildings, etc.);
2. Installed seven (7) soil borings across the entire project Site, and collected fourteen (14) soil samples for chemical analysis from the soil borings to evaluate soil quality;
3. Installed three (3) groundwater monitoring wells throughout the Site to establish groundwater flow and collected two (2) groundwater samples for chemical analysis to evaluate groundwater quality (the third well was dry during the groundwater sampling event);
4. Installed four (4) soil vapor probes around Site perimeter and collected four (4) soil vapor samples for chemical analysis;
5. Installed two (2) additional soil borings in the northern portion of the Site after building demolition, and collected four (4) additional soil samples to complete the scope of the remedial investigation; and
6. Installed an additional one (1) groundwater monitoring well on the eastern portion of the Site after building demolition, and collected an additional one (1) groundwater sample to complete the scope of the remedial investigation.

1.6 SUMMARY OF FINDINGS OF REMEDIAL INVESTIGATION

1. Elevation of the property ranges from 65 to 79 feet.
2. Depth to groundwater ranges from 33.90 to 37.55 feet at the Site.

3. Since only two (2) wells could be monitored and sampled during the initial phase of the RI, the actual direction of groundwater flow could not be determined during the RI. The groundwater flow is presumed to be generally towards west, following the topography.
4. Bedrock was not encountered during the RI.
5. The stratigraphy of the Site, from the surface down, consists of 8 feet of urban fill, 4 feet of medium sand with gravel, and 12 to 24 feet of fine grained silty sand.
6. Soil/fill samples collected during the RI were compared to 6 NYCRR Part 375-6.8 Track 1 Unrestricted Soil Cleanup Objectives (SCOs) and Track 2 Restricted Residential Use SCOs. No PCBs were detected, and no SVOCs or Pesticides above Track 1 Unrestricted SCOs were identified in any of the soil samples. Soil sampling results showed no VOCs except for acetone (max. of 0.0682 ppm) above Unrestricted Use SCOs. TCE (max 4.4 ppb) and PCE (max 4.6 ppb) were detected only at trace levels. Four (4) metals, copper (max. of 52.6 ppm), lead (max. of 238 ppm), zinc (max. of 239 ppm) and mercury (max. of 0.69 ppm) were identified above Track 1 Unrestricted SCOs in five of the soil samples. None of these metals exceeded their respective Track 2 Residential SCOs in five shallow soil samples. Overall, the findings were consistent with observations for historic fill sites in areas throughout NYC.
7. Groundwater samples collected during the RI showed no pesticides or PCBs and no SVOCs above Class GA Groundwater Standards (GQS). Three (3) VOCs, 1,1,1-trichloroethane (10 µg/L), 1,1-dichloroethylene (7.9 µg/L), and PCE (20 µg/L) exceeded their respective GQS in one of the groundwater samples. Trace levels of TCE, tert-butylbenzene and chloroform were also detected. No other VOCs were identified above GQS in any of the groundwater samples. Several metals were identified in both groundwater samples, but only four (4) dissolved metals, magnesium, manganese, selenium and sodium were identified above their respective GQS.
8. Soil vapor samples collected during the RI showed low to moderate levels of petroleum-related and chlorinated VOCs. BTEX were detected at a maximum concentration of 131.4 µg/m³. PCE was detected in all four of the soil vapor samples, at a maximum concentration of 220 µg/m³. TCE was detected in two of the soil vapor samples, at a

maximum concentration of 48 $\mu\text{g}/\text{m}^3$. 1,1,1-Trichloroethane (TCA) was detected in all four samples, at maximum concentration of 29 $\mu\text{g}/\text{m}^3$. Carbon tetrachloride was not detected in any of the samples.

9. Soil/fill samples collected during the additional RI were compared to NYSDEC 6NYCRR Part 375-6.8 Unrestricted Use Soil Cleanup Objectives (SCOs) and Restricted Residential Use SCOs. Only two VOCs; acetone and 2-butanone were detected at trace concentration during the additional RI (acetone is a common lab contaminant), but both were detected below their respective Unrestricted Use SCOs. No SVOCs, pesticides or PCBs were detected above their respective method detection limits (MDLs) in any of the soil samples. Several metals were detected in the soil samples above their MDLs, however none were above their respective Unrestricted Use SCOs.
10. Groundwater samples collected during the additional RI were compared to NYSDEC 6NYCRR Part 703.5 Class GA Groundwater Quality Standards (GQS). Several VOCs were detected above their respective MDLs; with three (3) of them exceeding their respective GQS. These VOCs are 1,2,4-trimethylbenzene (90 $\mu\text{g}/\text{L}$), 1,3,5-trimethylbenzene (31 $\mu\text{g}/\text{L}$), and n-propylbenzene (27 $\mu\text{g}/\text{L}$). Several SVOCs were detected above their respective MDLs; with one (1) of them exceeding their respective GQS. This SVOC is naphthalene (46.8 $\mu\text{g}/\text{L}$). Several dissolved metals were detected above their respective MDLs, with three (3) of them exceeding their respective GQS. These dissolved metals are antimony (6 $\mu\text{g}/\text{L}$), manganese (1,610 $\mu\text{g}/\text{L}$), and sodium (80,600 $\mu\text{g}/\text{L}$). One PCB was detected above their respective MDL, but was below its respective GQS.

For more detailed results, consult the RIR and the RIR Addendum. Based on an evaluation of the data and information from the RIR and this RAWP, disposal of significant amounts of hazardous waste was not suspected at this site. Appendix A includes the RIR and RIR Addendum.

2.0 DESCRIPTION OF REMEDIAL ACTIONS

The Remedial Action was performed in accordance with an NYC OER-approved Remedial Action Work Plan and achieved the Remedial Action Objectives established for the project. The Remedial Action was evaluated in an alternatives analysis and was determined to be protective of human health and the environment, compliant with standards, criteria, and guidelines (SCGs), effective in the short-term, effective in the long-term, capable of attaining appropriate levels of reduction of toxicity, mobility, or volume of contaminated material, implementable, cost effective, acceptable to the community, consistent with land uses, and sustainable.

A summary of the milestones achieved in the Remedial Action is as follows: A Pre-Application Meeting was held on October 22, 2013. A Remedial Investigation (RI) was performed from June, 2012 and May, 2016. Appendix 1 contains the RI. A RI Report was prepared to evaluate data and information necessary to develop a Remedial Action Work Plan (RAWP). A Site Contact List was established. A draft RAWP was prepared and released with a Fact Sheet on September 26, 2014 for a 30-day public comment period. The RAWP and Stipulation List dated February 5, 2015 was approved by the New York City Office of Environmental Remediation (NYC OER) on February 26, 2015. Site briefings were conducted with New York State Department of Environmental Conservation (NYSDEC) on October 3, 2014. A Pre-Construction Meeting was held on October 20, 2015. A Fact Sheet providing notice of the start of the remedial action was issued on October 27, 2015. The remedial action was begun on September 23, 2016 and completed in July, 2017. Appendix 2 contains the RAWP and Stipulation List.

The remedial action consisted of the following tasks:

1. Prepared a Community Protection Statement and implemented a Citizen Participation Plan.
2. Mobilized site security and equipment; completed utility mark outs; and marked and staked excavation areas.
3. Additional soil and groundwater investigations were performed to supplement investigation data due to site access issues. Four (4) soil and one (1) groundwater

samples were collected, and results were submitted to the NYC OER on May 26, 2016 through the Addendum to Remedial Investigation Report.

4. Performed Waste Characterization Study prior to excavation activities. Nine (9) waste characterization soil samples were collected on May 5, 2016. Two (2) soil samples were collected on May 20, 2016 to delineate a lead hotspot identified in waste characterization sample WC-3 (0-4'). Ten (10) extractable petroleum hydrocarbons (EPH) soil samples for waste characterization were collected on September 16, 2016. Waste characterization samples were collected at a frequency dictated by disposal facility(s).
5. Performed a Community Air Monitoring Program for particulates and volatile organic carbon compounds.
6. Selected NYSDEC Part 375 Track 1 Unrestricted Use Soil Cleanup Objectives (SCOs).
7. The following excavations were performed: soil was excavated to a depth of 24 to 28 feet below grade surface across the Site and an additional 5-foot excavation was required for the elevator pit. Prior to soil excavation, soil/fill containing hazardous lead was removed from the lead hotspot area identified during waste characterization. A total of approximately 18,204.85 tons of soil/fill was excavated and removed from the property.
8. Excavated 2,629.64 tons of non-hazardous soil/fill and transported it to Kearny Point Industrial Park Site (KPIP), 77 Hackensack Avenue, Kearny, New Jersey; excavated 48.70 tons of hazardous characteristic soil/fill and transported to Clean Earth of North Jersey (CENJ), 115 Jacobus Avenue, Kearny, New Jersey; excavated approximately 9,780 tons of clean soil and transported it to Evergreen Recycling of Corona, Willets Point Boulevard and 35th Avenue, Flushing, New York; excavated 706.51 tons of clean soil and transported to Wards Island Waste Water Treatment Facility, 7 Central Road, New York, New York utilizing the NYC Clean Soil Bank; excavated approximately 1,440 tons of clean soil and transported to 832 Lexington Avenue, Brooklyn, New York utilizing the NYC Clean Soil Bank; and excavated approximately 3,600 tons of clean soil and transported to 1525 Bedford Avenue, Brooklyn, New York utilizing the NYC Clean Soil Bank.
9. Screened excavated soil/fill during intrusive work for indications of contamination by visual means, odor, and monitoring with a PID.

10. Conducted materials management of excavated materials including temporarily stockpiling and segregating in accordance with defined material types and to prevent co-mingling of contaminated material and non-contaminated materials.
11. Appropriately segregated excavated media onsite prior to disposal. Transported and disposed all soil/fill material at permitted facilities in accordance with all applicable laws and regulations for handling, transporting, and disposing, and the RAWP.
12. Collected and analyzed five (5) post-excavation confirmation samples to determine attainment of SCOs. Track 1 Unrestricted Use SCOs were achieved.
13. Removed one (1) 5000-gal fuel oil underground storage tank in compliance with applicable laws and regulations. A FDNY tank removal affidavit and NYSDEC tank registration were obtained and provided in Appendix K.
14. As part of development, constructed an engineered Composite Cover System consisting of 30 inches of reinforced concrete slab, including 2 inches of rigid insulation board, underlain by compacted native soil covering the entire footprint of the Site. The contractor for the Composite Cover System construction was Central Construction Management.
15. As part of development, installed a Vapor Barrier System that consisted of Soprema Colphene BSW H, a 140-mil styrene-butadiene-styrene (SBS)-modified bitumen, self-adhered membrane which is sealed utilizing a heat welding device below the building slab and Soprema Colphene BSW V, a 120-mil barrier behind foundation sidewalls. The contractor for the Vapor Barrier System construction was Central Construction Management.
16. On February 2, 2017, as requested by the NYC OER, Athenica performed a second round of soil vapor sampling in the planned locations of the storage and sprinkler rooms (areas that were not to be utilized as parking garage). These results showed lower PCE and TCE concentrations than were detected in the initial soil vapor samples. As a result, it was concluded that the vapor barrier system to be installed below the foundation would sufficiently mitigate potential vapor intrusion in these areas. Further, the construction of a cellar and sub-cellar ventilated parking garage minimizes the potential risk of exposure to soil vapor. As such, Athenica received NYC OER authorization to

waive the requirements for a sub-slab depressurization system. The NYC OER correspondence waiving the requirements for the SSDS is presented in Appendix L.

17. As part of development, constructed a multi-level sub-grade ventilated parking garage, which will be operated as per NYC Department of Building's codes and requirements.
18. Performed all activities required for the Remedial Action, including permitting requirements and pretreatment requirements, in compliance with applicable laws and regulations.
19. Implemented storm-water pollution prevention measures in compliance with applicable laws and regulations.
20. Submitted daily and monthly reports during construction oversight activities. Daily and monthly reports were submitted from September 23, 2016 to February 26, 2016.
21. Submitted a Sustainability Report.
22. Submitted a Remedial Action Report (RAR) that describes the Remedial Action; certifies that the remedial requirements defined in the RAWP have been achieved; defines the Site boundaries; and lists any changes from the RAWP.

3.0 COMPLIANCE WITH REMEDIAL ACTION WORK PLAN

3.1 CONSTRUCTION HEALTH & SAFETY PLAN

The remedial construction activities performed under this program were in compliance with the Construction Health and Safety Plan and applicable laws and regulations. The Site Safety Coordinator was Joe Soehngen.

3.2 COMMUNITY AIR MONITORING PLAN

The Community Air Monitoring Plan provided for the collection and analysis of air samples during remedial construction activities to ensure proper protections were employed to protect workers and the neighboring community. Monitoring was performed from September 23, 2016 to July 11, 2017 in compliance with the Community Air Monitoring Plan in the approved RAWP. CAMP monitoring was reduced to one downwind station with permission from NYC OER in a correspondence dated December 14, 2016 when the excavation reached a depth of approximately eight feet below grade and native material was encountered. The NYC OER correspondence permitting the reduction of CAMP to one downwind station is presented in Appendix L. No exceedances of action levels indicating a hazard to public health were observed during the performance of CAMP. The results of Community Air Monitoring are shown in Appendix D.

3.3 SOIL/MATERIALS MANAGEMENT PLAN

The Soil/Materials Management Plan provided detailed plans for managing all soil/materials that were disturbed at the Site, including excavation, handling, storage, transport and disposal. It also included a series of controls to assure effective, nuisance-free remedial activity in compliance with applicable laws and regulations. Remedial construction activities performed under this program were in compliance with the SMMP in the approved RAWP.

3.4 STORM-WATER POLLUTION PREVENTION

Storm water pollution prevention included physical methods and processes to control and/or divert surface water flows and to limit the potential for erosion and migration of Site soils, via wind or water. Remedial construction activities performed under this program were in full

compliance with methods and processes defined in the RAWP for storm water prevention and applicable laws and regulations.

3.5 DEVIATIONS FROM THE REMEDIAL ACTION WORK PLAN

- The PE who certified the Remedial Action Work Plan dated July 2014 was Reza Sharif. However Spiro Dongaris, P.E. took over the project prior to construction. He has reviewed all the plans and remedial design. The installation of the vapor barrier and the composite cover were also overseen by Mr. Dongaris. He is the P.E. certifying this Remedial Action Report.
- The QEP who signed the Remedial Action Work Plan dated July 2014 was William Silveri. However the project was then assigned to Ezgi Karayel and later to A.J. Infante. Remedial activities were overseen by Mr. Infante.
- The Remedial Action Work Plan dated July 2014 listed the construction of an engineered composite cover consisting of 8-inch thick concrete building floor slab over the entire footprint of the Site. The composite cover was constructed as 30 inches of reinforced concrete slab, including 2 inches of rigid insulation board, underlain by compacted native soil covering the entirety of the Site. With the residual native soil at the Site meeting Track 1 SCOs, this modification to the concrete slab thickness further minimizes any environmental risk to occupants of the building.
- The proposed vapor barrier system in the Remedial Action Work Plan dated July 2014 was Preprufe® 200 32-mil, manufactured by W.R. Grace & Co. However, prior to the foundation work, the vapor barrier system was modified to Soprema Colphene BSW H, 140-mil styrene-butadiene-styrene (SBS)-modified bitumen, a self-adhered membrane which is sealed utilizing a heat welding device, below the building slab and Soprema Colphene BSW V, a 120-mil vapor barrier, behind foundation walls. The increased thickness of the vapor barrier system design provides further protection to the public health and environment. The updated vapor barrier was documented to the NYC OER in email correspondence dated February 16, 2017, which is provided in Appendix L.
- On February 2, 2017, as requested by the NYC OER, Athenica performed a second round of soil vapor sampling in the planned locations of the storage and sprinkler rooms (areas

that were not to be utilized as parking garage). These results showed lower PCE and TCE concentrations than were detected in the initial soil vapor samples. As a result, it was concluded that the vapor barrier system to be installed below the foundation would sufficiently mitigate potential vapor intrusion in these areas. Further, the construction of a cellar and sub-cellar ventilated parking garage minimizes the potential risk of exposure to soil vapor. As such, Athenica received NYC OER authorization to waive the requirements for a passive sub-slab depressurization system. The NYC OER correspondence waiving the requirements for the SSDS is presented in Appendix L.

No other significant deviations from the Remedial Action Work Plan occurred during implementation of the plan.

4.0 REMEDIAL PROGRAM

4.1 PROJECT ORGANIZATION

Principal personnel who participated in the remedial action include Ezgi Karayel (former Senior Project Manager and QEP), Curtis Breuer (Environmental Scientist/Geologist), Adib Rahman (Environmental Scientist), and Evan Greenberg (Junior Engineer). The Professional Engineer (P.E.) and Qualified Environmental Professionals (QEP) for this project are Spiro Dongaris, P.E. and A.J. Infante, respectively. The developer of this project was Crescent Street Owners, LLC. The principal contractor for this project was Central Construction Management.

For the vapor barrier system installation, Spiro Dongaris, P.E. and A.J. Infante, QEP provided oversight.

4.2 SITE CONTROLS

Site Preparation

Site preparation was completed in accordance with the schedule indicated below:

- The building department issued a building permit for the Site on March 27, 2015;
- Fencing was installed at the Site by October, 2015;
- Erosion and sedimentation controls were established by October, 2015;
- Mobilization was conducted as necessary for each phase of work at the Site. Mobilization included field personnel orientation, equipment mobilization (including securing all sampling equipment needed for field investigation), marking/staking sampling locations and utility mark-outs. Each field team member attended an orientation meeting to become familiar with the general operation of the Site, health and safety requirements, and field procedures. Mobilization at the Site began in September, 2016;
- The presence of utilities and easements on the Site were fully investigated prior to the performance of invasive work such as excavation or drilling under this plan by using, at a minimum, the One-Call System (811). All invasive activities were performed in compliance with applicable laws and regulations to assure safety. Utility companies and other responsible authorities were contacted to locate and mark locations of potential hazards. Proper safety and protective measures pertaining to utilities and easements, and

compliance with all laws and regulations were employed during invasive and other work. The integrity and safety of on-Site and off-Site structures were maintained during all invasive, excavation or other remedial activity performed under the RAWP;

- An OER Project Notice was erected at the project entrance and was in place during all phases of the Remedial Action.

Soil Screening

Excavation activities began on September 23, 2016. All intrusive soil excavation activities were overseen by Athenica. In addition to extensive sampling and chemical testing of soils on the Site, excavated soil was screened continuously using hand-held instruments and by sight to ensure proper material handling and management. No visual or olfactory evidence of a spill were observed during Site excavation activities.

Stockpile Management

The excavation of historic fill/soils was accomplished by directly loading the materials onto trucks for off-site disposal/reuse. Large boulders and recognizable C&D were stockpiled for off-site disposal.

Truck Inspection

All outbound-trucks were inspected and cleaned prior to departing the Site to prevent any off-Site migrations of contamination. Cleaning of the adjacent streets was performed as needed. No truck pad or washing station was necessary during the loading of trucks, as the truck loading areas consisted of concrete-covered portions of the Site. Any minor incidents of soil tracked onto the sidewalk was promptly swept and cleaned to prevent potential off-Site migration of contaminants.

Site Security

Site access was controlled through a gated entrance of the construction fence. The fence was locked with a chain and padlock during non-working hours/days. Video surveillance was also utilized throughout the Site for additional security measures.

Nuisance Controls

There were no complaints of odor at the Site. VOC levels and dust levels at the Site were not detected at concentrations warranting corrective action.

Reporting

Daily reports were prepared and submitted to NYC OER for each day of activities involving soil disturbance and installation of engineering controls as part of new development. Monthly reports were prepared during active construction at the Site and submitted to NYC OER for each month subsequent to the completion of remedial activities. All daily and monthly reports with digital photographs are included in Appendix C. Digital photographs of the Remedial Action are included in Appendix E.

4.3 MATERIALS EXCAVATION AND REMOVAL ACTION

Soil/Fill Excavation and Removal

Soil and historic fill were excavated to a depth of approximately 24 to 28 feet below grade surface (bgs) throughout the Site, with an additional 5-foot of excavation for the elevator pit. Other excavated materials included boulders, construction and demolition debris from former on-Site building floor slab and foundation. A map showing the approximate locations where excavations were performed and approximate thickness of excavated material is shown in Figure 5.

A total of approximately 18,204.85 tons of soil/fill were excavated and removed from the property during the Removal Action. Materials removed from the property under this Removal Action are generally classified as follows: hazardous lead contaminated soil, 48.70 tons; non-hazardous historical fill, 2,629.64 tons; and native soil, approximately 15,526.51 tons. The quantity of native soil removed from the property is 15,526.51 tons. The quantity of native soil recycled using the NYC Clean Soil Bank is approximately 5,746.51 tons. The quantities of native soil received by Evergreen Recycling of Corona, and the CSB sites located at 832 Lexington Avenue and 1525 Bedford Avenue are approximate estimates based on the size of the load, as scale tickets were not provided from the CSB receiving sites, and Evergreen Recycling of Corona does not weigh receiving material upon arrival. The Removal Action was performed

under the oversight of Spiro Dongaris, P.E. and A.J. Infante, QEP.

Demolition Debris Removal

The pre-existing 1-story warehouse was demolished between March 2016 and May 2016 and much of the slab-on-grade was removed prior to the start of remedial action. All construction and demolition debris was appropriately removed from the Site and the remaining debris from the former building consisted of concrete foundation work. During remedial action of the Site, the remaining demolition debris was appropriately segregated and carted from the site for disposal or recycling.

UST Removal

During the demolition of the pre-existing building slab, a 5,000-gallon UST containing number 2 fuel oil was identified on May 9, 2016. The product in the tank was pumped out by a licensed tank contractor, Riteway Tank Maintenance, and cleaned thoroughly prior to excavating the tank on May 10, 2016. The tank was subsequently cut and disposed of properly at Empire Metal Trading LLC located at 1301 Grand Street, Brooklyn, NY 11211. Soil endpoint samples collected from beneath the tank and the sidewalls of the tank pit were analyzed for VOCs and SVOCs, and compared to 6 NYCRR Part 375 Unrestricted Use Soil Cleanup Objectives (SCOs). The analysis exhibited no exceedances of Unrestricted Use SCOs, and confirmed that there has not been a leak or spill. The UST tank closure documentation is provided in Appendix K. The approximate location of UST is shown in Figure 6. The FDNY tank removal affidavit dated October 9, 2018, and the NYSDEC PBS registration and associated tank closure documentation dated May 10, 2016 are provided in Appendix K.

Hotspot/Hazardous Waste Removal

An approximately 15'x15' area was excavated to a depth of 3-feet utilizing an excavator to remove the hazardous lead hotspot identified during waste classification conducted on March 5, 2016. The hazardous lead hotspot consisted of approximately 48.70 tons of soil and historic fill, which was excavated and disposed at Clean Earth of North Jersey (CENJ) on September 23, 2016. Five end point samples were collected on September 23, 2016 from the bottom of the hotspot/hazardous waste area, and were analyzed for total lead and TCLP lead. End point sampling of the excavation confirmed that the lead impacted material had been completely

removed. The laboratory data package for the lead end point samples are presented in Appendix I.

A map showing the approximate location of hotspots removed during this Removal Action is shown in Figure 6.

Historical Fill Removal

Historic fill was identified across the Site to a depth of 8-feet during the waste characterization sampling. The historical fill consisted of soil, brick debris, concrete, ash, glass, and demolition debris from the former structures. Utilizing an excavator, the historic fill was excavated during the Remedial Action until clean native soil was reached.

Native Soil Removal

Clean native soil was encountered below the historical fill/soil, beginning at a depth of approximately 8-feet across the Site. The native soil consisted of clean, fine- to medium-grained sand with minor amounts of gravel and cobbles to 12 feet. Similar material, minus the gravel and cobbles was observed between 12 feet and the final depth of excavation. Native soil was excavated utilizing an excavator to a depth of 24 to 28 feet to enable construction of the cellar and sub-cellar. An additional 5-foot area of native soil was excavated in the center of the Site to enable construction of an elevator pit. Native soil removal activities took place from October 5, 2016 to July 11, 2017.

Soil Cleanup Objectives

The SCOs for this Remedial Action are NYSDEC Part 375 Track 1 Unrestricted Use SCOs for soil.

End Point Sample Results

Track 1 SCOs were achieved for this project.

In compliance with the Remedial Action Work Plan (RAWP) Stipulation List dated February 5, 2015, five post-excavation confirmation samples were collected from the bottom of the final excavation to evaluate the performance of the remedy with respect to attainment of Track 1 Unrestricted Use SCOs. The confirmation samples were analyzed VOCs, SVOCs, metals, PCBs,

and pesticides, at a New York State Department of Health (NYSDOH) Environmental Laboratory Approval Program (ELAP) certified laboratory (York Analytical Laboratories, Inc.) utilizing EPA Method 8260 for VOCs, EPA Method 8270 for SVOCs, EPA Methods 8081/8082 for pesticides/PCBs, and Target Analyte List metals, mercury, chromium hexavalent and trivalent chromium. Field blanks and duplicates for end-point soil samples were not collected.

Confirmation samples were collected utilizing laboratory-provided, pre-cleaned glassware consisting of a Terracore kit and one 8-oz. jar per sample, which were stored in iced coolers until they were picked up by laboratory courier. Confirmation samples EP-1 and EP-2 were collected from Grid-3 on January 20, 2017 at depths of 28 feet bgs. Confirmation samples EP-3 and EP-4 were collected from Grid-2 on February 2, 2017 at depths of 26 feet bgs. Confirmation sample EP-5 was collected from Grid-1 on July 6, 2017 at a depth of 24 feet bgs.

The results of the post-excavation confirmation soil samples were compared to Track 1 Unrestricted Use SCOs. All the sample results achieved their respective Track 1 Unrestricted Use SCOs. A map of post-excavation confirmation sample locations is provided on Figure 4. A tabular summary of post-excavation confirmation sampling results compared to SCOs is included in Table 1. Full laboratory reports are included in Appendix I.

End Point Data Usability Summary

The end-point soil samples were appropriately containerized, labeled, and assigned unique sample identifications numbers along with sampling descriptions, locations, and depths. The soil samples were accompanied by completed Chain-of-Custody documents. Sampling methods, sample preservation requirements, sampling handling times, and decontamination procedures for field equipment conformed to the RAWP and applicable industry standards.

4.4 MATERIALS DISPOSAL

Soils/fill were properly characterized for off-site disposal in accordance with the RAWP and Stipulations List. For characterization of soils/fill for off-site disposal, three test pits were excavated, and representative soil samples were collected from each test pit for laboratory analysis. Waste characterization sampling was conducted on May 5, 2016. A copy of the laboratory analytical report for the waste characterization sampling is included in Appendix H. A brief summary of the classification results are summarized below:

- Results of waste characterization sampling for urban fill/soils and native clean soils were sent to Clean Earth of North Jersey, Inc. (CENJ), Kearny Point Industrial Park (KPIP), and Evergreen Recycling of Corona.
- All pertinent documents were reviewed by the NYC OER and native clean soils from the Site were approved for the Clean Soil Bank program (CSB# 16CCSB069).
- Approval letters from receiving facilities are provided in Appendix F. A table that shows each truck that transported material from the Site, the date, license number, trucking company, tonnage, and receiving facility name is provided in Table 3.
- Each truckload of material exported from the Site had a matching manifest that provides the date, time, license number, trucking company, material type, and responsible signatories. Copies of the manifests are provided in Appendix G.

The type, quantity and disposal location of each material removed and disposed off-Site is presented below:

Disposal Location/Address	Type of Material	Quantity (tons)
Kearny Point Industrial Park Site (KPIP) 77 Hackensack Avenue Kearny, New Jersey	Non-Hazardous Soil	2,629.64
Clean Earth of North Jersey (CENJ) 115 Jacobus Avenue Kearny, New Jersey	Hazardous (Lead) Characteristic Soil	48.70
Evergreen Recycling of Corona Willets Point Boulevard and 35 th Avenue Flushing, New York	Clean Soil	9,780*
Wards Island Waste Water Treatment Facility 7 Central Road New York, New York	Clean Soil in NYC Clean Soil Bank	706.51
832 Lexington Avenue Brooklyn, New York	Clean Soil in NYC Clean Soil Bank	1,440*
1525 Bedford Avenue Brooklyn, New York	Clean Soil in NYC Clean Soil Bank	3,600*

* = Approximate estimate based on the size of the load, as scale tickets were not provided from

the CSB receiving sites, and Evergreen Recycling of Corona does not weigh receiving material upon arrival.

Letters from Crescent Owners LLC to disposal facility providing materials type, source and data, and acceptance letters from the disposal facilities providing approval to accept the materials are attached in Appendix F. Manifests are included in Appendix G. Waste characterization reports are presented in Appendix H. A table of individual truck transport and material disposal quantities is provided in Table 3.

4.5 BACKFILL IMPORT

Backfill was not imported to the site during this Remedial Action or development.

4.6 DEMARCATION

The soils remaining onsite consist of clean native soil meeting Track 1 Unrestricted Use SCOs, therefore a demarcation barrier was not needed.

5.0 ENGINEERING CONTROLS

A Track 1 Remedial Action was achieved and Engineering Controls are not required. However, as part of construction, several protective systems were installed. These are:

- (1) Composite Cover System;
- (2) Vapor Barrier System;

Composite Cover System

As part of development, an engineered Composite cover System has been built at the site. This Composite Cover System is comprised of 30 inches of reinforced concrete slab, including 2 inches of rigid insulation board, underlain by compacted native soil covering the entire footprint of the Site. The contractor for the Composite Cover System construction was Central Construction Management.

Figure 7 shows the as-built design for each cover type used in the Composite Cover System on this Site. Figure 8 shows a map of the location of each Composite Cover System type built at the Site. Photographs of construction of the Composite Cover System are included in Appendix E.

Vapor Barrier System

As part of development, a Vapor Barrier System (VBS) has been built at the Site. This Vapor Barrier System consists of Soprema Colphene BSW H, a 140-mil styrene-butadiene-styrene (SBS)-modified bitumen, self-adhered membrane which is sealed utilizing a heat welding device, below the building slab, and Soprema Colphene BSW V, a 120-mil barrier, behind foundation walls. The VBS was installed vertically behind the foundation walls and horizontally beneath the composite cover system. Perforations around structural supports were sealed using manufacturer approved polyurethane bitumen resin manufactured by Soprema. The entire system was installed according to manufacturer specifications and drawing details. The VBS installation complies with RAWP and manufacturer specifications. The professional engineer for the Vapor Barrier System was Spiro Dongaris. The contractor for the Vapor Barrier System construction was Central Construction Management.

Figure 7 shows the as-built engineering diagram for the Vapor Barrier System used on this Site. Figure 9 shows a map of the location of Vapor Barrier System at the Site. Photographs of

installation of the Vapor Barrier System are included in Appendix E. A copy of manufacturer's specifications for the Vapor Barrier System is included in Appendix J.

6.0 INSTITUTIONAL CONTROLS

A Track 1 Remedial Action was achieved and Engineering Controls and Institutional Controls are not required.

7.0 SITE MANAGEMENT PLAN

A Track 1 Remedial Action was achieved and Site Management is not required.

8.0 SUSTAINABILITY REPORT

This Remedial Action provided for sustainable remediation and redevelopment through a variety of means that are defined in this Sustainability Report.

Reuse of Clean, Recyclable Materials and Conservation of Natural Resources. Reuse of clean, recyclable materials reduces consumption of non-renewable virgin resources and can provide energy savings and greenhouse gas reduction since these materials can be locally-derived.

Conservation of non-renewable resources was achieved by contributing to the NYC Clean Soil Bank program, which reallocates clean native soil to be utilized at other sites in need of soil. An estimate of the tonnage of recycled material reused on this project is 5,746 tons of soil sent from the Site to be reused at three NYC Clean Soil Bank sites.

Conversion to Clean Fuels. Use of clean fuel improves NYC's air quality by reducing harmful emissions. Natural gas is utilized as the principal fuel in the new building.

Recontamination Control. Recontamination after cleanup and redevelopment is completed undermines the value of work performed, may result in a property that is less protective of public health or the environment, and may necessitate additional cleanup work later that could impede future redevelopment. Recontamination can arise from future releases that occur within the property or by influx of contamination from off-Site. A vapor barrier system at the Site functions as a recontamination control by eliminating the risk of future migration of off-Site soil vapor contamination. The area of the Site that utilizes recontamination controls under this plan is 12,500 square feet.

Paperless Voluntary Cleanup Program. Crescent Owners, LLC participated in the NYC OER's paperless Voluntary Cleanup Program. Under this program, submission of electronic documents replaced submission of hard copies for the review of project documents, communications and milestone reports. A best estimate of the mass (pounds) of paper saved under this plan is 20 pounds.

Low-Energy Project Management Program. Crescent Owner, LLC participated in the NYC OER's low-energy project management program. Under this program, whenever possible, meetings were held using remote communication technologies, such as videoconferencing and teleconferencing to reduce energy consumption and traffic congestion associated with personal

transportation. A gross estimate of the number of miles of personal transportation that was conserved in this process is 100 miles.

FIGURES

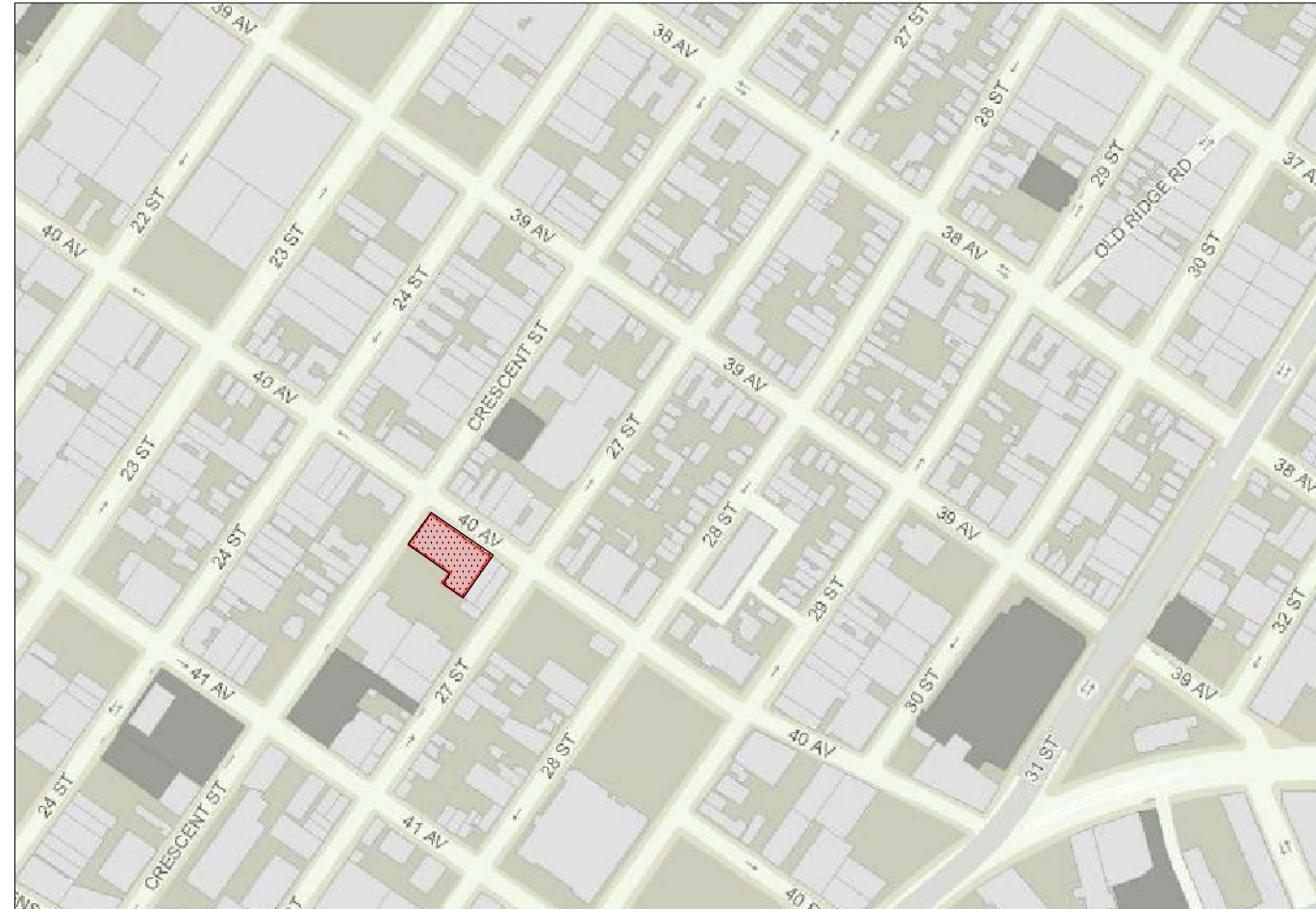
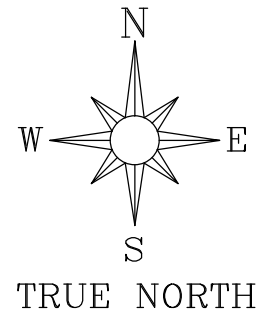

Legend:



PROJECT SITE

Scale:

N.T.S.



**ATHENICA
ENVIRONMENTAL
SERVICES, INC.**
Environmental Consultants

Site map: 40-05 CRESCENT STREET
QUEENS, NY 11101

Figure: 1
Title: SITE LOCATION MAP

Date: NOVEMBER 14, 2016

Drawn by: ANASTASIA KAKOURI

Checked by: CURTIS BREUER

Drawing Scale: N.T.S.

Project No.: 13-1235

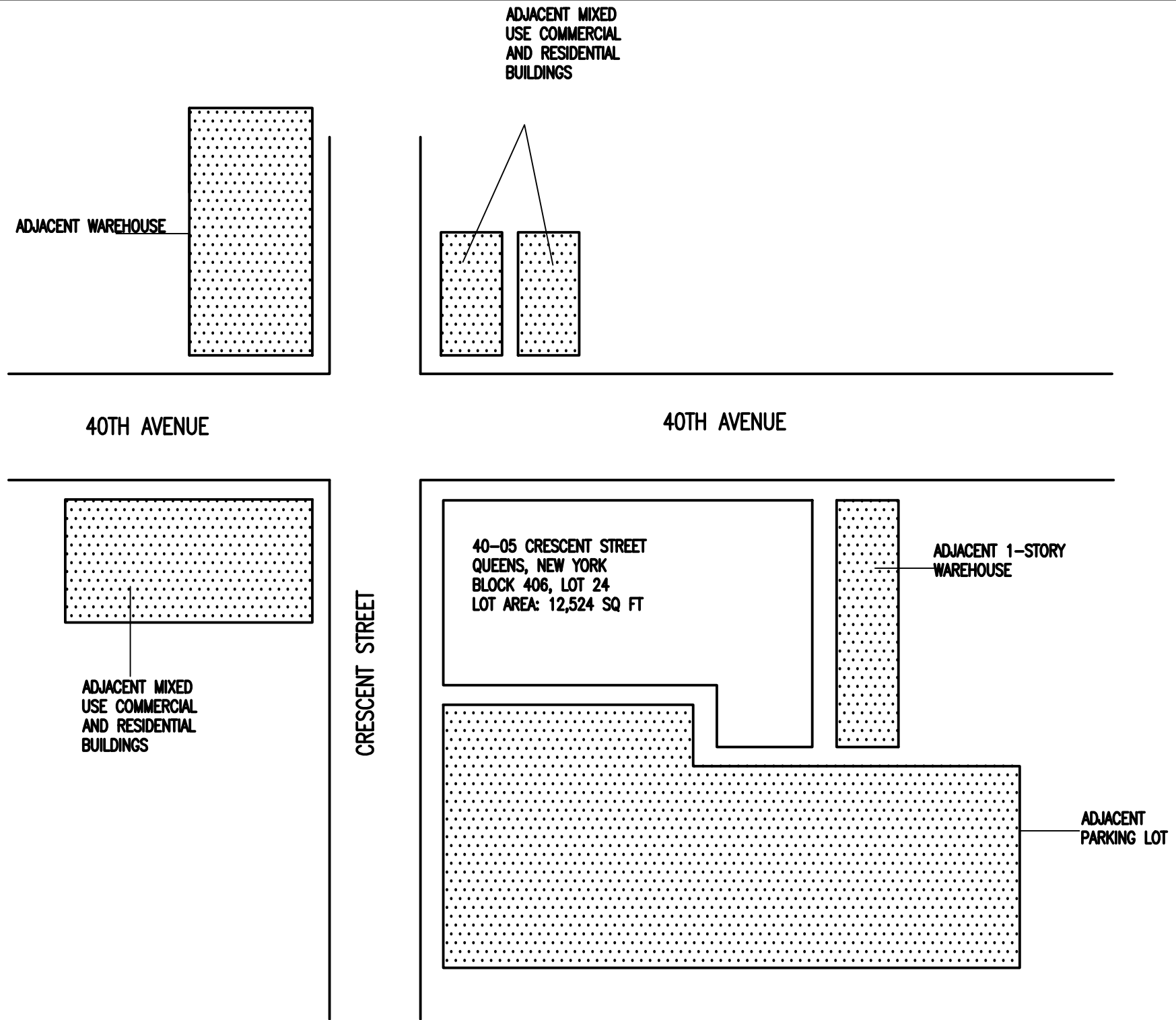
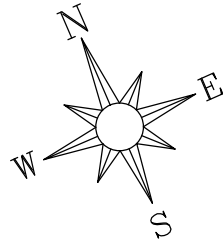

Legend:

----- SITE BUILDING BOUNDARY / PROPERTY BOUNDARY

Scale:

N.T.S.



ATHENICA
ENVIRONMENTAL
SERVICES, INC.
Environmental Consultants

Site map:	RAR 40-05 CRESCENT STREET, QUEENS, NY11101
Figure:	2
Title:	SITE BOUNDARY MAP
Date:	NOVEMBER 14, 2016
Drawn by:	ANASTASIA KAKOURI
Checked by:	CURTIS BREUER
Drawing Scale:	N.T.S.
Project No.:	13-1235

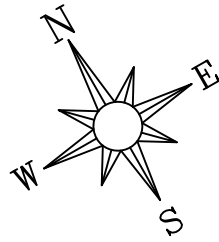

40TH AVENUE

CRESCENT STREET

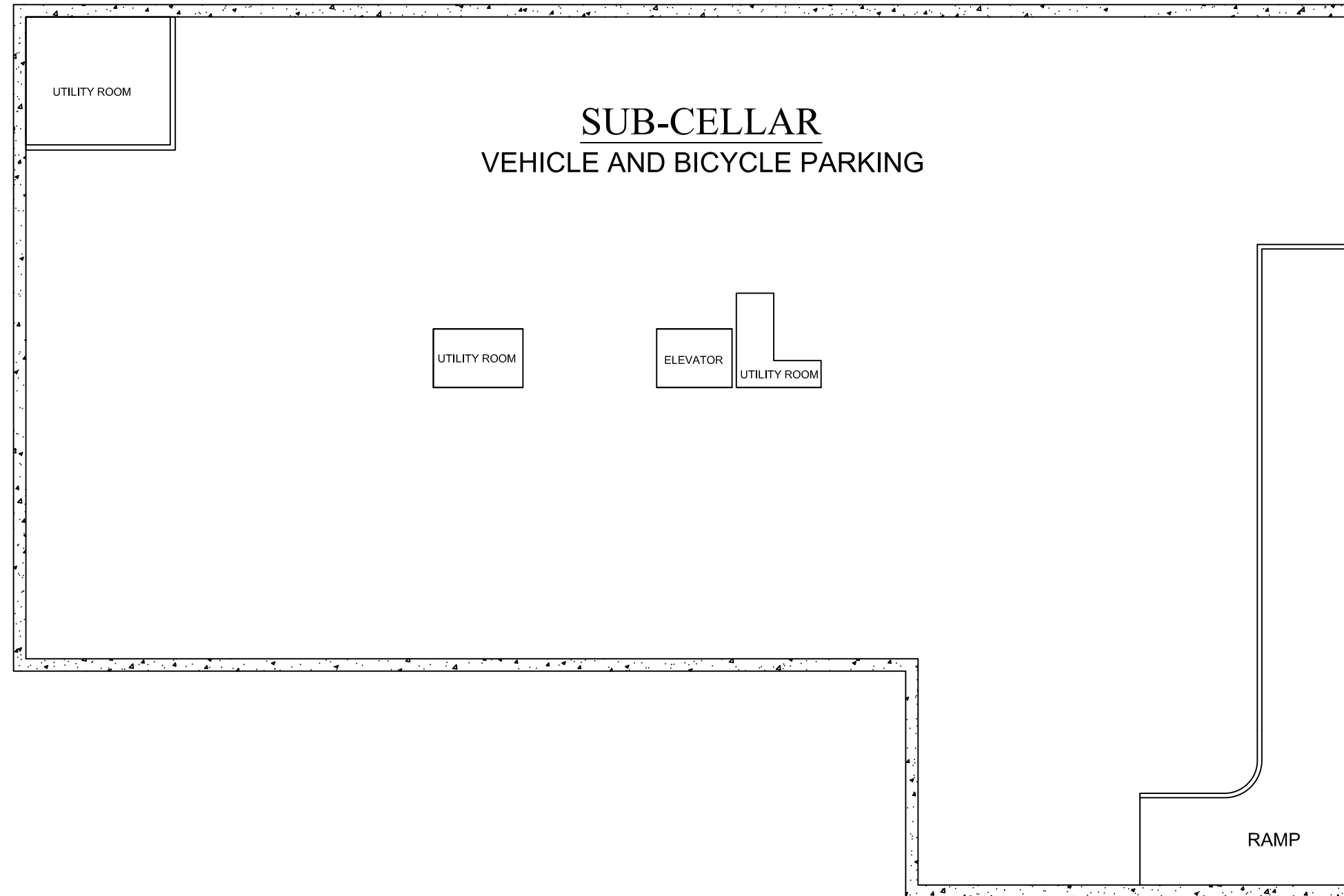

LEGEND:

 -FOUNDATION WALLS



ATHENICA ENVIRONMENTAL SERVICES, INC.
Environmental Engineering Consultants

45-09 GREENPOINT AVENUE
LONG ISLAND CITY, NY 11104
TEL: (718) 784-7490
FAX: (718) 784-4085

Date: APRIL 10, 2018

Drawn by: ADIB RAHMAN

Checked by: A.J. INFANTE

Drawing Scale: NOT TO SCALE

Project No.: 13-1235

Site: 40-05 CRESCENT STREET
QUEENS, NY 11101

Figure: 3A

Title: SITE DEVELOPMENT PLAN
SUB-CELLAR

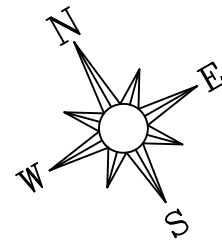

40TH AVENUE

CRESCENT STREET

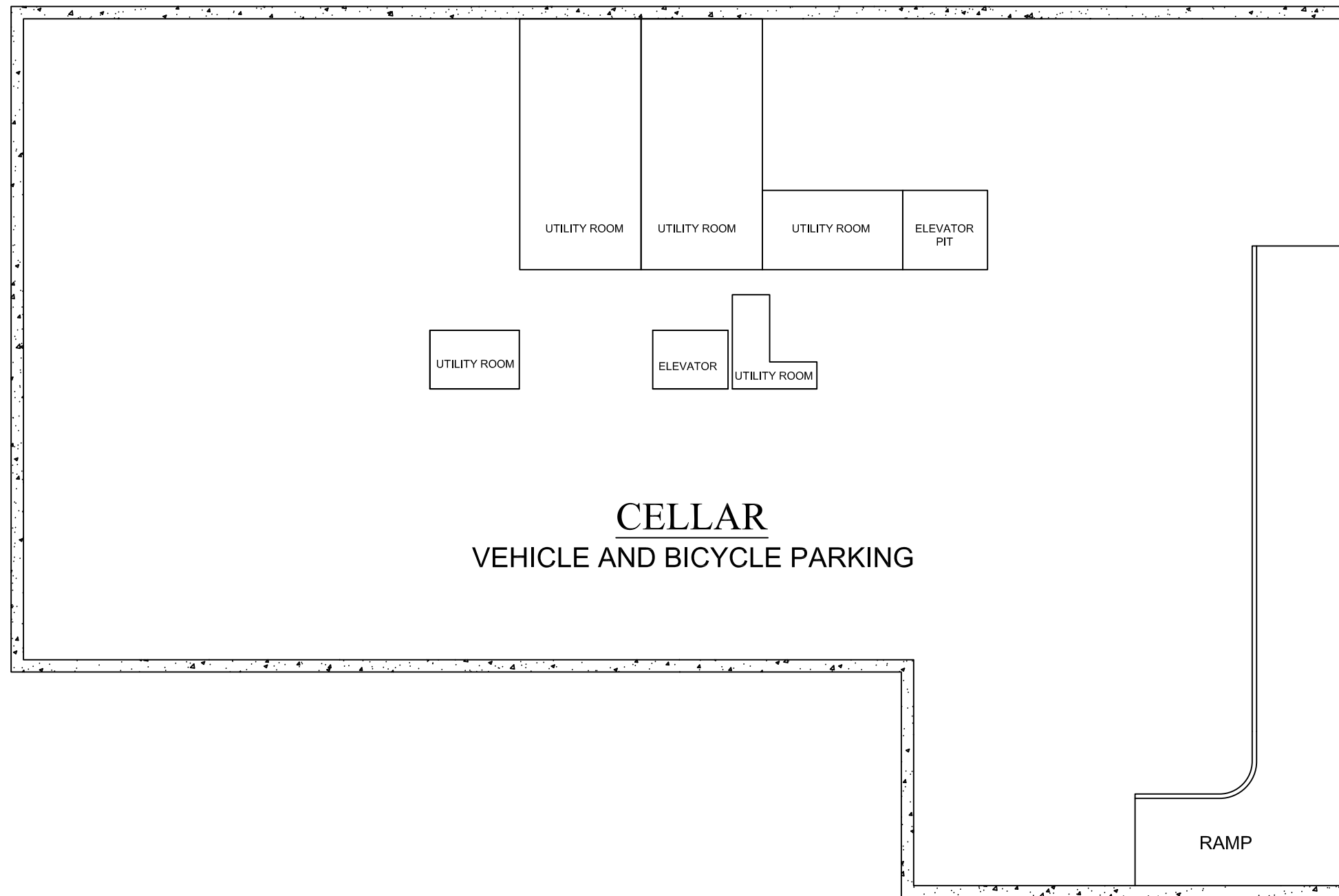

LEGEND:

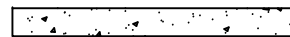

-FOUNDATION WALLS



**ATHENICA ENVIRONMENTAL
SERVICES, INC.**
Environmental Engineering Consultants

45-09 GREENPOINT AVENUE
LONG ISLAND CITY, NY 11104
TEL: (718) 784-7490
FAX: (718) 784-4085

Date: APRIL 10, 2018

Drawn by: ADIB RAHMAN

Checked by: A.J. INFANTE

Drawing Scale: NOT TO SCALE

Project No.: 13-1235

Site: 40-05 CRESCENT STREET
QUEENS, NY 11101

Figure: 3B

Title: SITE DEVELOPMENT PLAN
CELLAR

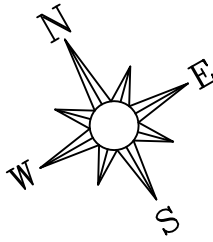

40TH AVENUE

CRESCENT STREET

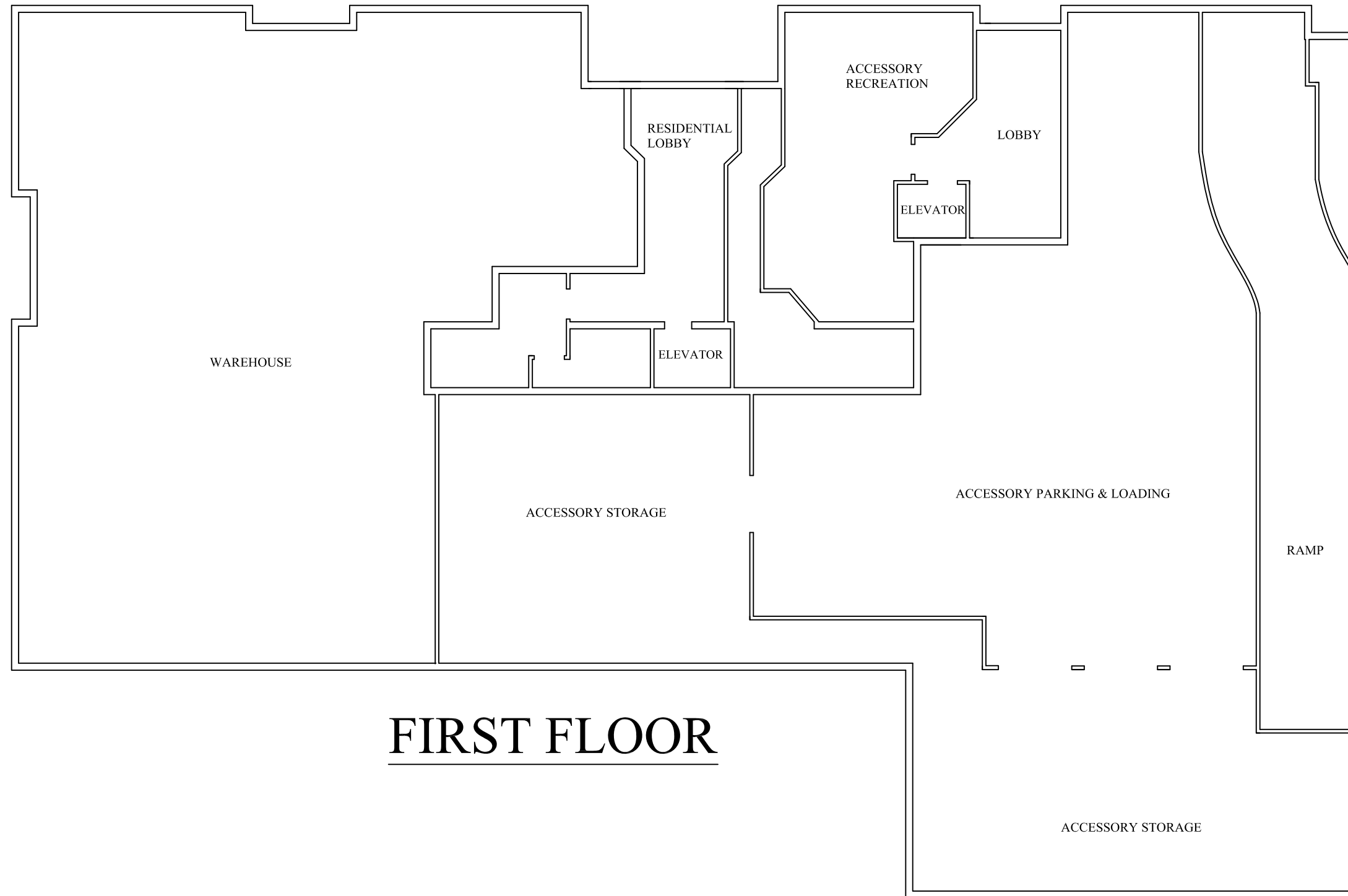

FIRST FLOOR

LEGEND:



ATHENICA ENVIRONMENTAL SERVICES, INC.
Environmental Engineering Consultants

**45-09 GREENPOINT AVENUE
LONG ISLAND CITY, NY 11104
TEL: (718) 784-7490
FAX: (718) 784-4085**

Date:	APRIL 10, 2018	Site:	40-05 CRESCENT STREET QUEENS, NY 11101
Drawn by:	ADIB RAHMAN	Figure:	3C
Checked by:	A.J. INFANTE	Title:	SITE DEVELOPMENT PLAN FIRST FLOOR
Drawing Scale:	NOT TO SCALE		
Project No.:	13-1235		

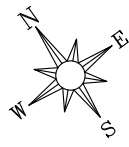

40TH AVENUE

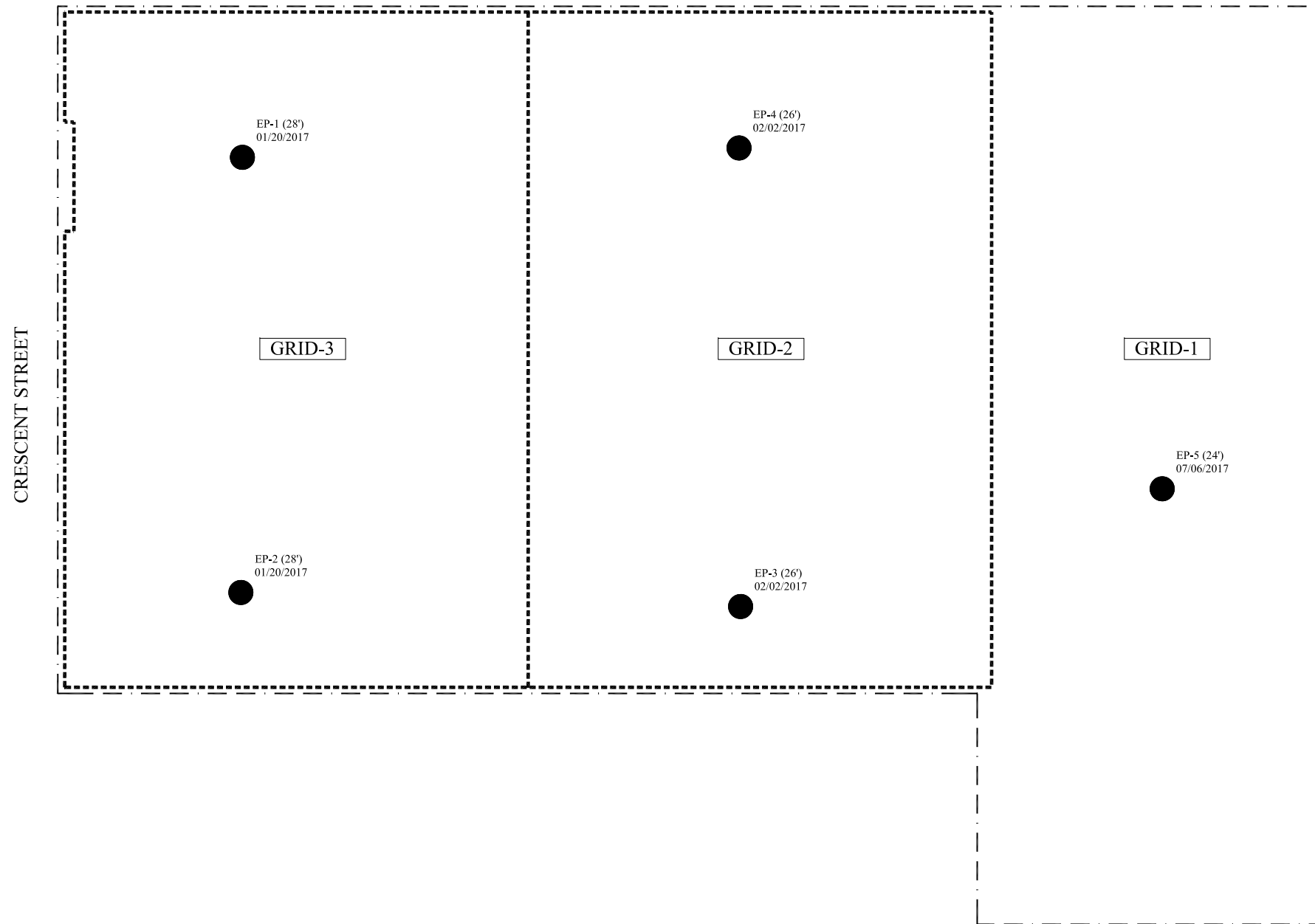

LEGEND:

- - - - - SITE BOUNDARY
- - - - - GRID BOUNDARY
- ENDPOINT SAMPLE LOCATION



45-09 GREENPOINT AVENUE
LONG ISLAND CITY, NY 11104
TEL: (718) 784 - 7490
FAX: (718) 784 - 4085

Date:	JULY 18, 2017
Drawn by:	VOLODYMYR PROTSYUK
Checked by:	ADIB RAHMAN
Drawing Scale:	NOT TO SCALE
Project No.:	13-1235

Site: 40-05 CRESCENT STREET
QUEENS, NY 11101
Figure: 4
Title: ENDPOINT SAMPLE LOCATIONS

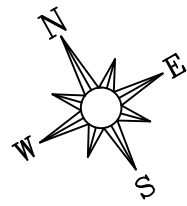

40TH AVENUE

CRESCENT STREET

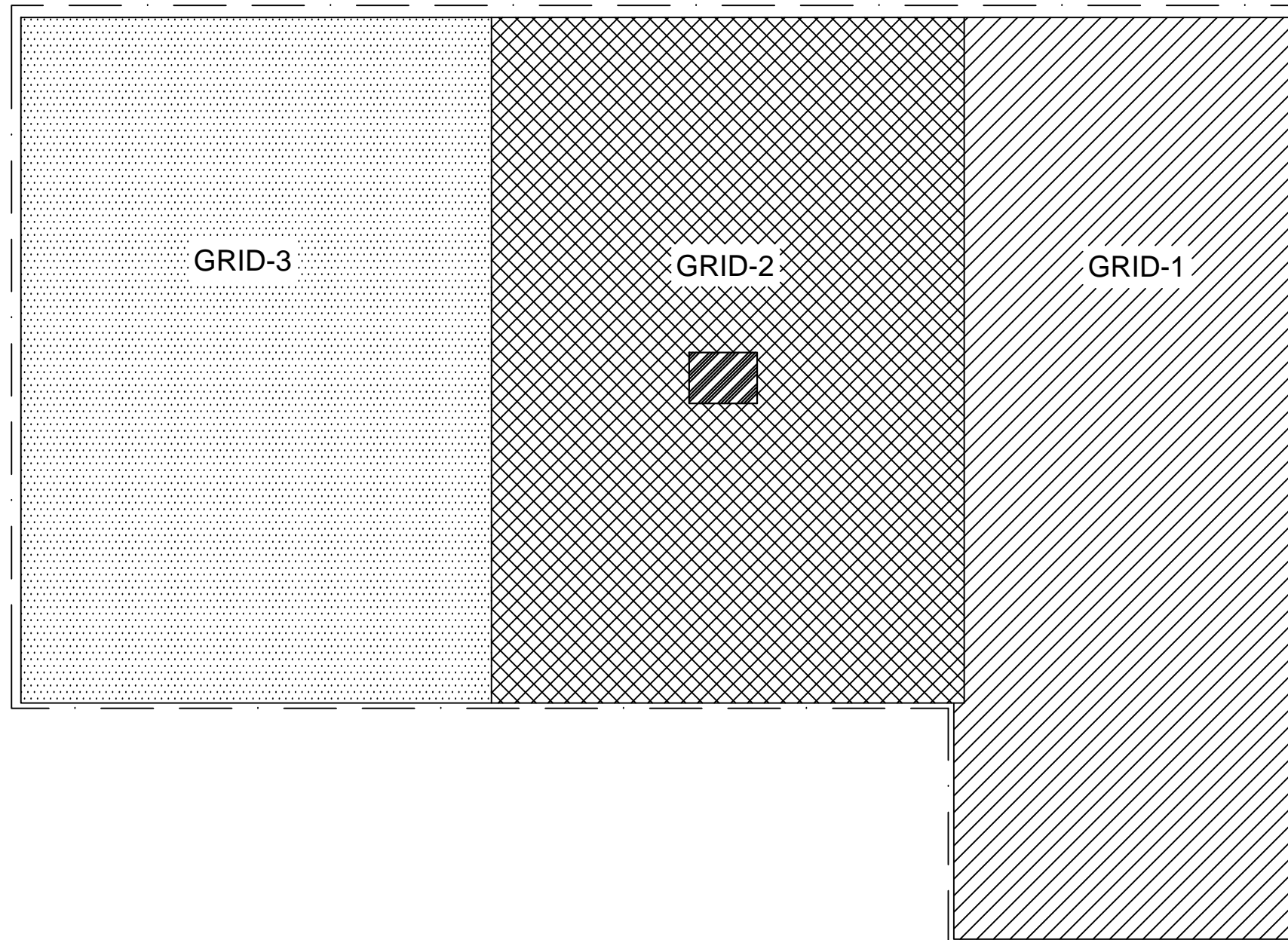

* = THE SITE LIES ON A GRADIENT. EXCAVATION DEPTHS ESTIMATED.

LEGEND:

- — — — — -SITE BOUNDARY
- — — — — -GRID BOUNDARY
- 31' EXCAVATION DEPTH*
- 24' EXCAVATION DEPTH*
- 26' EXCAVATION DEPTH*
- 28' EXCAVATION DEPTH*



ATHENICA ENVIRONMENTAL SERVICES, INC.
Environmental Engineering Consultants

45-09 GREENPOINT AVENUE
 LONG ISLAND CITY, NY 11104
 TEL: (718) 784-7490
 FAX: (718) 784-4085

Date:	MARCH 2, 2018	Site:	40-05 CRESCENT STREET QUEENS, NY 11101
Drawn by:	ADIB RAHMAN	Figure:	5
Checked by:	A.J. INFANTE	Title:	LOCATIONS AND DEPTHS OF EXCAVATION
Drawing Scale:	NOT TO SCALE		
Project No.:	13-1235		



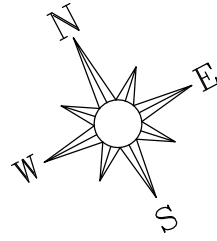

40TH AVENUE

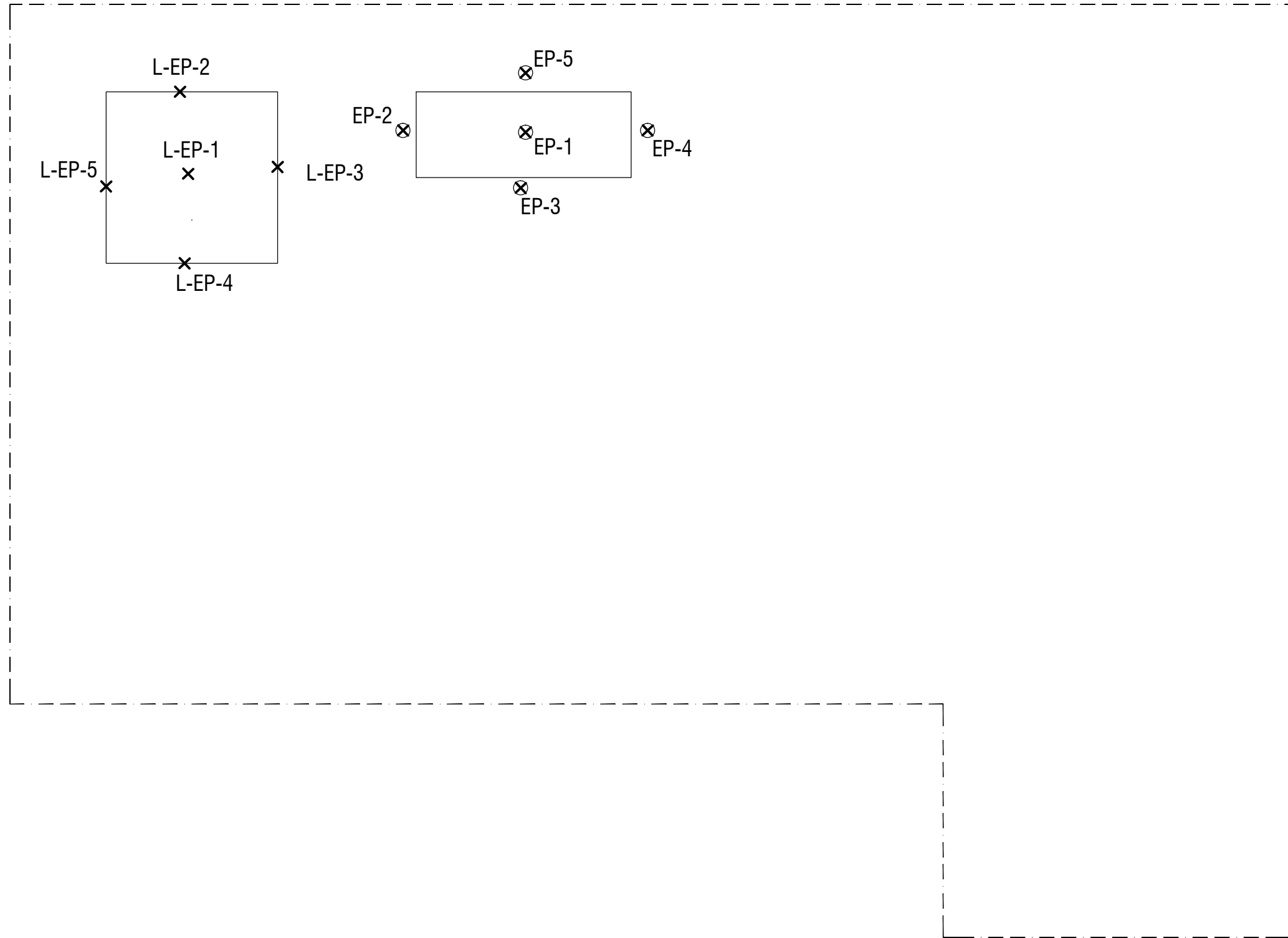

CRESCENT STREET



Legend:

-  L-EP-X Lead End-point Sampling Number and Location
-  Hazardous Lead Area
-  SITE BOUNDARY
-  Tank Excavation Area
-  EP-X Tank End-point Sampling Number and Location

Scale:

N.T.S.



**ATHENICA
ENVIRONMENTAL
SERVICES, INC.**
Environmental Consultants

Site map:	40-05 CRESCENT STREET QUEENS, NY 11101
Figure:	6
Title:	HOTSPOT AND TANK ENDPOINT SAMPLING LOCATIONS
Date:	NOVEMBER 14, 2016
Drawn by:	ANASTASIA KAKOURI
Checked by:	CURTIS BREUER
Drawing Scale:	N.T.S.
Project No.:	13-1235

**AS-BUILT DESIGN DETAIL OF
COMPOSITE COVER AND VAPOR BARRIER SYSTEM
FOR BUILDING SLAB**

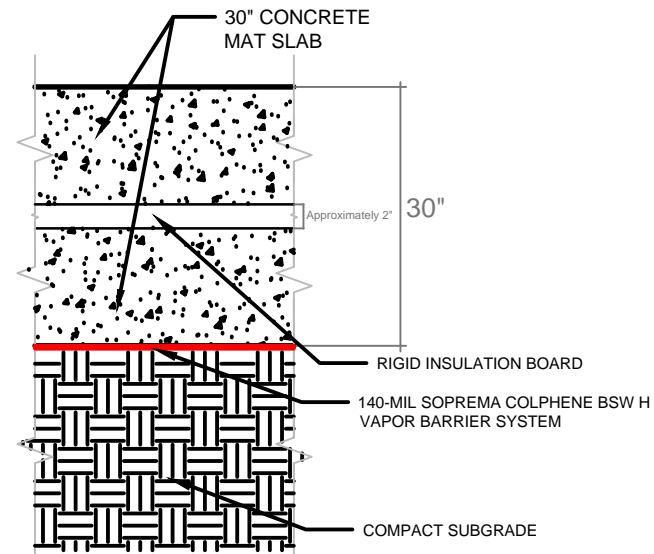

**AS-BUILT DESIGN DETAIL OF
COMPOSITE COVER AND VAPOR BARRIER SYSTEM
FOR ELEVATOR PIT**

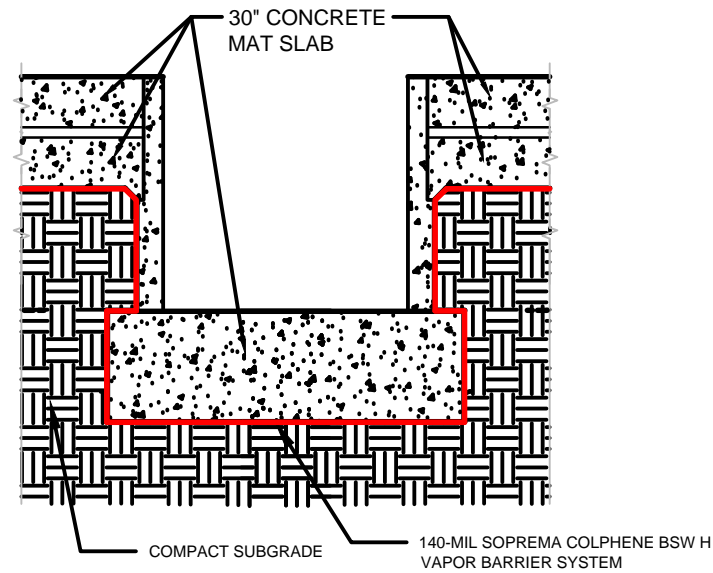

**AS-BUILT DESIGN DETAIL OF
COMPOSITE COVER AND VAPOR BARRIER SYSTEM
FOR SIDE WALL CROSS SECTION**

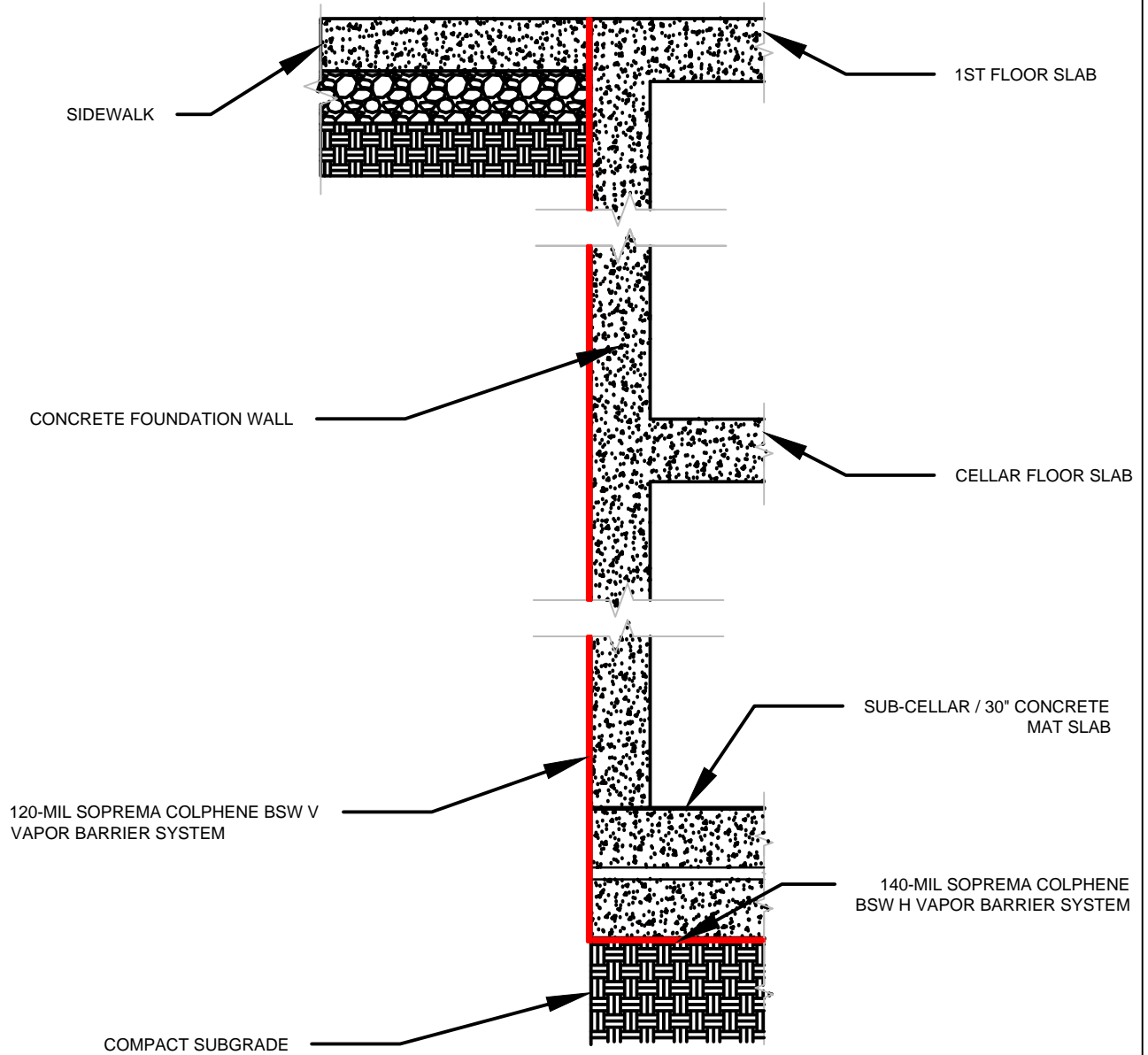

 **ATHENICA ENVIRONMENTAL SERVICES, INC.**
Environmental Engineering Consultants
45-09 GREENPOINT AVENUE
LONG ISLAND CITY, NY 11104
TEL: (718) 784-7490
FAX: (718) 784-4085

Date:	APRIL 9, 2018	Site:	40-05 CRESCENT STREET QUEENS, NY 11101
Drawn by:	ADIB RAHMAN	Figure:	7
Checked by:	A.J. INFANTE	Title:	AS-BUILT DESIGN DETAIL FOR COMPOSITE COVER AND VAPOR BARRIER SYSTEMS
Drawing Scale:	NOT TO SCALE		
Project No.:	13-1235		

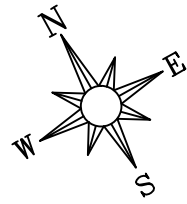



40TH AVENUE

CRESCENT STREET

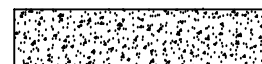

LEGEND:

-  - SITE BOUNDARY
-  - GRID BOUNDARY
-  - LOCATION OF COMPOSITE COVER

 **ATHENICA ENVIRONMENTAL SERVICES, INC.**
Environmental Engineering Consultants
45-09 GREENPOINT AVENUE
LONG ISLAND CITY, NY 11104
TEL: (718) 784-7490
FAX: (718) 784-4085

Date:	MARCH 1, 2018	Site:	40-05 CRESCENT STREET QUEENS, NY 11101
Drawn by:	ADIB RAHMAN	Figure:	8
Checked by:	A.J. INFANTE	Title:	COMPOSITE COVER LOCATION
Drawing Scale:	NOT TO SCALE		
Project No.:	13-1235		

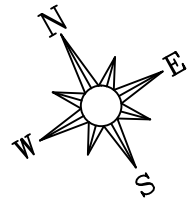

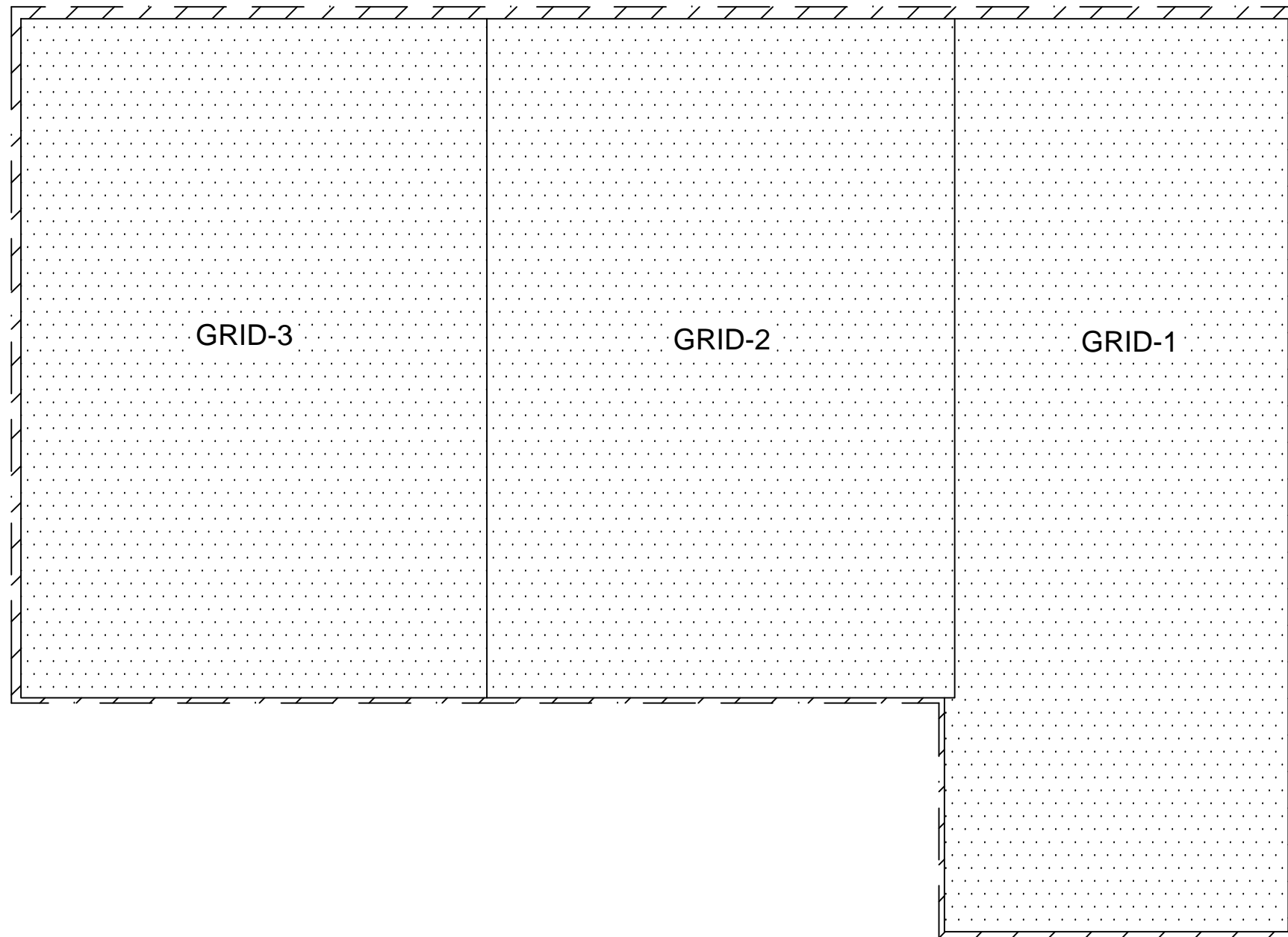

40TH AVENUE

CRESCENT STREET



LEGEND:

- — — — — -SITE BOUNDARY
- — — — — -GRID BOUNDARY
-  -SUB-SLAB VAPOR BARRIER LOCATION
-  -VAPOR BARRIER LOCATION ALONG VERTICAL CELLAR & SUB-CELLAR WALLS

ATHENICA ENVIRONMENTAL SERVICES, INC.
Environmental Engineering Consultants
 45-09 GREENPOINT AVENUE
 LONG ISLAND CITY, NY 11104
 TEL: (718) 784-7490
 FAX: (718) 784-4085

Date:	MARCH 2, 2018	Site:	40-05 CRESCENT STREET QUEENS, NY 11101
Drawn by:	ADIB RAHMAN	Figure:	9
Checked by:	A.J. INFANTE	Title:	VAPOR BARRIER SYSTEM LOCATION
Drawing Scale:	NOT TO SCALE		
Project No.:	13-1235		

TABLES

Table 1
VOCs in End-Point Soil Samples
40-05 Crescent Street, Long Island City, NY 11101

Sample ID Laboratory ID Sampling Depth (ft) Sampling Date Sampling Matrix Dilution Factor Units of Measure	NYSDEC Part 375 Unrestricted Use Soil Cleanup Objectives	EP-1	EP-2	EP-3	EP-4	EP-5					
		17A0775-01	17A0775-02	17B0149-01	17B0149-02	17G0172-01					
		28	28	26	26	24					
		1/20/2017	1/20/2017	2/2/2017	2/2/2017	7/6/2017					
		Soil	Soil	Soil	Soil	Soil					
		1	1	1	1	1					
		mg/Kg	mg/Kg	mg/Kg	mg/kg	mg/kg					
1,1,1,2-Tetrachloroethane	~	0.00270	ND	0.00260	ND	0.00270	ND	0.00250	ND	0.00240	ND
1,1,1-Trichloroethane	0.68	0.00270	ND	0.00260	ND	0.00270	ND	0.00250	ND	0.00240	ND
1,1,2-Tetrachloroethane	~	0.00270	ND	0.00260	ND	0.00270	ND	0.00250	ND	0.00240	ND
1,1,2-Trichloro-1,2,2-trifluoroethane (Freon 113)	~	0.00270	ND	0.00260	ND	0.00270	ND	0.00250	ND	0.00240	ND
1,1,2-Trichloroethane	~	0.00270	ND	0.00260	ND	0.00270	ND	0.00250	ND	0.00240	ND
1,1-Dichloroethane	0.27	0.00270	ND	0.00260	ND	0.00270	ND	0.00250	ND	0.00240	ND
1,1-Dichloroethylene	0.33	0.00270	ND	0.00260	ND	0.00270	ND	0.00250	ND	0.00240	ND
1,2,3-Trichlorobenzene	~	0.00270	ND	0.00260	ND	0.00270	ND	0.00250	ND	0.00240	ND
1,2,3-Trichloropropane	~	0.00270	ND	0.00260	ND	0.00270	ND	0.00250	ND	0.00240	ND
1,2,4-Trichlorobenzene	~	0.00270	ND	0.00260	ND	0.00270	ND	0.00250	ND	0.00240	ND
1,2,4-Trimethylbenzene	3.6	0.00270	ND	0.00260	ND	0.00270	ND	0.00250	ND	0.00240	ND
1,2-Dibromo-3-chloropropane	~	0.00270	ND	0.00260	ND	0.00270	ND	0.00250	ND	0.00240	ND
1,2-Dibromoethane	~	0.00270	ND	0.00260	ND	0.00270	ND	0.00250	ND	0.00240	ND
1,2-Dichlorobenzene	1.1	0.00270	ND	0.00260	ND	0.00270	ND	0.00250	ND	0.00240	ND
1,2-Dichloroethane	0.02	0.00270	ND	0.00260	ND	0.00270	ND	0.00250	ND	0.00240	ND
1,2-Dichloropropane	~	0.00270	ND	0.00260	ND	0.00270	ND	0.00250	ND	0.00240	ND
1,3,5-Trimethylbenzene	8.4	0.00270	ND	0.00260	ND	0.00270	ND	0.00250	ND	0.00240	ND
1,3-Dichlorobenzene	2.4	0.00270	ND	0.00260	ND	0.00270	ND	0.00250	ND	0.00240	ND
1,4-Dichlorobenzene	1.8	0.00270	ND	0.00260	ND	0.00270	ND	0.00250	ND	0.00240	ND
1,4-Dioxane	0.1	0.0540	ND	0.0530	ND	0.0530	ND	0.0500	ND	0.0470	ND
2-Butanone	0.12	0.00270	ND	0.00260	ND	0.00270	ND	0.00250	ND	0.00240	ND
2-Hexanone	~	0.00270	ND	0.00260	ND	0.00270	ND	0.00250	ND	0.00240	ND
4-Methyl-2-pentanone	~	0.00270	ND	0.00260	ND	0.00270	ND	0.00250	ND	0.00240	ND
Acetone	0.05	0.00540	ND	0.00530	ND	0.00530	ND	0.00500	ND	0.0210	ND
Acrolein	~	0.00540	ND	0.00530	ND	0.00530	ND	0.00500	ND	0.00470	ND
Acrylonitrile	~	0.00270	ND	0.00260	ND	0.00270	ND	0.00250	ND	0.00240	ND
Benzene	0.06	0.00270	ND	0.00260	ND	0.00270	ND	0.00250	ND	0.00240	ND
Bromochloromethane	~	0.00270	ND	0.00260	ND	0.00270	ND	0.00250	ND	0.00240	ND
Bromodichloromethane	~	0.00270	ND	0.00260	ND	0.00270	ND	0.00250	ND	0.00240	ND
Bromoform	~	0.00270	ND	0.00260	ND	0.00270	ND	0.00250	ND	0.00240	ND
Bromomethane	~	0.00270	ND	0.00260	ND	0.00270	ND	0.00250	ND	0.00240	ND
Carbon disulfide	~	0.00270	ND	0.00260	ND	0.00270	ND	0.00250	ND	0.00240	ND
Carbon tetrachloride	0.76	0.00270	ND	0.00260	ND	0.00270	ND	0.00250	ND	0.00240	ND
Chlorobenzene	1.1	0.00270	ND	0.00260	ND	0.00270	ND	0.00250	ND	0.00240	ND
Chloroethane	~	0.00270	ND	0.00260	ND	0.00270	ND	0.00250	ND	0.00240	ND
Chloroform	0.37	0.00270	ND	0.00260	ND	0.00270	ND	0.00250	ND	0.00240	ND
Chloromethane	~	0.00270	ND	0.00260	ND	0.00270	ND	0.00250	ND	0.00240	ND
cis-1,2-Dichloroethylene	0.25	0.00270	ND	0.00260	ND	0.00270	ND	0.00250	ND	0.00240	ND
cis-1,3-Dichloropropylene	~	0.00270	ND	0.00260	ND	0.00270	ND	0.00250	ND	0.00240	ND
Cyclohexane	~	0.00270	ND	0.00260	ND	0.00270	ND	0.00250	ND	0.00240	ND
Dibromochloromethane	~	0.00270	ND	0.00260	ND	0.00270	ND	0.00250	ND	0.00240	ND
Dibromomethane	~	0.00270	ND	0.00260	ND	0.00270	ND	0.00250	ND	0.00240	ND
Dichlorodifluoromethane	~	0.00270	ND	0.00260	ND	0.00270	ND	0.00250	ND	0.00240	ND
Ethyl Benzene	1	0.00270	ND	0.00260	ND	0.00270	ND	0.00250	ND	0.00240	ND
Hexachlorobutadiene	~	0.00270	ND	0.00260	ND	0.00270	ND	0.00250	ND	0.00240	ND
Isopropylbenzene	~	0.00270	ND	0.00260	ND	0.00270	ND	0.00250	ND	0.00240	ND
Methyl acetate	~	0.00270	ND	0.00260	ND	0.00270	ND	0.00250	ND	0.00240	ND
Methyl tert-butyl ether (MTBE)	0.93	0.00270	ND	0.00260	ND	0.00270	ND	0.00250	ND	0.00240	ND
Methylcyclohexane	~	0.00270	ND	0.00260	ND	0.00270	ND	0.00250	ND	0.00240	ND
Methylene chloride	0.05	0.00540	ND	0.00530	ND	0.00530	ND	0.00500	ND	0.00470	ND
n-Butylbenzene	12	0.00270	ND	0.00260	ND	0.00270	ND	0.00250	ND	0.00240	ND
n-Propylbenzene	3.9	0.00270	ND	0.00260	ND	0.00270	ND	0.00250	ND	0.00240	ND
o-Xylene	~	0.00270	ND	0.00260	ND	0.00270	ND	0.00250	ND	0.00240	ND
p- & m- Xylenes	~	0.00540	ND	0.00530	ND	0.00530	ND	0.00500	ND	0.00470	ND
p-Isopropyltoluene	~	0.00270	ND	0.00260	ND	0.00270	ND	0.00250	ND	0.00240	ND
sec-Butylbenzene	11	0.00270	ND	0.00260	ND	0.00270	ND	0.00250	ND	0.00240	ND
Styrene	~	0.00270	ND	0.00260	ND	0.00270	ND	0.00250	ND	0.00240	ND
tert-Butyl alcohol (TBA)	~	0.00540	ND	0.00530	ND	0.00530	ND	0.00500	ND	0.00240	ND
tert-Butylbenzene	5.9	0.00270	ND	0.00260	ND	0.00270	ND	0.00250	ND	0.00240	ND
Tetrachloroethylene	1.3	0.00270	ND	0.00260	ND	0.00270	ND	0.00250	ND	0.00240	ND
Toluene	0.7	0.00270	ND	0.00260	ND	0.00270	ND	0.00250	ND	0.00240	ND
trans-1,2-Dichloroethylene	0.19	0.00270	ND	0.00260	ND	0.00270	ND	0.00250	ND	0.00240	ND
trans-1,3-Dichloropropylene	~	0.00270	ND	0.00260	ND	0.00270	ND	0.00250	ND	0.00240	ND
Trichloroethylene	0.47	0.00270	ND	0.00260	ND	0.00270	ND	0.00250	ND	0.00240	ND
Trichlorofluoromethane	~	0.00270	ND	0.00260	ND	0.00270	ND	0.00250	ND	0.00240	ND
Vinyl Chloride	0.02	0.00270	ND	0.00260	ND	0.00270	ND	0.00250	ND	0.00240	ND
Xylenes, Total	0.26	0.00810	ND	0.00790	ND	0.00800	ND	0.00740	ND	0.00710	ND

Q is the Qualifier Column with definitions as follows:

D=result is from an analysis that required a dilution

J=analyte detected at or above the MDL (method detection limit) but below the RL (Reporting Limit) - data is estimated

ND=analyte not detected at or above the level indicated

B=analyte found in the analysis batch blank

E=result is estimated and cannot be accurately reported due to levels encountered or interferences

P=this flag is used for pesticide and PCB (Aroclor) target compounds when there is a % difference for detected concentrations that exceed method dictated limits between the two GC columns used for analysis

NT=this indicates the analyte was not a target for this sample

~this indicates that no regulatory limit has been established for this analyte

Table 1 (Cont'd)
 SVOCs in End-Point Soil Samples
 40-05 Crescent Street, Long Island City, NY 11101

Sample ID Laboratory ID Sampling Depth (ft) Sampling Date Sampling Matrix Dilution Factor Units of Measure	NYSDEC Part 375 Unrestricted Use Soil Cleanup Objectives	EP-1 17A0775-01 28 1/20/2017 Soil 2		EP-2 17A0775-02 28 1/20/2017 Soil 2		EP-3 17B0149-01 26 2/2/2017 Soil 2		EP-4 17B0149-02 26 2/2/2017 Soil 2		EP-5 17G0172-01 24 7/6/2017 Soil 2	
		mg/Kg	ND	mg/Kg	ND	mg/Kg	ND	mg/kg	ND	mg/kg	ND
1,1'-Biphenyl	~	0.0458	ND	0.0424	ND	0.0429	ND	0.0502	ND	0.0448	ND
1,2,4,5-Tetrachlorobenzene	~	0.0913	ND	0.0845	ND	0.0856	ND	0.100	ND	0.0894	ND
1,2,4-Trichlorobenzene	~	0.0458	ND	0.0424	ND	0.0429	ND	0.0502	ND	0.0448	ND
1,2-Dichlorobenzene	1.1	0.0458	ND	0.0424	ND	0.0429	ND	0.0502	ND	0.0448	ND
1,2-Diphenylhydrazine (as Azobenzene)	~	0.0458	ND	0.0424	ND	0.0429	ND	0.0502	ND	0.0448	ND
1,3-Dichlorobenzene	2.4	0.0458	ND	0.0424	ND	0.0429	ND	0.0502	ND	0.0448	ND
1,4-Dichlorobenzene	1.8	0.0458	ND	0.0424	ND	0.0429	ND	0.0502	ND	0.0448	ND
2,3,4,6-Tetrachlorophenol	~	0.0913	ND	0.0845	ND	0.0856	ND	0.100	ND	0.0894	ND
2,4,5-Trichlorophenol	~	0.0458	ND	0.0424	ND	0.0429	ND	0.0502	ND	0.0448	ND
2,4,6-Trichlorophenol	~	0.0458	ND	0.0424	ND	0.0429	ND	0.0502	ND	0.0448	ND
2,4-Dichlorophenol	~	0.0458	ND	0.0424	ND	0.0429	ND	0.0502	ND	0.0448	ND
2,4-Dimethylphenol	~	0.0458	ND	0.0424	ND	0.0429	ND	0.0502	ND	0.0448	ND
2,4-Dinitrophenol	~	0.0913	ND	0.0845	ND	0.0856	ND	0.100	ND	0.0894	ND
2,4-Dinitrotoluene	~	0.0458	ND	0.0424	ND	0.0429	ND	0.0502	ND	0.0448	ND
2,6-Dinitrotoluene	~	0.0458	ND	0.0424	ND	0.0429	ND	0.0502	ND	0.0448	ND
2-Chloronaphthalene	~	0.0458	ND	0.0424	ND	0.0429	ND	0.0502	ND	0.0448	ND
2-Chlorophenol	~	0.0458	ND	0.0424	ND	0.0429	ND	0.0502	ND	0.0448	ND
2-Methylnaphthalene	~	0.0458	ND	0.0424	ND	0.0429	ND	0.0502	ND	0.0448	ND
2-Methylphenol	0.33	0.0458	ND	0.0424	ND	0.0429	ND	0.0502	ND	0.0448	ND
2-Nitroaniline	~	0.0913	ND	0.0845	ND	0.0856	ND	0.100	ND	0.0894	ND
2-Nitrophenol	~	0.0458	ND	0.0424	ND	0.0429	ND	0.0502	ND	0.0448	ND
3- & 4-Methylphenols	~	0.0458	ND	0.0424	ND	0.0429	ND	0.0502	ND	0.0448	ND
3,3'-Dichlorobenzidine	~	0.0458	ND	0.0424	ND	0.0429	ND	0.0502	ND	0.0448	ND
3-Nitroaniline	~	0.0913	ND	0.0845	ND	0.0856	ND	0.100	ND	0.0894	ND
4,6-Dinitro-2-methylphenol	~	0.0913	ND	0.0845	ND	0.0856	ND	0.100	ND	0.0894	ND
4-Bromophenyl phenyl ether	~	0.0458	ND	0.0424	ND	0.0429	ND	0.0502	ND	0.0448	ND
4-Chloro-3-methylphenol	~	0.0458	ND	0.0424	ND	0.0429	ND	0.0502	ND	0.0448	ND
4-Chloroaniline	~	0.0458	ND	0.0424	ND	0.0429	ND	0.0502	ND	0.0448	ND
4-Chlorophenyl phenyl ether	~	0.0458	ND	0.0424	ND	0.0429	ND	0.0502	ND	0.0448	ND
4-Nitroaniline	~	0.0913	ND	0.0845	ND	0.0856	ND	0.100	ND	0.0894	ND
4-Nitrophenol	~	0.0913	ND	0.0845	ND	0.0856	ND	0.100	ND	0.0894	ND
Acenaphthene	20	0.0458	ND	0.0424	ND	0.0429	ND	0.0502	ND	0.0448	ND
Acenaphthylene	100	0.0458	ND	0.0424	ND	0.0429	ND	0.0502	ND	0.0448	ND
Acetophenone	~	0.0458	ND	0.0424	ND	0.0429	ND	0.0502	ND	0.0448	ND
Aniline	~	0.183	ND	0.169	ND	0.171	ND	0.200	ND	0.179	ND
Anthracene	100	0.0458	ND	0.0424	ND	0.0429	ND	0.0502	ND	0.0448	ND
Atrazine	~	0.0458	ND	0.0424	ND	0.0429	ND	0.0502	ND	0.0448	ND
Benzaldehyde	~	0.0458	ND	0.0424	ND	0.0429	ND	0.0502	ND	0.0448	ND
Benzidine	~	0.183	ND	0.169	ND	0.171	ND	0.200	ND	0.179	ND
Benzo(a)anthracene	1	0.0458	ND	0.0424	ND	0.0429	ND	0.0502	ND	0.0448	ND
Benzo(a)pyrene	1	0.0458	ND	0.0424	ND	0.0429	ND	0.0502	ND	0.0448	ND
Benzo(b)fluoranthene	1	0.0458	ND	0.0424	ND	0.0429	ND	0.0502	ND	0.0448	ND
Benzo(g,h,i)perylene	100	0.0458	ND	0.0424	ND	0.0429	ND	0.0502	ND	0.0448	ND
Benzo(k)fluoranthene	0.8	0.0458	ND	0.0424	ND	0.0429	ND	0.0502	ND	0.0448	ND
Benzoic acid	~	0.0458	ND	0.0424	ND	0.0429	ND	0.0502	ND	0.0448	ND
Benzyl alcohol	~	0.0458	ND	0.0424	ND	0.0429	ND	0.0502	ND	0.0448	ND
Benzyl butyl phthalate	~	0.0458	ND	0.0424	ND	0.0429	ND	0.0502	ND	0.0448	ND
Bis(2-chloroethoxy)methane	~	0.0458	ND	0.0424	ND	0.0429	ND	0.0502	ND	0.0448	ND
Bis(2-chloroethyl)ether	~	0.0458	ND	0.0424	ND	0.0429	ND	0.0502	ND	0.0448	ND
Bis(2-chloroisopropyl)ether	~	0.0458	ND	0.0424	ND	0.0429	ND	0.0502	ND	0.0448	ND
Bis(2-ethylhexyl)phthalate	~	0.0458	ND	0.0424	ND	0.0429	ND	0.0502	ND	0.0448	ND
Caprolactam	~	0.0913	ND	0.0845	ND	0.0856	ND	0.100	ND	0.0894	ND
Carbazole	~	0.0458	ND	0.0424	ND	0.0429	ND	0.0502	ND	0.0448	ND
Chrysene	1	0.0458	ND	0.0424	ND	0.0429	ND	0.0502	ND	0.0448	ND
Dibenzo(a,h)anthracene	0.33	0.0458	ND	0.0424	ND	0.0429	ND	0.0502	ND	0.0448	ND
Dibenzofuran	7	0.0458	ND	0.0424	ND	0.0429	ND	0.0502	ND	0.0448	ND
Diethyl phthalate	~	0.0458	ND	0.0424	ND	0.0429	ND	0.0502	ND	0.0448	ND
Dimethyl phthalate	~	0.0458	ND	0.0424	ND	0.0429	ND	0.0502	ND	0.0448	ND
Di-n-butyl phthalate	~	0.0458	ND	0.0424	ND	0.0429	ND	0.0502	ND	0.0448	ND
Di-n-octyl phthalate	~	0.0458	ND	0.0424	ND	0.0429	ND	0.0502	ND	0.0448	ND
Fluoranthene	100	0.0458	ND	0.0424	ND	0.0429	ND	0.0502	ND	0.0448	ND
Fluorene	30	0.0458	ND	0.0424	ND	0.0429	ND	0.0502	ND	0.0448	ND
Hexachlorobenzene	0.33	0.0458	ND	0.0424	ND	0.0429	ND	0.0502	ND	0.0448	ND
Hexachlorobutadiene	~	0.0458	ND	0.0424	ND	0.0429	ND	0.0502	ND	0.0448	ND
Hexachlorocyclopentadiene	~	0.0458	ND	0.0424	ND	0.0429	ND	0.0502	ND	0.0448	ND
Hexachloroethane	~	0.0458	ND	0.0424	ND	0.0429	ND	0.0502	ND	0.0448	ND
Indeno(1,2,3-cd)pyrene	0.5	0.0458	ND	0.0424	ND	0.0429	ND	0.0502	ND	0.0448	ND
Isophorone	~	0.0458	ND	0.0424	ND	0.0429	ND	0.0502	ND	0.0448	ND
Naphthalene	12	0.0458	ND	0.0424	ND	0.0429	ND	0.0502	ND	0.0448	ND
Nitrobenzene	~	0.0458	ND	0.0424	ND	0.0429	ND	0.0502	ND	0.0448	ND
N-Nitrosodimethylamine	~	0.0458	ND	0.0424	ND	0.0429	ND	0.0502	ND	0.0448	ND
N-nitroso-di-n-propylamine	~	0.0458	ND	0.0424	ND	0.0429	ND	0.0502	ND	0.0448	ND
N-Nitrosodiphenylamine	~	0.0458	ND	0.0424	ND	0.0429	ND	0.0502	ND	0.0448	ND
Pentachlorophenol	0.8	0.0458	ND	0.0424	ND	0.0429	ND	0.0502	ND	0.0448	ND
Phenanthrene	100	0.0458	ND	0.0424	ND	0.0429	ND	0.0502	ND	0.0448	ND
Phenol	0.33	0.0458	ND	0.0424	ND	0.0429	ND	0.0502	ND	0.0448	ND
Pyrene	100	0.0458	ND	0.0424	ND	0.0429	ND	0.0502	ND	0.0448	ND

Q is the Qualifier Column with definitions as follows:

D=result is from an analysis that required a dilution

J=analyte detected at or above the MDL (method detection limit) but below the RL (Reporting Limit) - data is estimated

ND=analyte not detected at or above the level indicated

B=analyte found in the analysis batch blank

E=result is estimated and cannot be accurately reported due to levels encountered or interferences

P=this flag is used for pesticide and PCB (Aroclor) target compounds when there is a % difference for detected concentrations that exceed method dictated limits between the two GC columns used for analysis

NT=this indicates the analyte was not a target for this sample

~=this indicates that no regulatory limit has been established for this analyte

Table 1 (Cont'd)
Pesticides PCBs in End-Point Soil Samples
40-05 Crescent Street, Long Island City, NY 11101

Sample ID Laboratory ID Sampling Depth (ft) Sampling Date Sampling Matrix Dilution Factor Units of Measure	NYSDEC Part 375 Unrestricted Use Soil Cleanup Objectives	EP-1 17A0775-01 28 1/20/2017 Soil 5 mg/Kg		EP-2 17A0775-02 28 1/20/2017 Soil 5 mgKg		EP-3 17B0149-01 26 2/2/2017 Soil 5 mg/Kg		EP-4 17B0149-02 26 2/2/2017 Soil 5 mg/kg		EP-5 17G0172-01 24 7/6/2017 Soil 5 mg/kg	
4,4'-DDD	0.0033	0.00181	ND	0.00167	U	0.00169	ND	0.00198	ND	0.00178	ND
4,4'-DDE	0.0033	0.00181	ND	0.00167	U	0.00169	ND	0.00198	ND	0.00178	ND
4,4'-DDT	0.0033	0.00181	ND	0.00167	U	0.00169	ND	0.00198	ND	0.00178	ND
Aldrin	0.005	0.00181	ND	0.00167	U	0.00169	ND	0.00198	ND	0.00178	ND
alpha-BHC	0.02	0.00181	ND	0.00167	U	0.00169	ND	0.00198	ND	0.00178	ND
alpha-Chlordane	0.094	0.00181	ND	0.00167	U	0.00169	ND	0.00198	ND	0.00178	ND
beta-BHC	0.036	0.00181	ND	0.00167	U	0.00169	ND	0.00198	ND	0.00178	ND
Chlordane, total	~	0.0361	ND	0.0334	U	0.0339	ND	0.0396	ND	0.0355	ND
delta-BHC	0.04	0.00181	ND	0.00167	U	0.00169	ND	0.00198	ND	0.00178	ND
Dieldrin	0.005	0.00181	ND	0.00167	U	0.00169	ND	0.00198	ND	0.00178	ND
Endosulfan I	2.4	0.00181	ND	0.00167	U	0.00169	ND	0.00198	ND	0.00178	ND
Endosulfan II	2.4	0.00181	ND	0.00167	U	0.00169	ND	0.00198	ND	0.00178	ND
Endosulfan sulfate	2.4	0.00181	ND	0.00167	U	0.00169	ND	0.00198	ND	0.00178	ND
Endrin	0.014	0.00181	ND	0.00167	U	0.00169	ND	0.00198	ND	0.00178	ND
Endrin aldehyde	~	0.00181	ND	0.00167	U	0.00169	ND	0.00198	ND	0.00178	ND
Endrin ketone	~	0.00181	ND	0.00167	U	0.00169	ND	0.00198	ND	0.00178	ND
gamma-BHC (Lindane)	0.1	0.00181	ND	0.00167	U	0.00169	ND	0.00198	ND	0.00178	ND
gamma-Chlordane	~	0.00181	ND	0.00167	U	0.00169	ND	0.00198	ND	0.00178	ND
Heptachlor	0.042	0.00181	ND	0.00167	U	0.00169	ND	0.00198	ND	0.00178	ND
Heptachlor epoxide	~	0.00181	ND	0.00167	U	0.00169	ND	0.00198	ND	0.00178	ND
Methoxychlor	~	0.00904	ND	0.00836	U	0.00847	ND	0.00990	ND	0.00888	ND
Toxaphene	~	0.0914	ND	0.0846	U	0.0857	ND	0.100	ND	0.0898	ND
Dilution Factor		1		1		1		1		1	
Aroclor 1016	~	0.0182	ND	0.0169	ND	0.0171	ND	0.0200	ND	0.0179	ND
Aroclor 1221	~	0.0182	ND	0.0169	ND	0.0171	ND	0.0200	ND	0.0179	ND
Aroclor 1232	~	0.0182	ND	0.0169	ND	0.0171	ND	0.0200	ND	0.0179	ND
Aroclor 1242	~	0.0182	ND	0.0169	ND	0.0171	ND	0.0200	ND	0.0179	ND
Aroclor 1248	~	0.0182	ND	0.0169	ND	0.0171	ND	0.0200	ND	0.0179	ND
Aroclor 1254	~	0.0182	ND	0.0169	ND	0.0171	ND	0.0200	ND	0.0179	ND
Aroclor 1260	~	0.0182	ND	0.0169	ND	0.0171	ND	0.0200	ND	0.0179	ND
Total PCBs	0.1	0.0182	ND	0.0169	ND	0.0171	ND	0.0200	ND	0.0179	ND

Q is the Qualifier Column with definitions as follows:

- D=result is from an analysis that required a dilution
- J=analyte detected at or above the MDL (method detection limit) but below the RL (Reporting Limit) - data is estimated
- ND=analyte not detected at or above the level indicated
- B=analyte found in the analysis batch blank
- E=result is estimated and cannot be accurately reported due to levels encountered or interferences
- P=this flag is used for pesticide and PCB (Aroclor) target compounds when there is a % difference for detected concentrations that exceed method dictated limits between the two GC columns used for analysis
- NT=this indicates the analyte was not a target for this sample
- ~=this indicates that no regulatory limit has been established for this analyte

Table 1 (Cont'd)
TAL Metals in End-Point Soil Samples
40-05 Crescent Street, Long Island City, NY 11101

Sample ID		EP-1		EP-2		EP-3		EP-4		EP-5	
Laboratory ID		17A0775-01		17A0775-02		17B0149-01		17B0149-02		17G0172-01	
Sampling Depth (ft)		28		28		26		26		24	
Sampling Date		1/20/2017		1/20/2017		2/2/2017		2/2/2017		7/6/2017	
Sampling Matrix		Soil		Soil		Soil		Soil		Soil	
Dilution Factor		1		1		1		1		1	
Units of Measure		mg/Kg		mgKg		mg/Kg		mg/kg		mg/kg	
Aluminum	~	2,160	B	1,430	B	1,520		9,560		3,820	
Antimony	~	0.548	ND	0.507	ND	0.513	ND	0.600	ND	0.538	ND
Arsenic	13	1.100	ND	1.010	ND	1.030	ND	1.200	ND	1.200	
Barium	350	29,400		12,800		12		81,400		24,900	
Beryllium	7.2	0.110	ND	0.101	ND	0.103	ND	0.120	ND	0.108	ND
Cadmium	2.5	0.329	ND	0.304	ND	0.308	ND	0.360	ND	0.323	ND
Calcium	~	2,130		11,100		9,380		3,100		3,290	
Chromium	~	4,630		2,830		2,870		29,700		9,290	
Cobalt	~	2,450		2,110		1,720		10,900		4,470	
Copper	50	5,710		4,590		4,800		27,500		10,400	
Iron	~	4,370		3,140		2,970		18,000		8,340	B
Lead	63	1,310		0,848		0,804		3,100		5,070	
Magnesium	~	1,940		5,250		4,010		7,280		3,410	B
Manganese	1600	180		89,900		100		305		210	
Nickel	30	6,870		5,440		5,010		24,900		9,800	
Potassium	~	278		273		256		2,140		735	
Selenium	3.9	1.100	ND	1.010	ND	1.030	ND	1.270		1.080	ND
Silver	2	0.548	ND	0.507	ND	0.513	ND	0.600	ND	0.538	ND
Sodium	~	157		128		144		227		130	B
Thallium	~	1.100	ND	1.010	ND	1.030	ND	1.200	ND	1.080	ND
Vanadium	~	6,710		4,350		3,810		33,200		12,600	
Zinc	109	10,800		7,980		8,060		56,700		20,400	
Mercury	0.18	0.0329	ND	0.0304	ND	0.0308	ND	0.0360	ND	0.0323	ND
Chromium, Hexavalent	1	0.548	ND	0.507	ND	0.513	ND	0.816		0.538	ND
Chromium, Trivalent	30	4,630		2,830		2,870		28,900		9,290	

Q is the Qualifier Column with definitions as follows:

D=result is from an analysis that required a dilution

J=analyte detected at or above the MDL (method detection limit) but below the RL (Reporting Limit) - data is estimated

ND=analyte not detected at or above the level indicated

B=analyte found in the analysis batch blank

E=result is estimated and cannot be accurately reported due to levels encountered or interferences

P=this flag is used for pesticide and PCB (Aroclor) target compounds when there is a % difference for detected concentrations that exceed method dictated limits between the two GC columns used for analysis

NT=this indicates the analyte was not a target for this sample

~=this indicates that no regulatory limit has been established for this analyte

Table 2
Soil Cleanup Objectives (SCOs)
40-05 Crescent Street, Long Island City, NY 11101

Contaminant	CAS Number	NYSDEC Part 375 Unrestricted Use Soil Cleanup Objectives (ppm)
Volatile Organic Compounds		
1,1,1-Trichloroethane	71-55-6	0.68
1,1-Dichloroethane	75-34-3	0.27
1,1-Dichloroethene	75-35-4	0.33
1,2-Dichlorobenzene	95-50-1	1.1
1,2-Dichloroethane	107-06-2	0.02
cis -1,2-Dichloroethene	156-59-2	0.25
trans-1,2-Dichloroethene	156-60-5	0.19
1,3-Dichlorobenzene	541-73-1	2.4
1,4-Dichlorobenzene	106-46-7	1.8
1,4-Dioxane	123-91-1	0.1
Acetone	67-64-1	0.05
Benzene	71-43-2	0.06
n-Butylbenzene	104-51-8	12
Carbon tetrachloride	56-23-5	0.76
Chlorobenzene	108-90-7	1.1
Chloroform	67-66-3	0.37
Ethylbenzene	100-41-4	1
Hexachlorobenzene	118-74-1	0.33
Methyl ethyl ketone	78-93-3	0.12
Methyl tert-butyl ether	1634-04-4	0.93
Methylene chloride	75-09-2	0.05
n - Propylbenzene	103-65-1	3.9
sec-Butylbenzene	135-98-8	11
tert-Butylbenzene	98-06-6	5.9
Tetrachloroethene	127-18-4	1.3
Toluene	108-88-3	0.7
Trichloroethene	79-01-6	0.47
1,2,4-Trimethylbenzene	95-63-6	3.6
1,3,5-Trimethylbenzenef	108-67-8	8.4
Vinyl chloride	75-01-4	0.02
Xylene (mixed)	1330-20-7	0.26
Semivolatile Organic Compounds		
Acenaphthene	83-32-9	20
Acenaphthylene	208-96-8	100
Anthracene	120-12-7	100
Benz(a)anthracene	56-55-3	1
Benzo(a)pyrene	50-32-8	1
Benzo(b)fluoranthene	205-99-2	1
Benzo(g,h,i)perylene	191-24-2	100
Benzo(k)fluoranthene	207-08-9	0.8
Chrysene	218-01-9	1
Dibenz(a,h)anthracene	53-70-3	0.33
Fluoranthene	206-44-0	100
Fluorene	86-73-7	30
Indeno(1,2,3-cd)pyrene	193-39-5	0.5
m-Cresol	108-39-4	0.33
Naphthalene	91-20-3	12
o-Cresol	95-48-7	0.33
p-Cresol	106-44-5	0.33
Pentachlorophenol	87-86-5	0.8
Phenanthrene	85-01-8	100
Phenol	108-95-2	0.33
Pyrene	129-00-0	100
Pesticides/PCBs		
2,4,5-TP Acid (Silvex)	93-72-1	3.8
4,4'-DDE	72-55-9	0.0033
4,4'-DDT	50-29-3	0.0033
4,4'-DDD	72-54-8	0.0033
Aldrin	309-00-2	0.005
alpha-BHC	319-84-6	0.02
beta-BHC	319-85-7	0.036
Chlordane (alpha)	5103-71-9	0.094
delta-BHC	319-86-8	0.04
Dibenzofuran	132-64-9	7
Dieldrin	60-57-1	0.005
Endosulfan I	959-98-8	2.4
Endosulfan II	33213-65-9	2.4
Endosulfan sulfate	1031-07-8	2.4
Endrin	72-20-8	0.014
Heptachlor	76-44-8	0.042
Lindane	58-89-9	0.1
Polychlorinated biphenyls	1336-36-3	0.1
Metals		
Arsenic	7440-38-2	13
Barium	7440-39-3	350
Beryllium	7440-41-7	7.2
Cadmium	7440-43-9	2.5
Chromium, hexavalent	18540-29-9	1
Chromium, trivalent	16065-83-1	30
Copper	7440-50-8	50
Total Cyanide		27
Lead	7439-92-1	63
Manganese	7439-96-5	1600
Total Mercury		0.18
Nickel	7440-02-0	30
Selenium	7782-49-2	3.9
Silver	7440-22-4	2
Zinc	7440-66-6	109

Table 3
Soil Disposal and Trucking Log Sheet

Shipment Date	Manifest Number	Transporter Name/Truck Name	License Plate	On-Site Location (approx. depth)	Off-Site Disposal Facility	Material Type (Contaminated soil, native soil, C&D, etc.)	Tonnage
9/23/2016	016327316 JJK	LV Co. Inc.	PA: AG36413	WC-3 (0-2')	CENJ - Clean Earth of North Jersey	Hazardous Lead	24.81
9/23/2016	016327317 JJK	LV Co. Inc.	PA: AF89306	WC-3 (0-2')	CENJ - Clean Earth of North Jersey	Hazardous Lead	23.89
9/23/2016	1350526	David Anderson #78	AT149F	WC-1, WC-2	KPIP - Kearney Point Industrial Park	Historic Fill	27.84
9/23/2016	1350517	RJT #099	AS162X	WC-1, WC-2	KPIP - Kearney Point Industrial Park	Historic Fill	30.12
9/23/2016	1350518	David Anderson #07	AR470F	WC-1, WC-2	KPIP - Kearney Point Industrial Park	Historic Fill	26.04
9/23/2016	1258532	JDC Trucking #9	AS249V	WC-1, WC-2	KPIP - Kearney Point Industrial Park	Historic Fill	29.89
9/23/2016	1294142	JDC Trucking #7	AS710D	WC-1, WC-2	KPIP - Kearney Point Industrial Park	Historic Fill	30.84
9/23/2016	1245391	JDC Trucking #6	AT713B	WC-1, WC-2	KPIP - Kearney Point Industrial Park	Historic Fill	28.7
9/23/2016	1430973	RJT #099	AS162X	WC-1, WC-2	KPIP - Kearney Point Industrial Park	Historic Fill	34.93
9/23/2016	1430972	David Anderson #78	AT149F	WC-1, WC-2	KPIP - Kearney Point Industrial Park	Historic Fill	28.66
9/23/2016	1430971	David Anderson #07	AR470F	WC-1, WC-2	KPIP - Kearney Point Industrial Park	Historic Fill	28.07
9/23/2016	1430970	JDC #8	AS710D	WC-1, WC-2	KPIP - Kearney Point Industrial Park	Historic Fill	31.03
9/23/2016	1430969	JDC #6	AT713B	WC-1, WC-2	KPIP - Kearney Point Industrial Park	Historic Fill	30.45
9/23/2016	1430968	CP Trucking #27	AT614F	WC-1, WC-2	KPIP - Kearney Point Industrial Park	Historic Fill	30.82
9/23/2016	1430967	RJT #099	AS162X	WC-1, WC-2	KPIP - Kearney Point Industrial Park	Historic Fill	35.46
9/23/2016	1430966	David Anderson #07	AT149F	WC-1, WC-2	KPIP - Kearney Point Industrial Park	Historic Fill	30.27
9/23/2016	1430965	David Anderson #78	AR470F	WC-1, WC-2	KPIP - Kearney Point Industrial Park	Historic Fill	29.89
9/26/2016	1430964	Shirley Express #26	AS122L	WC-1, WC-2	KPIP - Kearney Point Industrial Park	Historic Fill	31.6
9/26/2016	1430963	RLS Transportation #07	AT355A	WC-1, WC-2	KPIP - Kearney Point Industrial Park	Historic Fill	31.92
9/26/2016	1430962	Shirley Express #10	AS810V	WC-1, WC-2	KPIP - Kearney Point Industrial Park	Historic Fill	29.85
9/26/2016	1430961	Shirley Express #36	AS261B	WC-1, WC-2	KPIP - Kearney Point Industrial Park	Historic Fill	29.49
9/26/2016	1430960	Shirley Express #44	AS317W	WC-1, WC-2	KPIP - Kearney Point Industrial Park	Historic Fill	30.17
9/26/2016	1430959	RLS Transportation #17	AT356A	WC-1, WC-2	KPIP - Kearney Point Industrial Park	Historic Fill	29.91
9/26/2016	1430958	Shirley Express #26	AS122L	WC-1, WC-2	KPIP - Kearney Point Industrial Park	Historic Fill	32.21
9/26/2016	1430957	RLS Transportation #07	AT355A	WC-1, WC-2	KPIP - Kearney Point Industrial Park	Historic Fill	32.29
9/26/2016	1430956	Shirley Express #44	AS317W	WC-1, WC-2	KPIP - Kearney Point Industrial Park	Historic Fill	31.12
9/26/2016	1430955	Shirley Express #10	AS810V	WC-1, WC-2	KPIP - Kearney Point Industrial Park	Historic Fill	30.96
9/26/2016	1430954	RLS Transportation #17	AT356A	WC-1, WC-2	KPIP - Kearney Point Industrial Park	Historic Fill	30.92
9/26/2016	1430953	Shirley Express #26	AS122L	WC-1, WC-2	KPIP - Kearney Point Industrial Park	Historic Fill	32.76
9/26/2016	1430952	Shirley Express #44	AS317W	WC-1, WC-2	KPIP - Kearney Point Industrial Park	Historic Fill	31.55
9/26/2016	1430951	RLS Transportation #17	AT356A	WC-1, WC-2	KPIP - Kearney Point Industrial Park	Historic Fill	30.38
9/26/2016	1430950	Shirley Express #42	AS740V	WC-1, WC-2	KPIP - Kearney Point Industrial Park	Historic Fill	30.77
9/29/2016	1430949	J Granda Trans #27	AS647U	WC-1, WC-2	KPIP - Kearney Point Industrial Park	Historic Fill	32.96
9/29/2016	1430948	RJT Hauling #088	AS719L	WC-1, WC-2	KPIP - Kearney Point Industrial Park	Historic Fill	33.85
9/29/2016	1430947	Jencar #550	AT883D	WC-1, WC-2	KPIP - Kearney Point Industrial Park	Historic Fill	31.18
9/29/2016	1430946	Jencar #67	AR621C	WC-1, WC-2	KPIP - Kearney Point Industrial Park	Historic Fill	30.93
9/29/2016	1430945	J Granda Trans #17	AP694F	WC-1, WC-2	KPIP - Kearney Point Industrial Park	Historic Fill	30.39
9/29/2016	1430944	Jencar #62	AS595U	WC-1, WC-2	KPIP - Kearney Point Industrial Park	Historic Fill	31.98
9/29/2016	1430943	MCB Trucking #8	AS687P	WC-1, WC-2	KPIP - Kearney Point Industrial Park	Historic Fill	29.15
9/29/2016	1430942	RJT #099	AS162X	WC-1, WC-2	KPIP - Kearney Point Industrial Park	Historic Fill	33.27
9/29/2016	1430941	Jencar #74	AT172H	WC-1, WC-2	KPIP - Kearney Point Industrial Park	Historic Fill	29.77
9/29/2016	1430940	MCB Trucking	AP322V	WC-1, WC-2	KPIP - Kearney Point Industrial Park	Historic Fill	28.71
9/29/2016	1430939	PSM Trucking #2	AS834F	WC-1, WC-2	KPIP - Kearney Point Industrial Park	Historic Fill	28.94
9/29/2016	1430938	Jencar #68	AP812A	WC-1, WC-2	KPIP - Kearney Point Industrial Park	Historic Fill	29.33
9/29/2016	1430937	Jencar	AS241G	WC-1, WC-2	KPIP - Kearney Point Industrial Park	Historic Fill	27.19
9/29/2016	1430936	Jencar #70	AT368D	WC-1, WC-2	KPIP - Kearney Point Industrial Park	Historic Fill	28.6
9/29/2016	1430935	Jencar #73	AT683F	WC-1, WC-2	KPIP - Kearney Point Industrial Park	Historic Fill	29.12
9/29/2016	1430934	J Granda Trans #27	AS647U	WC-1, WC-2	KPIP - Kearney Point Industrial Park	Historic Fill	34.18
9/29/2016	1430933	RJT #88	AS719L	WC-1, WC-2	KPIP - Kearney Point Industrial Park	Historic Fill	32.49
9/29/2016	1430932	Jencar #550	AT883D	WC-1, WC-2	KPIP - Kearney Point Industrial Park	Historic Fill	28.84
9/29/2016	1430930	Jencar #67	AR621C	WC-1, WC-2	KPIP - Kearney Point Industrial Park	Historic Fill	32.26
9/29/2016	1430931	J Granda Trans #17	AP694F	WC-1, WC-2	KPIP - Kearney Point Industrial Park	Historic Fill	30.41
9/29/2016	1430929	Jencar #62	AS595U	WC-1, WC-2	KPIP - Kearney Point Industrial Park	Historic Fill	31.61
9/29/2016	1430928	MCB Trucking #8	AS687P	WC-1, WC-2	KPIP - Kearney Point Industrial Park	Historic Fill	31.62
9/29/2016	1430927	RJT #099	AS162X	WC-1, WC-2	KPIP - Kearney Point Industrial Park	Historic Fill	32.24
9/29/2016	1430926	Jencar #74	AT172H	WC-1, WC-2	KPIP - Kearney Point Industrial Park	Historic Fill	29.49
9/29/2016	1430925	MCB #3	AP322V	WC-1, WC-2	KPIP - Kearney Point Industrial Park	Historic Fill	28.55
9/29/2016	1430923	Jencar #70	AT968D	WC-1, WC-2	KPIP - Kearney Point Industrial Park	Historic Fill	32.32
9/29/2016	1430924	JDC #10	AT116L	WC-1, WC-2	KPIP - Kearney Point Industrial Park	Historic Fill	30.63
9/29/2016	1430922	Jencar #73	AT683F	WC-1, WC-2	KPIP - Kearney Point Industrial Park	Historic Fill	28.52
9/29/2016	1430921	J Granda Trans #27	AS647U	WC-1, WC-2	KPIP - Kearney Point Industrial Park	Historic Fill	32.28
9/29/2016	1430920	RJT #88	AS719L	WC-1, WC-2	KPIP - Kearney Point Industrial Park	Historic Fill	32.28
9/29/2016	1430919	JDC Trucking #9	AS249V	WC-1, WC-2	KPIP - Kearney Point Industrial Park	Historic Fill	29.59
10/3/2016	1430917	TEV #7	AR493G	WC-1, WC-2	KPIP - Kearney Point Industrial Park	Historic Fill	25.91
10/3/2016	1430916	TEV #6	AR492G	WC-1, WC-2	KPIP - Kearney Point Industrial Park	Historic Fill	27.3
10/3/2016	1430915	CV Trucking #57	AT537B	WC-1, WC-2	KPIP - Kearney Point Industrial Park	Historic Fill	27.99
10/3/2016	1430914	CV Trucking #55	AS202C	WC-1, WC-2	KPIP - Kearney Point Industrial Park	Historic Fill	26.26
10/3/2016	1430913	TEV Trucking #2	AR237E	WC-1, WC-2	KPIP - Kearney Point Industrial Park	Historic Fill	26.62
10/3/2016	1430912	TEV Trucking #7	AR493G	WC-1, WC-2	KPIP - Kearney Point Industrial Park	Historic Fill	27.3
10/3/2016	1430911	TEV #6	AR492G	WC-1, WC-2	KPIP - Kearney Point Industrial Park	Historic Fill	27.74
10/3/2016	1430910	CV Trucking #57	AT537B	WC-1, WC-2	KPIP - Kearney Point Industrial Park	Historic Fill	30.58
10/3/2016	1430908	TEV #2	AR237E	WC-1, WC-2	KPIP - Kearney Point Industrial Park	Historic Fill	28.31
10/3/2016	1430909	CV Trucking #55	AS202C	WC-1, WC-2	KPIP - Kearney Point Industrial Park	Historic Fill	27.26
10/3/2016	1430907	CV Trucking #55	AS202C	WC-1, WC-2	KPIP - Kearney Point Industrial Park	Historic Fill	29.07
10/4/2016	1430906	Mendez Trucking #91	AN556Y	WC-1, WC-2	KPIP - Kearney Point Industrial Park	Historic Fill	25.52
10/4/2016	1430905	Mendez Trucking #223	AM320V	WC-1, WC-2	KPIP - Kearney Point Industrial Park	Historic Fill	25.45
10/4/2016	1430904	Mendez Trucking #43	AT557B	WC-1, WC-2	KPIP - Kearney Point Industrial Park	Historic Fill	24.66
10/4/2016	1430903	TEV Trucking #11	AS405B	WC-1, WC-2	KPIP - Kearney Point Industrial Park	Historic Fill	27.15
10/4/2016	1430902	Mendez Trucking #21	AN694R	WC-1, WC-2	KPIP - Kearney Point Industrial Park	Historic Fill	26.01
10/4/2016	1430901	TEV #43	AT184D	WC-1, WC-2	KPIP - Kearney Point Industrial Park	Historic Fill	23.91
10/4/2016	1430900	Mendez #53	AS758P	WC-1, WC-2	KPIP - Kearney Point Industrial Park	Historic Fill	25.19
10/4/2016	1430899	CV Trucking #25	AS653U	WC-1, WC-2	KPIP - Kearney Point Industrial Park	Historic Fill	26.11
10/4/2016	1430898	CV Trucking #57	AT537B	WC-1, WC-2	KPIP - Kearney Point Industrial Park	Historic Fill	27.26
10/4/2016	1430897	Mendez Trucking #22	AP874P	WC-1, WC-2	KPIP - Kearney Point Industrial Park	Historic Fill	26.8
10/4/2016	1430896	Mendez Trucking #51	AS756P	WC-1, WC-2	KPIP - Kearney Point Industrial Park	Historic Fill	27.38
10/4/2016	1430895	TEV Trucking #11	AS405B	WC-1, WC-2	KPIP - Kearney Point Industrial Park	Historic Fill	23.79
10/4/2016	1430894	TEV #43	AT184D	WC-1, WC-2	KPIP - Kearney Point Industrial Park	Historic Fill	24.94
10/4/2016	1430893	Mendez Trucking #28	AN869W	WC-1, WC-2	KPIP - Kearney Point Industrial Park	Historic Fill	27.55
10/4/2016	1430892	CV Trucking #57	AT537B	WC-1, WC-2	KPIP - Kearney Point Industrial Park	Historic Fill	20.25
10/4/2016	1430891	Mendez Trucking #83	AL337N	WC-1, WC-2	KPIP - Kearney Point Industrial Park	Historic Fill	21.34
10/4/2016	1430890	Mendez Trucking #101	AP639R	WC-1, WC-2	KPIP - Kearney Point Industrial Park	Historic Fill	24.75

Table 3
Soil Disposal and Trucking Log Sheet

Shipment Date	Manifest Number	Transporter Name/Truck Name	License Plate	On-Site Location (approx. depth)	Off-Site Disposal Facility	Material Type (Contaminated soil, native soil, C&D, etc.)	Tonnage
10/4/2016	1430889	CV Trucking #25	AS653U	WC-1, WC-2	KPIP - Kearney Point Industrial Park	Historic Fill	25.65
10/5/2016	001	Colarusso	NY 49012MJ	Whole Site	CSB - Wards Island	Native Soil	19.975
10/5/2016	002	Colarusso	NY 86029ME	Whole Site	CSB - Wards Island	Native Soil	15.35
10/5/2016	003	Colarusso	NY 23228MD	Whole Site	CSB - Wards Island	Native Soil	20.925
10/5/2016	004	Colarusso	NY 49012MJ	Whole Site	CSB - Wards Island	Native Soil	21.125
10/5/2016	005	Colarusso	NY 86029ME	Whole Site	CSB - Wards Island	Native Soil	19.15
10/5/2016	006	Colarusso	NY 23228MD	Whole Site	CSB - Wards Island	Native Soil	20.35
10/5/2016	007	Colarusso	NY 62598MC	Whole Site	CSB - Wards Island	Native Soil	13.15
10/5/2016	008	Colarusso	NY 49012MJ	Whole Site	CSB - Wards Island	Native Soil	22.95
10/5/2016	009	Colarusso	NY 86029ME	Whole Site	CSB - Wards Island	Native Soil	22.525
10/5/2016	010	Colarusso	NY 23228MD	Whole Site	CSB - Wards Island	Native Soil	23.65
10/5/2016	011	Colarusso	NY 62598MC	Whole Site	CSB - Wards Island	Native Soil	9.675
10/5/2016	012	Colarusso	NY 49012MJ	Whole Site	CSB - Wards Island	Native Soil	17.2
10/5/2016	013	Colarusso	NY 86029ME	Whole Site	CSB - Wards Island	Native Soil	24.35
10/5/2016	014	Colarusso	NY 62598MC	Whole Site	CSB - Wards Island	Native Soil	23.325
10/5/2016	015	Colarusso	NY 23228MD	Whole Site	CSB - Wards Island	Native Soil	27.7
10/5/2016	016	Colarusso	NY 49012MJ	Whole Site	CSB - Wards Island	Native Soil	20.725
10/5/2016	017	Colarusso	NY 86029ME	Whole Site	CSB - Wards Island	Native Soil	21.175
10/5/2016	018	Colarusso	NY 62598MC	Whole Site	CSB - Wards Island	Native Soil	27.025
10/5/2016	019	Colarusso	NY 23228MD	Whole Site	CSB - Wards Island	Native Soil	26.25
10/7/2016	020	Colarusso	NY 86029ME	Whole Site	CSB - Wards Island	Native Soil	21.125
10/7/2016	021	Colarusso	NY 62598MC	Whole Site	CSB - Wards Island	Native Soil	14.425
10/7/2016	022	Colarusso	NY 60680MD	Whole Site	CSB - Wards Island	Native Soil	25.625
10/7/2016	023	Colarusso	NY 86029ME	Whole Site	CSB - Wards Island	Native Soil	22.675
10/7/2016	024	Colarusso	NY 62598MC	Whole Site	CSB - Wards Island	Native Soil	20.375
10/7/2016	025	Colarusso	NY 60680MD	Whole Site	CSB - Wards Island	Native Soil	23.825
10/7/2016	026	Colarusso	NY 86029ME	Whole Site	CSB - Wards Island	Native Soil	19.8
10/7/2016	027	Colarusso	NY 62598MC	Whole Site	CSB - Wards Island	Native Soil	18.4
10/7/2016	028	Colarusso	NY 60680MD	Whole Site	CSB - Wards Island	Native Soil	21.875
10/7/2016	029	Colarusso	NY 86029ME	Whole Site	CSB - Wards Island	Native Soil	21
10/7/2016	030	Colarusso	NY 62598MC	Whole Site	CSB - Wards Island	Native Soil	20.05
10/7/2016	031	Colarusso	NY 60680MD	Whole Site	CSB - Wards Island	Native Soil	20.925
10/7/2016	032	Colarusso	NY 86029ME	Whole Site	CSB - Wards Island	Native Soil	20.875
10/7/2016	033	Colarusso	NY 62598MC	Whole Site	CSB - Wards Island	Native Soil	15.775
10/7/2016	034	Colarusso	NY 60680MD	Whole Site	CSB - Wards Island	Native Soil	23.1875
12/15/2016	1	Colarusso	23228-MD	Whole Site	Evergreen Recycling of Corona	Native Soil	30**
12/15/2016	2	Colarusso	20802-MA	Whole Site	Evergreen Recycling of Corona	Native Soil	30**
12/15/2016	3	Two Cousins	35347-ME	Whole Site	Evergreen Recycling of Corona	Native Soil	30**
12/15/2016	4	Musso MTC	20892-MG	Whole Site	Evergreen Recycling of Corona	Native Soil	30**
12/15/2016	5	Colarusso	18543-MC	Whole Site	Evergreen Recycling of Corona	Native Soil	30**
12/15/2016	6	Colarusso	23228-MD	Whole Site	Evergreen Recycling of Corona	Native Soil	30**
12/15/2016	7	Two Cousins	35347-ME	Whole Site	Evergreen Recycling of Corona	Native Soil	30**
12/15/2016	8	Colarusso	20802-MA	Whole Site	Evergreen Recycling of Corona	Native Soil	30**
12/15/2016	9	Musso MTC	20892-MG	Whole Site	Evergreen Recycling of Corona	Native Soil	30**
12/15/2016	10	Two Cousins	18543-MC	Whole Site	Evergreen Recycling of Corona	Native Soil	30**
12/15/2016	11	HEITZ	45945-MH	Whole Site	Evergreen Recycling of Corona	Native Soil	30**
12/15/2016	12	Colarusso	23228-MD	Whole Site	Evergreen Recycling of Corona	Native Soil	30**
12/15/2016	13	Colarusso	20802-MA	Whole Site	Evergreen Recycling of Corona	Native Soil	30**
12/15/2016	14	Two Cousins	35347-ME	Whole Site	Evergreen Recycling of Corona	Native Soil	30**
12/15/2016	15	Musso MTC	20892-MG	Whole Site	Evergreen Recycling of Corona	Native Soil	30**
12/15/2016	16	Two Cousins	18543-MC	Whole Site	Evergreen Recycling of Corona	Native Soil	30**
12/15/2016	17	Colarusso	23228-MD	Whole Site	Evergreen Recycling of Corona	Native Soil	30**
12/15/2016	18	Colarusso	20802-MA	Whole Site	Evergreen Recycling of Corona	Native Soil	30**
12/15/2016	19	Musso MTC	20892-MG	Whole Site	Evergreen Recycling of Corona	Native Soil	30**
12/15/2016	20	Two Cousins	35347-ME	Whole Site	Evergreen Recycling of Corona	Native Soil	30**
12/15/2016	21	Two Cousins	18543-MC	Whole Site	Evergreen Recycling of Corona	Native Soil	30**
12/16/2016	22	Colarusso	86029-ME	Whole Site	Evergreen Recycling of Corona	Native Soil	30**
12/16/2016	23	Colarusso	70421-MH	Whole Site	Evergreen Recycling of Corona	Native Soil	30**
12/16/2016	24	Colarusso	23228-MD	Whole Site	Evergreen Recycling of Corona	Native Soil	30**
12/16/2016	25	Colarusso	62598-MC	Whole Site	Evergreen Recycling of Corona	Native Soil	30**
12/16/2016	26	Colarusso	49012-MJ	Whole Site	Evergreen Recycling of Corona	Native Soil	30**
12/16/2016	27	Colarusso	20802-MA	Whole Site	Evergreen Recycling of Corona	Native Soil	30**
12/16/2016	28	Colarusso	60680-MD	Whole Site	Evergreen Recycling of Corona	Native Soil	30**
12/16/2016	29	Colarusso	86029-ME	Whole Site	Evergreen Recycling of Corona	Native Soil	30**
12/16/2016	30	Colarusso	70421-MH	Whole Site	Evergreen Recycling of Corona	Native Soil	30**
12/16/2016	31	Colarusso	49012-MJ	Whole Site	Evergreen Recycling of Corona	Native Soil	30**
12/16/2016	32	Colarusso	23228-MD	Whole Site	Evergreen Recycling of Corona	Native Soil	30**
12/16/2016	33	Colarusso	62598-MC	Whole Site	Evergreen Recycling of Corona	Native Soil	30**
12/16/2016	34	Colarusso	20802-MA	Whole Site	Evergreen Recycling of Corona	Native Soil	30**
12/16/2016	35	Colarusso	60680-MD	Whole Site	Evergreen Recycling of Corona	Native Soil	30**
12/16/2016	36	Colarusso	86029-ME	Whole Site	Evergreen Recycling of Corona	Native Soil	30**
12/16/2016	37	Colarusso	49012-MJ	Whole Site	Evergreen Recycling of Corona	Native Soil	30**
12/16/2016	38	Colarusso	23228-MD	Whole Site	Evergreen Recycling of Corona	Native Soil	30**
12/16/2016	39	Colarusso	70421-MH	Whole Site	Evergreen Recycling of Corona	Native Soil	30**
12/16/2016	40	Colarusso	62598-MC	Whole Site	Evergreen Recycling of Corona	Native Soil	30**
12/16/2016	41	Colarusso	20802-MA	Whole Site	Evergreen Recycling of Corona	Native Soil	30**
12/16/2016	42	Colarusso	60680-MD	Whole Site	Evergreen Recycling of Corona	Native Soil	30**
12/16/2016	43	Colarusso	49012-MJ	Whole Site	Evergreen Recycling of Corona	Native Soil	30**
12/16/2016	44	Colarusso	23228-MD	Whole Site	Evergreen Recycling of Corona	Native Soil	30**
12/16/2016	45	Colarusso	86029-ME	Whole Site	Evergreen Recycling of Corona	Native Soil	30**
12/16/2016	46	Colarusso	70421-MH	Whole Site	Evergreen Recycling of Corona	Native Soil	30**
12/16/2016	47	Colarusso	62598-MC	Whole Site	Evergreen Recycling of Corona	Native Soil	30**
12/16/2016	48	Colarusso	20802-MA	Whole Site	Evergreen Recycling of Corona	Native Soil	30**
12/16/2016	49	Colarusso	60680-MD	Whole Site	Evergreen Recycling of Corona	Native Soil	30**
12/16/2016	50	Colarusso	49012-MJ	Whole Site	Evergreen Recycling of Corona	Native Soil	30**
12/16/2016	51	Colarusso	23228-MD	Whole Site	Evergreen Recycling of Corona	Native Soil	30**
12/16/2016	52	Colarusso	62598-MC	Whole Site	Evergreen Recycling of Corona	Native Soil	30**
12/16/2016	53	Colarusso	20802-MA	Whole Site	Evergreen Recycling of Corona	Native Soil	30**
12/19/2016	54	Colarusso	70421-MH	Whole Site	Evergreen Recycling of Corona	Native Soil	30**
12/19/2016	55	Colarusso	60680-MD	Whole Site	Evergreen Recycling of Corona	Native Soil	30**
12/19/2016	56	Colarusso	62598-MC	Whole Site	Evergreen Recycling of Corona	Native Soil	30**

**Table 3
Soil Disposal and Trucking Log Sheet**

Shipment Date	Manifest Number	Transporter Name/Truck Name	License Plate	On-Site Location (approx. depth)	Off-Site Disposal Facility	Material Type (Contaminated soil, native soil, C&D, etc.)	Tonnage
12/27/2016	42	Colarusso #30	20802-MA	Whole Site	832 Lexington Avenue	Native Soil	30*
12/27/2016	43	Colarusso #15	86029-ME	Whole Site	832 Lexington Avenue	Native Soil	30*
12/27/2016	44	Colarusso #33	62598-MC	Whole Site	832 Lexington Avenue	Native Soil	30*
12/27/2016	45	Colarusso #16	70421-MH	Whole Site	832 Lexington Avenue	Native Soil	30*
12/27/2016	46	Colarusso #35	60680-MD	Whole Site	832 Lexington Avenue	Native Soil	30*
12/27/2016	47	Colarusso #31	74671-MB	Whole Site	832 Lexington Avenue	Native Soil	30*
12/27/2016	48	Colarusso #17	49012-MJ	Whole Site	832 Lexington Avenue	Native Soil	30*
12/27/2016	107	Colarusso #30	20802-MA	Whole Site	Evergreen Recycling of Corona	Native Soil	30**
12/28/2016	108	Colarusso #35	60680-MD	Whole Site	Evergreen Recycling of Corona	Native Soil	30**
12/28/2016	109	Colarusso #32	48147-MH	Whole Site	Evergreen Recycling of Corona	Native Soil	30**
12/28/2016	110	Colarusso #17	49012-MJ	Whole Site	Evergreen Recycling of Corona	Native Soil	30**
12/28/2016	111	Colarusso #27	43917-JW	Whole Site	Evergreen Recycling of Corona	Native Soil	30**
12/28/2016	112	Colarusso #C.C.	13888-MA	Whole Site	Evergreen Recycling of Corona	Native Soil	30**
12/28/2016	1	Two Cousins #3	43995-MG	Whole Site	1525 Bedford Avenue	Native Soil	30*
12/28/2016	2	Two Cousins #20	76887-MH	Whole Site	1525 Bedford Avenue	Native Soil	30*
12/28/2016	3	Two Cousins #12	35347-ME	Whole Site	1525 Bedford Avenue	Native Soil	30*
12/28/2016	4	Colarusso #31	74671-MB	Whole Site	1525 Bedford Avenue	Native Soil	30*
12/28/2016	5	Colarusso #34	23228-MD	Whole Site	1525 Bedford Avenue	Native Soil	30*
12/28/2016	6	Colarusso #32	48147-MH	Whole Site	1525 Bedford Avenue	Native Soil	30*
12/28/2016	7	Colarusso #C.C.	13888-MA	Whole Site	1525 Bedford Avenue	Native Soil	30*
12/28/2016	8	Two Cousins #3	43995-MG	Whole Site	1525 Bedford Avenue	Native Soil	30*
12/28/2016	9	Two Cousins #20	76887-MH	Whole Site	1525 Bedford Avenue	Native Soil	30*
12/28/2016	10	Two Cousins #12	35347-ME	Whole Site	1525 Bedford Avenue	Native Soil	30*
12/28/2016	11	Colarusso #31	74671-MB	Whole Site	1525 Bedford Avenue	Native Soil	30*
12/28/2016	12	Colarusso #37	48053-MG	Whole Site	1525 Bedford Avenue	Native Soil	30*
12/28/2016	13	Colarusso #32	48147-MH	Whole Site	1525 Bedford Avenue	Native Soil	30*
12/28/2016	14	Colarusso #27	43917-JW	Whole Site	1525 Bedford Avenue	Native Soil	30*
12/28/2016	15	Two Cousins #3	43995-MG	Whole Site	1525 Bedford Avenue	Native Soil	30*
12/28/2016	16	Two Cousins #20	76887-MH	Whole Site	1525 Bedford Avenue	Native Soil	30*
12/28/2016	17	Two Cousins #12	35347-ME	Whole Site	1525 Bedford Avenue	Native Soil	30*
12/28/2016	18	Colarusso #31	74671-MB	Whole Site	1525 Bedford Avenue	Native Soil	30*
12/28/2016	19	Colarusso	81698-MJ	Whole Site	1525 Bedford Avenue	Native Soil	30*
12/28/2016	20	Colarusso #37	48053-MG	Whole Site	1525 Bedford Avenue	Native Soil	30*
1/6/2017	21	Colarusso #35	60680-MD	Whole Site	1525 Bedford Avenue	Native Soil	30*
1/6/2017	22	Colarusso #27	43917-JW	Whole Site	1525 Bedford Avenue	Native Soil	30*
1/6/2017	23	Colarusso #32	48147-MH	Whole Site	1525 Bedford Avenue	Native Soil	30*
1/6/2017	24	Colarusso #37	48053-MG	Whole Site	1525 Bedford Avenue	Native Soil	30*
1/6/2017	25	Colarusso #33	62598-MC	Whole Site	1525 Bedford Avenue	Native Soil	30*
1/6/2017	26	Colarusso #17	49012-MJ	Whole Site	1525 Bedford Avenue	Native Soil	30*
1/6/2017	27	Colarusso #15	86029-ME	Whole Site	1525 Bedford Avenue	Native Soil	30*
1/6/2017	28	Colarusso #27	43917-JW	Whole Site	1525 Bedford Avenue	Native Soil	30*
1/6/2017	29	Colarusso #35	60680-MD	Whole Site	1525 Bedford Avenue	Native Soil	30*
1/6/2017	30	Colarusso #33	62598-MC	Whole Site	1525 Bedford Avenue	Native Soil	30*
1/6/2017	31	Colarusso #37	48053-MG	Whole Site	1525 Bedford Avenue	Native Soil	30*
1/6/2017	32	Colarusso #17	49012-MJ	Whole Site	1525 Bedford Avenue	Native Soil	30*
1/6/2017	33	Colarusso #32	48147-MH	Whole Site	1525 Bedford Avenue	Native Soil	30*
1/6/2017	34	Colarusso #15	86029-ME	Whole Site	1525 Bedford Avenue	Native Soil	30*
1/6/2017	35	Colarusso #27	43917-JW	Whole Site	1525 Bedford Avenue	Native Soil	30*
1/6/2017	36	Colarusso #33	62598-MC	Whole Site	1525 Bedford Avenue	Native Soil	30*
1/6/2017	37	Colarusso #17	49012-MJ	Whole Site	1525 Bedford Avenue	Native Soil	30*
1/6/2017	38	Colarusso #37	48053-MG	Whole Site	1525 Bedford Avenue	Native Soil	30*
1/6/2017	39	Colarusso #32	48147-MH	Whole Site	1525 Bedford Avenue	Native Soil	30*
1/6/2017	40	Colarusso #35	60680-MD	Whole Site	1525 Bedford Avenue	Native Soil	30*
1/6/2017	113	Colarusso #15	86029-ME	Whole Site	Evergreen Recycling of Corona	Native Soil	30**
1/6/2017	114	Colarusso #27	43917-JW	Whole Site	Evergreen Recycling of Corona	Native Soil	30**
1/6/2017	115	Colarusso #17	49012-MJ	Whole Site	Evergreen Recycling of Corona	Native Soil	30**
1/6/2017	116	Colarusso #33	62598-MC	Whole Site	Evergreen Recycling of Corona	Native Soil	30**
1/6/2017	117	Colarusso #37	48053-MG	Whole Site	Evergreen Recycling of Corona	Native Soil	30**
1/6/2017	118	Colarusso #32	48147-MH	Whole Site	Evergreen Recycling of Corona	Native Soil	30**
1/6/2017	119	Colarusso #15	86029-ME	Whole Site	Evergreen Recycling of Corona	Native Soil	30**
1/17/2017	41	Colarusso #16	70421-MH	Whole Site	1525 Bedford Avenue	Native Soil	30*
1/17/2017	42	Colarusso #31	74671-MB	Whole Site	1525 Bedford Avenue	Native Soil	30*
1/17/2017	43	Two Cousins #18	59283-MA	Whole Site	1525 Bedford Avenue	Native Soil	30*
1/17/2017	44	Two Cousins #20	76887-MH	Whole Site	1525 Bedford Avenue	Native Soil	30*
1/17/2017	45	Colarusso #32	48147-MH	Whole Site	1525 Bedford Avenue	Native Soil	30*
1/17/2017	46	Colarusso #37	48053-MG	Whole Site	1525 Bedford Avenue	Native Soil	30*
1/17/2017	47	Two Cousins #12	35347-ME	Whole Site	1525 Bedford Avenue	Native Soil	30*
1/17/2017	48	Two Cousins #10	47893-MG	Whole Site	1525 Bedford Avenue	Native Soil	30*
1/17/2017	49	Colarusso #31	74671-MB	Whole Site	1525 Bedford Avenue	Native Soil	30*
1/17/2017	50	Colarusso #16	70421-MH	Whole Site	1525 Bedford Avenue	Native Soil	30*
1/17/2017	51	Two Cousins #18	59283-MA	Whole Site	1525 Bedford Avenue	Native Soil	30*
1/17/2017	52	Two Cousins #20	76887-MH	Whole Site	1525 Bedford Avenue	Native Soil	30*
1/17/2017	53	Two Cousins #12	35347-ME	Whole Site	1525 Bedford Avenue	Native Soil	30*
1/17/2017	54	Colarusso #37	48053-MG	Whole Site	1525 Bedford Avenue	Native Soil	30*
1/17/2017	55	Two Cousins #10	47893-MG	Whole Site	1525 Bedford Avenue	Native Soil	30*
1/17/2017	56	Colarusso #32	48147-MH	Whole Site	1525 Bedford Avenue	Native Soil	30*
1/17/2017	57	Colarusso #16	70421-MH	Whole Site	1525 Bedford Avenue	Native Soil	30*
1/17/2017	58	Colarusso #31	74671-MB	Whole Site	1525 Bedford Avenue	Native Soil	30*
1/17/2017	59	Colarusso #37	48053-MG	Whole Site	1525 Bedford Avenue	Native Soil	30*
1/17/2017	60	Two Cousins #18	59283-MA	Whole Site	1525 Bedford Avenue	Native Soil	30*
1/17/2017	61	Two Cousins #20	76887-MH	Whole Site	1525 Bedford Avenue	Native Soil	30*
1/17/2017	62	Two Cousins #12	35347-ME	Whole Site	1525 Bedford Avenue	Native Soil	30*
1/17/2017	63	Colarusso #32	48147-MH	Whole Site	1525 Bedford Avenue	Native Soil	30*
1/17/2017	64	Two Cousins #10	47893-MG	Whole Site	1525 Bedford Avenue	Native Soil	30*
1/20/2017	65	S. Vergata	80847-MH	Whole Site	1525 Bedford Avenue	Native Soil	30*
1/20/2017	66	VJ & Sons	86581-JN	Whole Site	1525 Bedford Avenue	Native Soil	30*
1/20/2017	67	Two Cousins #3	43995-MG	Whole Site	1525 Bedford Avenue	Native Soil	30*
1/20/2017	68	Colarusso #32	48147-MH	Whole Site	1525 Bedford Avenue	Native Soil	30*
1/20/2017	69	Colarusso #27	43917-JW	Whole Site	1525 Bedford Avenue	Native Soil	30*
1/20/2017	70	Colarusso #30	20802-MA	Whole Site	1525 Bedford Avenue	Native Soil	30*
1/20/2017	71	VJ & Sons	86581-JN	Whole Site	1525 Bedford Avenue	Native Soil	30*

Table 3
Soil Disposal and Trucking Log Sheet

Shipment Date	Manifest Number	Transporter Name/Truck Name	License Plate	On-Site Location (approx. depth)	Off-Site Disposal Facility	Material Type (Contaminated soil, native soil, C&D, etc.)	Tonnage
1/20/2017	72	Colarusso #32	48147-MH	Whole Site	1525 Bedford Avenue	Native Soil	30*
1/20/2017	73	Colarusso #27	48917-JW	Whole Site	1525 Bedford Avenue	Native Soil	30*
1/20/2017	74	S. Vergata	80847-MH	Whole Site	1525 Bedford Avenue	Native Soil	30*
1/20/2017	75	Two Cousins #3	43995-MG	Whole Site	1525 Bedford Avenue	Native Soil	30*
1/20/2017	76	Colarusso #30	20802-MA	Whole Site	1525 Bedford Avenue	Native Soil	30*
1/20/2017	77	VJ & Sons	86581-JN	Whole Site	1525 Bedford Avenue	Native Soil	30*
1/20/2017	78	Colarusso #32	48147-MH	Whole Site	1525 Bedford Avenue	Native Soil	30*
1/20/2017	79	Colarusso #27	43917-JW	Whole Site	1525 Bedford Avenue	Native Soil	30*
1/20/2017	80	Colarusso #30	20802-MA	Whole Site	1525 Bedford Avenue	Native Soil	30*
1/20/2017	81	Two Cousins #3	43995-MG	Whole Site	1525 Bedford Avenue	Native Soil	30*
1/20/2017	82	VJ & Sons	86581-JN	Whole Site	1525 Bedford Avenue	Native Soil	30*
1/20/2017	83	Colarusso #32	48147-MH	Whole Site	1525 Bedford Avenue	Native Soil	30*
1/20/2017	84	Colarusso #27	43917-JW	Whole Site	1525 Bedford Avenue	Native Soil	30*
1/26/2017	85	Colarusso #37	48053-MG	Whole Site	1525 Bedford Avenue	Native Soil	30*
1/26/2017	86	VJ & Sons	86581-JN	Whole Site	1525 Bedford Avenue	Native Soil	30*
1/26/2017	87	Colarusso # C.C.	13888-MA	Whole Site	1525 Bedford Avenue	Native Soil	30*
1/26/2017	88	VJ & Sons #28	21495-TC	Whole Site	1525 Bedford Avenue	Native Soil	30*
1/26/2017	89	Colarusso #32	48147-MH	Whole Site	1525 Bedford Avenue	Native Soil	30*
1/26/2017	90	Colarusso #31	74671-MB	Whole Site	1525 Bedford Avenue	Native Soil	30*
1/26/2017	91	Colarusso #37	48053-MG	Whole Site	1525 Bedford Avenue	Native Soil	30*
1/26/2017	92	VJ & Sons	86581-JN	Whole Site	1525 Bedford Avenue	Native Soil	30*
1/26/2017	93	Colarusso # C.C.	13888-MA	Whole Site	1525 Bedford Avenue	Native Soil	30*
1/26/2017	94	Colarusso #32	48147-MH	Whole Site	1525 Bedford Avenue	Native Soil	30*
1/26/2017	95	VJ & Sons #28	21495-TC	Whole Site	1525 Bedford Avenue	Native Soil	30*
1/26/2017	96	Colarusso #31	74671-MB	Whole Site	1525 Bedford Avenue	Native Soil	30*
1/26/2017	97	Colarusso #37	48053-MG	Whole Site	1525 Bedford Avenue	Native Soil	30*
1/26/2017	98	VJ & Sons	86581-JN	Whole Site	1525 Bedford Avenue	Native Soil	30*
1/26/2017	99	Colarusso #32	48147-MH	Whole Site	1525 Bedford Avenue	Native Soil	30*
1/26/2017	100	Colarusso #C.C.	13888-MA	Whole Site	1525 Bedford Avenue	Native Soil	30*
1/26/2017	101	VJ & Sons #28	21495-TC	Whole Site	1525 Bedford Avenue	Native Soil	30*
1/26/2017	102	Colarusso #31	74671-MB	Whole Site	1525 Bedford Avenue	Native Soil	30*
1/26/2017	103	Colarusso #37	48053-MG	Whole Site	1525 Bedford Avenue	Native Soil	30*
1/26/2017	104	VJ & Sons	86581-JN	Whole Site	1525 Bedford Avenue	Native Soil	30*
1/26/2017	105	Colarusso #32	48147-MH	Whole Site	1525 Bedford Avenue	Native Soil	30*
1/26/2017	106	Colarusso #C.C.	13888-MA	Whole Site	1525 Bedford Avenue	Native Soil	30*
1/26/2017	107	Colarusso #33	62598-MC	Whole Site	1525 Bedford Avenue	Native Soil	30*
1/26/2017	108	Colarusso #31	47671-MB	Whole Site	1525 Bedford Avenue	Native Soil	30*
1/26/2017	109	VJ & Sons #28	21495-TC	Whole Site	1525 Bedford Avenue	Native Soil	30*
2/14/2017	110	Colarusso #31	74671-MB	Whole Site	1525 Bedford Avenue	Native Soil	30*
2/14/2017	111	Colarusso #27	43917-JW	Whole Site	1525 Bedford Avenue	Native Soil	30*
2/14/2017	112	Two Cousins #12	35347-ME	Whole Site	1525 Bedford Avenue	Native Soil	30*
2/14/2017	113	WAP Express #14	33538-MD	Whole Site	1525 Bedford Avenue	Native Soil	30*
2/14/2017	114	B&R	66776-MJ	Whole Site	1525 Bedford Avenue	Native Soil	30*
2/14/2017	115	Colarusso #31	74671-MB	Whole Site	1525 Bedford Avenue	Native Soil	30*
2/14/2017	116	Colarusso #27	48917-JW	Whole Site	1525 Bedford Avenue	Native Soil	30*
2/14/2017	117	Two Cousins #12	35347-ME	Whole Site	1525 Bedford Avenue	Native Soil	30*
2/14/2017	118	WAP Express #14	33538-MD	Whole Site	1525 Bedford Avenue	Native Soil	30*
2/14/2017	120	WAP Express #14	33538-MD	Whole Site	Evergreen Recycling of Corona	Native Soil	30**
2/14/2017	121	Colarusso #31	74671-MB	Whole Site	Evergreen Recycling of Corona	Native Soil	30**
2/14/2017	122	Colarusso #27	48917-JW	Whole Site	Evergreen Recycling of Corona	Native Soil	30**
2/14/2017	123	B&R	66776-MJ	Whole Site	Evergreen Recycling of Corona	Native Soil	30**
2/14/2017	124	Two Cousins #12	35347-ME	Whole Site	Evergreen Recycling of Corona	Native Soil	30**
2/14/2017	125	Colarusso #31	74671-MB	Whole Site	Evergreen Recycling of Corona	Native Soil	30**
2/14/2017	126	Colarusso #27	48917-JW	Whole Site	Evergreen Recycling of Corona	Native Soil	30**
2/14/2017	127	WAP Express #14	33538-MD	Whole Site	Evergreen Recycling of Corona	Native Soil	30**
2/14/2017	128	Two Cousins #12	35347-ME	Whole Site	Evergreen Recycling of Corona	Native Soil	30**
2/14/2017	129	TEMPA	81678-MJ	Whole Site	Evergreen Recycling of Corona	Native Soil	30**
2/14/2017	130	B&R	66776-MJ	Whole Site	Evergreen Recycling of Corona	Native Soil	30**
2/23/2017	131	Savco Industries	44160-MG	Grid #3	Evergreen Recycling of Corona	Native Soil	30**
2/23/2017	132	Two Cousins	76887-MH	Grid #3	Evergreen Recycling of Corona	Native Soil	30**
2/23/2017	133	J&S	88259-MD	Grid #3	Evergreen Recycling of Corona	Native Soil	30**
2/23/2017	134	Savco Industries	44160-MG	Grid #3	Evergreen Recycling of Corona	Native Soil	30**
2/23/2017	135	Two Cousins	76887-MH	Grid #3	Evergreen Recycling of Corona	Native Soil	30**
2/23/2017	136	J&S	88259-MD	Grid #3	Evergreen Recycling of Corona	Native Soil	30**
2/23/2017	137	Savco Industries	44160-MG	Grid #3	Evergreen Recycling of Corona	Native Soil	30**
2/23/2017	138	Two Cousins	76887-MH	Grid #3	Evergreen Recycling of Corona	Native Soil	30**
2/23/2017	139	J&S	88259-MD	Grid #3	Evergreen Recycling of Corona	Native Soil	30**
2/23/2017	140	Two Cousins	76887-MH	Grid #3	Evergreen Recycling of Corona	Native Soil	30**
2/23/2017	141	J&S	88259-MD	Grid #3	Evergreen Recycling of Corona	Native Soil	30**
2/23/2017	142	Savco Industries	44160-MG	Grid #3	Evergreen Recycling of Corona	Native Soil	30**
4/3/2017	143	Colarusso #31	74671-MB	Grid #3	Evergreen Recycling of Corona	Native Soil	30**
4/3/2017	144	Colarusso #32	48147-MH	Grid #3	Evergreen Recycling of Corona	Native Soil	30**
4/3/2017	145	Colarusso #31	74671-MB	Grid #3	Evergreen Recycling of Corona	Native Soil	30**
4/3/2017	146	Colarusso #32	48147-MH	Grid #3	Evergreen Recycling of Corona	Native Soil	30**
4/3/2017	147	Colarusso #31	74671-MB	Grid #3	Evergreen Recycling of Corona	Native Soil	30**
4/3/2017	148	Colarusso #32	48147-MH	Grid #3	Evergreen Recycling of Corona	Native Soil	30**
4/3/2017	149	Colarusso #31	74671-MB	Grid #3	Evergreen Recycling of Corona	Native Soil	30**
4/3/2017	119	Colarusso #31	74671-MB	Grid #3	1525 Bedford Avenue	Native Soil	30*
4/3/2017	120	Colarusso #32	48147-MH	Grid #3	1525 Bedford Avenue	Native Soil	30*
4/4/2017	150	Colarusso #32	48147-MH	Grid #3	Evergreen Recycling of Corona	Native Soil	30**
4/4/2017	151	Colarusso #31	74671-MB	Grid #3	Evergreen Recycling of Corona	Native Soil	30**
4/4/2017	152	Two Cousins #3	43995-MG	Grid #3	Evergreen Recycling of Corona	Native Soil	30**
4/4/2017	153	Colarusso #27	43917-JW	Grid #3	Evergreen Recycling of Corona	Native Soil	30**
4/4/2017	154	Colarusso #32	48147-MH	Grid #3	Evergreen Recycling of Corona	Native Soil	30**
4/4/2017	155	Colarusso #31	74671-MB	Grid #3	Evergreen Recycling of Corona	Native Soil	30**
4/4/2017	156	Two Cousins #3	43995-MG	Grid #3	Evergreen Recycling of Corona	Native Soil	30**
4/4/2017	157	Colarusso #27	43917-JW	Grid #3	Evergreen Recycling of Corona	Native Soil	30**
4/4/2017	158	Colarusso #31	74671-MB	Grid #3	Evergreen Recycling of Corona	Native Soil	30**
4/4/2017	159	Two Cousins #3	43995-MG	Grid #3	Evergreen Recycling of Corona	Native Soil	30**
4/4/2017	160	Colarusso #27	43917-JW	Grid #3	Evergreen Recycling of Corona	Native Soil	30**
4/4/2017	161	Colarusso #31	74671-MB	Grid #3	Evergreen Recycling of Corona	Native Soil	30**

**Table 3
Soil Disposal and Trucking Log Sheet**

Shipment Date	Manifest Number	Transporter Name/Truck Name	License Plate	On-Site Location (approx. depth)	Off-Site Disposal Facility	Material Type (Contaminated soil, native soil, C&D, etc.)	Tonnage
6/23/2017	253	Two Cousins #12	35347-ME	Grid #1	Evergreen Recycling of Corona	Native Soil	30**
6/23/2017	254	B&R Concrete Corp	66776-MJ	Grid #1	Evergreen Recycling of Corona	Native Soil	30**
6/23/2017	255	Soloman #6	45629-MG	Grid #1	Evergreen Recycling of Corona	Native Soil	30**
6/23/2017	256	Two Cousins #12	35347-ME	Grid #1	Evergreen Recycling of Corona	Native Soil	30**
6/23/2017	257	B&R Concrete Corp	66776-MJ	Grid #1	Evergreen Recycling of Corona	Native Soil	30**
6/23/2017	258	Soloman #6	45629-MG	Grid #1	Evergreen Recycling of Corona	Native Soil	30**
6/23/2017	259	Two Cousins #12	35347-ME	Grid #1	Evergreen Recycling of Corona	Native Soil	30**
6/23/2017	260	Soloman #6	45629-MG	Grid #1	Evergreen Recycling of Corona	Native Soil	30**
6/23/2017	261	B&R Concrete Corp	66776-MJ	Grid #1	Evergreen Recycling of Corona	Native Soil	30**
6/23/2017	262	Two Cousins #12	35347-ME	Grid #1	Evergreen Recycling of Corona	Native Soil	30**
6/23/2017	263	Colarusso #34	CCC-34	Grid #1	Evergreen Recycling of Corona	Native Soil	30**
6/23/2017	264	Colarusso #30	20280-MA	Grid #1	Evergreen Recycling of Corona	Native Soil	30**
6/23/2017	265	Soloman #6	45629-MG	Grid #1	Evergreen Recycling of Corona	Native Soil	30**
7/6/2017	266	Two Cousins #20	76887-MH	Grid #1	Evergreen Recycling of Corona	Native Soil	30**
7/6/2017	267	CCC #12	38903-MK	Grid #1	Evergreen Recycling of Corona	Native Soil	30**
7/6/2017	268	SBN Enterprise #792	15570-MG	Grid #1	Evergreen Recycling of Corona	Native Soil	30**
7/6/2017	269	Sun Star #905	91362-JX	Grid #1	Evergreen Recycling of Corona	Native Soil	30**
7/6/2017	270	HiTec Cons Corp #02	48366-MG	Grid #1	Evergreen Recycling of Corona	Native Soil	30**
7/6/2017	271	CCC #12	38903-MK	Grid #1	Evergreen Recycling of Corona	Native Soil	30**
7/6/2017	272	Two Cousins #20	76887-MH	Grid #1	Evergreen Recycling of Corona	Native Soil	30**
7/6/2017	273	SBN Enterprise #792	15570-MG	Grid #1	Evergreen Recycling of Corona	Native Soil	30**
7/6/2017	274	Sun Star #905	91362-JX	Grid #1	Evergreen Recycling of Corona	Native Soil	30**
7/6/2017	275	HiTec Cons Corp #02	48366-MG	Grid #1	Evergreen Recycling of Corona	Native Soil	30**
7/6/2017	276	CCC #12	38903-MK	Grid #1	Evergreen Recycling of Corona	Native Soil	30**
7/6/2017	277	Colarusso #15	86029-ME	Grid #1	Evergreen Recycling of Corona	Native Soil	30**
7/6/2017	278	Two Cousins #20	76887-MH	Grid #1	Evergreen Recycling of Corona	Native Soil	30**
7/6/2017	279	SBN Enterprise #792	15570-MG	Grid #1	Evergreen Recycling of Corona	Native Soil	30**
7/6/2017	280	Colarusso #34	CCC-34	Grid #1	Evergreen Recycling of Corona	Native Soil	30**
7/6/2017	281	Sun Star #905	91362-JX	Grid #1	Evergreen Recycling of Corona	Native Soil	30**
7/6/2017	282	HiTec Cons Corp #02	48366-MG	Grid #1	Evergreen Recycling of Corona	Native Soil	30**
7/6/2017	283	Colarusso #15	86029-ME	Grid #1	Evergreen Recycling of Corona	Native Soil	30**
7/6/2017	284	Colarusso #30	20802-MA	Grid #1	Evergreen Recycling of Corona	Native Soil	30**
7/6/2017	285	Two Cousins #20	76887-MH	Grid #1	Evergreen Recycling of Corona	Native Soil	30**
7/6/2017	286	Colarusso #34	CCC-34	Grid #1	Evergreen Recycling of Corona	Native Soil	30**
7/7/2017	287	Colarusso #35	60680-MD	Grid #1	Evergreen Recycling of Corona	Native Soil	30**
7/7/2017	288	CCC #12	38903-MK	Grid #1	Evergreen Recycling of Corona	Native Soil	30**
7/7/2017	289	Two Cousins #3	43995-MG	Grid #1	Evergreen Recycling of Corona	Native Soil	30**
7/7/2017	290	Colarusso #32	48147-MH	Grid #1	Evergreen Recycling of Corona	Native Soil	30**
7/7/2017	291	Two Cousins #14	23261-MD	Grid #1	Evergreen Recycling of Corona	Native Soil	30**
7/7/2017	292	Colarusso #35	60680-MD	Grid #1	Evergreen Recycling of Corona	Native Soil	30**
7/7/2017	293	CCC #12	38903-MK	Grid #1	Evergreen Recycling of Corona	Native Soil	30**
7/7/2017	294	Two Cousins #3	43995-MG	Grid #1	Evergreen Recycling of Corona	Native Soil	30**
7/7/2017	295	Two Cousins #14	23261-MD	Grid #1	Evergreen Recycling of Corona	Native Soil	30**
7/7/2017	296	Colarusso #32	48147-MH	Grid #1	Evergreen Recycling of Corona	Native Soil	30**
7/7/2017	297	Colarusso #35	60680-MD	Grid #1	Evergreen Recycling of Corona	Native Soil	30**
7/7/2017	298	CCC #12	38903-MK	Grid #1	Evergreen Recycling of Corona	Native Soil	30**
7/7/2017	299	Two Cousins #3	43995-MG	Grid #1	Evergreen Recycling of Corona	Native Soil	30**
7/7/2017	300	Colarusso #32	48147-MH	Grid #1	Evergreen Recycling of Corona	Native Soil	30**
7/7/2017	301	Two Cousins #14	23261-MD	Grid #1	Evergreen Recycling of Corona	Native Soil	30**
7/7/2017	302	Colarusso #35	60680-MD	Grid #1	Evergreen Recycling of Corona	Native Soil	30**
7/7/2017	303	CCC #12	38903-MK	Grid #1	Evergreen Recycling of Corona	Native Soil	30**
7/7/2017	304	Two Cousins #3	43995-MG	Grid #1	Evergreen Recycling of Corona	Native Soil	30**
7/7/2017	305	Two Cousins #14	23261-MD	Grid #1	Evergreen Recycling of Corona	Native Soil	30**
7/7/2017	306	Colarusso #32	48147-MH	Grid #1	Evergreen Recycling of Corona	Native Soil	30**
7/7/2017	307	CCC #12	38903-MK	Grid #1	Evergreen Recycling of Corona	Native Soil	30**
7/10/2017	308	Colarusso #35	60680-MD	Grid #1	Evergreen Recycling of Corona	Native Soil	30**
7/10/2017	309	CCC #12	38903-MK	Grid #1	Evergreen Recycling of Corona	Native Soil	30**
7/10/2017	310	Colarusso #34	CCC-34	Grid #1	Evergreen Recycling of Corona	Native Soil	30**
7/10/2017	311	Colarusso #32	48147-MH	Grid #1	Evergreen Recycling of Corona	Native Soil	30**
7/10/2017	312	Colarusso #35	60680-MD	Grid #1	Evergreen Recycling of Corona	Native Soil	30**
7/10/2017	313	Colarusso #12	38903-MK	Grid #1	Evergreen Recycling of Corona	Native Soil	30**
7/10/2017	314	Colarusso #34	CCC-34	Grid #1	Evergreen Recycling of Corona	Native Soil	30**
7/10/2017	315	Colarusso #32	48147-MH	Grid #1	Evergreen Recycling of Corona	Native Soil	30**
7/10/2017	316	Colarusso #35	60680-MD	Grid #1	Evergreen Recycling of Corona	Native Soil	30**
7/10/2017	317	Colarusso #34	CCC-34	Grid #1	Evergreen Recycling of Corona	Native Soil	30**
7/10/2017	318	Colarusso #32	48147-MH	Grid #1	Evergreen Recycling of Corona	Native Soil	30**
7/10/2017	319	Colarusso #35	60680-MD	Grid #1	Evergreen Recycling of Corona	Native Soil	30**
7/10/2017	320	Colarusso #34	CCC-34	Grid #1	Evergreen Recycling of Corona	Native Soil	30**
7/10/2017	321	Colarusso #32	48147-MH	Grid #1	Evergreen Recycling of Corona	Native Soil	30**
7/11/2017	322	Colarusso #27	43917-JW	Grid #1	Evergreen Recycling of Corona	Native Soil	30**
7/11/2017	323	Colarusso #27	43917-JW	Grid #1	Evergreen Recycling of Corona	Native Soil	30**
7/11/2017	324	Colarusso #27	43917-JW	Grid #1	Evergreen Recycling of Corona	Native Soil	30**
7/11/2017	325	Colarusso #27	43917-JW	Grid #1	Evergreen Recycling of Corona	Native Soil	30**
7/11/2017	326	Colarusso #27	43917-JW	Grid #1	Evergreen Recycling of Corona	Native Soil	30**

*: Estimate based on the size of the load, as scale tickets were not provided from these CSB receiving sites
 **: Estimate based on the size of the load, as the receiving facility does not weigh the material upon arrival

Approximate Total = 18,204.85 Tons