



ENVIRONMENTAL BUSINESS CONSULTANTS

October 1, 2021

New York City Office of Environmental Remediation
City Voluntary Cleanup Program
c/o Shaminder Chawla
100 Gold Street, 2nd Floor
New York, NY 10038

**Re: E-Designation No. 21EH-N188K
639 and 641 East 28th Street, Brooklyn, NY 11210
Remedial Action Work Plan (RAWP) Stipulation List**

Dear Mr. Chawla:

Environmental Business Consultants hereby submits a Remedial Action Plan (RAWP) stipulation list for the site to the New York City Office of Environmental Remediation (OER) on behalf of Candor Capital. This letter serves as an addendum to the RAWP to stipulate additional content, requirements, and procedures that will be followed during the site remediation. The contents of this list are added to the RAWP and will supersede the content in the RAWP where there is a conflict in purpose or intent. The additional requirements/procedures include the following stipulation list below:

1. The criterion attached in **Appendix 1** will be utilized if additional petroleum containing tank or vessel is identified during the remedial action or subsequent redevelopment excavation activities. All petroleum spills will be reported to the NYSDEC hotline as required by applicable laws and regulations. This contingency plan is designed for heating oil tanks and other small or moderately sized storage vessels. If larger tanks, such as gasoline storage tanks are identified, OER will be notified before this criterion is utilized.
2. A pre-construction meeting is required prior to start of remedial excavation work at the site. A pre-construction meeting will be held at the site and will be attended by OER, the developer or developer representative, the consultant, excavation/general contractor, and if applicable, the soil broker.
3. A Historic Fill Transfer and Disposal Notification Form to each disposal facility and a pre-approval letter from all disposal facilities will be provided to OER prior to any soil/fill material removal from the site. The Historic Fill Transfer and Disposal Notification Form template is attached in **Appendix 2**. Documentation specified in the RAWP - Appendix 3 - Section 1.6 "Materials Disposal Off-Site" will be provided to OER. If a different disposal facility for the soil/fill material is selected, OER will be notified immediately.
4. Monthly reports are required on the project's status and schedule to the OER project manager after RAWP/RAP is approved/NTP issued until Remedial Action Report/Remedial Closure Report is received. This is your (Environmental Consultant's) responsibility to provide this report. If you (environmental consultant) are no longer retained for continuation of project, you are required to notify OER about this. After excavation work is completed, monthly reports are still required and will be provided by the consultant or owner/developer for the duration of the construction period. Monthly report template is attached in **Appendix 4**.
5. Daily reports will be provided during active excavation work. If no work is performed for extended time period, daily report frequency will be reduced to weekly basis. Daily report template is attached in **Appendix 3**.



ENVIRONMENTAL BUSINESS CONSULTANTS

1808 MIDDLE COUNTRY ROAD
RIDGE, NY 11961

PHONE 631.504.6000
FAX 631.924.2870

6. Trucking log sheets will be utilized as trucks are transported from sites, and completed logs should be attached to the Remedial Action Report (RAR) as an appendix. The goal of this log is to clearly document the destination of material leaving the site, the parties responsible for its transfer, and other pertinent details. The trucking log template is provided in **Appendix 5**.
7. Dewatering if needed, will be performed in full compliance with applicable laws, rules and regulations. Dewatering permit will be obtained from NYCDEP prior to construction activities.
8. Truck routing to the project site shall only occur according with the approved RAWP. The applicant, applicant's consultant and contractors are responsible for maintaining proper traffic in the vicinity of the site during all field operations, truck loading/unloading, etc.
9. The excavation diagram is provided in **Appendix 6**. The top of the cellar slab will be constructed at a depth of 10 feet below grade. Therefore, the area of the cellar (1,890 ft²) will require excavation to a depth of 11 feet below grade to construct the new building's cellar. Additional excavation to a depth of approximately 17 feet below grade will be required for an elevator pit. The at-grade portion of the building will require excavation to a depth of approximately 2-3ft, and excavation in the rear courtyard will be performed to a depth of 1 ft. Approximately 1,200 cubic yards (1,800 tons) of soil/fill will be excavated for the building's foundation.
10. Collection and analysis of seven (7) end-point samples from the bottom of the excavation to evaluate the performance of the remedy with respect to attainment of Track 1 SCOs. A map indicating end-point sampling locations is attached in **Appendix 6**. Samples will be analyzed for VOCs, SVOCs, Metals, and Pesticides/PCBs.
11. The stamped/signed RAWP certification page is included in **Appendix 7**.
12. Stabilized construction entrance and decontamination area will be constructed. All vehicle will be cleaned on-site to avoid any tracked materials (e.g., soils) spilling on roadways. Also, erosion controls must be installed, if necessary.
13. Applicant, Applicant's consultant and contractors and contractors are responsible for obtaining all permits necessary for the performance of the work, as well as, paying all associated fees (e.g., demolition, temporary water connection, dewatering, temporary electric connection, etc.).
14. Applicants and Applicant's consultant shall be solely responsible for initiating, maintaining, and supervising all safety precautions and programs in connection with the work. Copy of the Health and Safety Plan (HASP) must be provided to the subcontractor(s). Copy of the HASP should be available at the site at all times.

Sincerely,

Environmental Business Consultants



Kevin Brussee
Vice President

Appendix 1

Generic Procedures for Management of Underground Storage Tanks Identified under the NYC VCP

Prior to Tank removal, the following procedures should be followed:

- Remove all fluid to its lowest draw-off point.
- Drain and flush piping into the tank.
- Vacuum out the “tank bottom” consisting of water product and sludge.
- Dig down to the top of the tank and expose the upper half.
- Remove the fill tube and disconnect the fill, gauge, product, vent lines and pumps. Cap and plug open ends of lines.
- Temporarily plug all tank openings, complete the excavation, remove the tank and place it in a secure location.
- Render the tank safe and check the tank atmosphere to ensure that petroleum vapors have been satisfactorily purged from the tank.
- Clean tank or remove to storage yard for cleaning.
- If the tank is to be moved, it must be transported by licensed waste transporter. Plug and cap all holes prior to transport leaving a 1/8 inch vent hole located at the top of the tank during transport.
- After cleaning, the tank must be made acceptable for disposal at a scrap yard, cleaning the tanks interior with a high pressure rinse and cutting the tank in several pieces.

During the tank and pipe line removal, the following field observations should be made and recorded:

- A description and photographic documentation of the tank and pipe line condition (pitting, holes, staining, leak points, evidence of repairs, etc.).
- Examination of the excavation floor and sidewalls for physical evidence of contamination (odor, staining, sheen, etc.).
- Periodic field screening (through bucket return) of the floor and sidewalls of the excavation, with a calibrated photoionization detector (PID).

Impacted Soil Excavation Methods

The excavation of the impacted soil will be performed following the removal of the existing tanks. Soil excavation will be performed in accordance with the procedures described under Section 5.5 of Draft DER-10 as follows:

- A description and photographic documentation of the excavation.
- Examination of the excavation floor and sidewalls for physical evidence of contamination (odor, staining, sheen, etc.).
- Periodic field screening (through bucket return) of the floor and sidewalls of the excavation, with calibrated photoionization detector (PID).
- Final excavation depth, length, and width will be determined in the field, and will depend on the horizontal and vertical extent of contaminated soils as indentified through physical examination (PID response, odor, staining, etc.).
- Collection of verification samples will be performed to evaluate the success of the removal action as specified in this document.

The following procedure will be used for the excavation of impacted soil (as necessary and appropriate):

- Wear appropriate health and safety equipment as outlined in the Health and Safety Plan.
- Prior to excavation, ensure that the area is clear of utility lines or other obstructions. Lay plastic sheeting on the ground next to the area to be excavated.

- Using a rubber-tired backhoe or track mounted excavator, remove overburden soils and stockpile, or dispose of, separate from the impacted soil.
- If additional UST's are discovered, the NYSDEC will be notified and the best course of action to remove the structure should be determined in the field. This may involve the continued trenching around the perimeter to minimize its disturbance.
- If physically contaminated soil is present (e.g., staining, odors, sheen, PID response, etc.) an attempt will be made to remove it, to the extent not limited by the site boundaries or the bedrock surface. If possible, physically impacted soil will be removed using the backhoe or excavator, segregated from clean soils and overburden, and staged on separated dedicated plastic sheeting or live loaded into trucks from the disposal facility. Removal of the impacted soils will continue until visibly clean material is encountered and monitoring instruments indicate that no contaminants are present.
- Excavated soils which are temporarily stockpiled on-site will be covered with tarp material while disposal options are determined. Tarp will be checked on a daily basis and replaced, repaired or adjusted as needed to provide full coverage. The sheeting will be shaped and secured in such a manner as to drain runoff and direct it toward the interior of the property.

Once the site representative and regulatory personnel are satisfied with the removal effort, verification of confirmatory samples will be collected from the excavation in accordance with DER-10.



ENVIRONMENTAL BUSINESS CONSULTANTS

Appendix 2

Historic Fill Transfer and Disposal Notification Form



ENVIRONMENTAL BUSINESS CONSULTANTS

**1808 MIDDLE COUNTRY ROAD
RIDGE, NY 11961**

**PHONE 631.504.6000
FAX 631.924.2870**



**Historic Fill & Soil Disposal Notification Form
New York City Office of Environmental Remediation**

Date: 10/1/2021

To operators and representatives of disposal facilities and government regulators:

The New York City Office of Environmental Remediation (OER) operates several environmental remediation regulatory programs in New York City that manage light to moderately contaminated properties that are planned for redevelopment. These projects commonly involve the removal of historical fill and soil from properties for development and other purposes. As with any environmental regulatory program, lawful transport and disposal of historic fill and soil is mandatory. It is also our highest priority.

Disposal facilities, recycling facilities and clean fill facilities (collectively, “receiving facilities”) for historic fill and soil may be located in New York or neighboring states. Our research has indicated that a wide range of facility types and a complex set of regulatory requirements and obligations for a receiving facility operation exist within each jurisdiction. Receiving facilities are required to comply with applicable laws and regulations and may operate under state and local authority via permits, licenses, registrations, agreements and other legal instruments that dictate requirements for the material they can receive. Operating requirements may include adherence to applicable chemical standards, guidance levels, criteria, policy or other bases to determine the suitability for receipt of historical fill or soil at a receiving facility. Such requirements may also specify sample frequency, location, sampling method, chemical analytes, or analytical methods. Receiving facility soil/fill sampling requirements often differ from standard remedial investigation protocol performed in the original environmental study of the property.

Given the variability of data requirements for receiving facilities, the wide range of receiving facility types, and the complexity of regulatory requirements and obligations, OER is seeking to assist government regulators and facility operators and their technical representatives to achieve compliance with regulatory requirements for disposal of historic fill and soil at receiving facilities for projects we administer. Further, we seek to ensure that all of the data and information that is developed in OER’s regulatory programs (for instance, site environmental history and soil chemistry) is available to government regulators and to facility managers when making decisions on suitability for disposal to a receiving facility.

This document provides formal notification from OER of the availability of environmental information regarding the physical and chemical content of historical fill and soil that is proposed for transfer to a disposal, recycling or clean fill facility from a property located at:

639 and 641 East 28th Street, Brooklyn NY 11210
OER Site # 19TMP0245K

The above referenced property has undergone regulated environmental investigation and is the subject of remedial action work plan under the authority of OER. All environmental data and information generated during this regulatory process is available online in OER’s Document Repository listed below. Be advised that many properties are also regulated under state environmental law, and additional data may be available from state agencies. OER reserves the right to share this information with applicable state regulators.





<https://a002-epic.nyc.gov/app/workspace/7345/docrepository>

According to New York State DER-10 Technical Guidance for Site Investigation and Remediation, historical fill is non-indigenous fill material deposited on a property to raise its topographic elevation. The origin of historical fill is unknown but it is commonly known to contain ash from wood and coal combustion, slag, clinker, construction debris, dredge spoils, incinerator residue, and demolition debris. Historic fill is a regulated solid waste in the State of New York. Prior to making a determination regarding the suitability of historic fill and/or soil from this property for disposal at this receiving facility, **we strongly recommend that you review all of the data and information available for this property using the EPIC link** listed above. The electronic folder includes:

- A Phase 1 history of use of the property;
- A Remedial Investigation Report for the property which includes:
 - Boring logs that describe physical observations of the historical fill material made by a trained environmental professional;
 - Chemical data for grab samples of historical fill collected during the remedial investigation;
- A Remedial Action Work Plan for the property.

If you have any questions, please contact William Quinones at (212) 788-8484 or wQuinones@dep.nyc.gov for more information.



ENVIRONMENTAL BUSINESS CONSULTANTS

Appendix 3

Daily Report Template



ENVIRONMENTAL BUSINESS CONSULTANTS

**1808 MIDDLE COUNTRY ROAD
RIDGE, NY 11961**

**PHONE 631.504.6000
FAX 631.924.2870**

Generic Template for Daily Status Report**Instructions**

The Daily Status Report submitted to OER should adhere to the following conventions:

- Remove this cover sheet prior to editing.
- Remove all the red text and replace with site-specific information.
- Submit the final version as a Word or PDF file.

Daily Status Reports

Daily status reports providing a general summary of activities for each day of *active remedial work* will be emailed to the OER Project Manager by the end of the following day. Those reports will include:

- Project number and statement of the activities and an update of progress made and locations of work performed;
- Quantities of material imported and exported from the Site;
- Status of on-Site soil/fill stockpiles;
- A summary of all citizen complaints, with relevant details (basis of complaint; actions taken; etc.);
- A summary of CAMP excursions, if any;
- Photograph of notable Site conditions and activities.

The frequency of the reporting period may be revised in consultation with OER project manager based on planned project tasks. Daily email reports are not intended to be the primary mode of communication for notification to OER of emergencies (accidents, spills), requests for changes to the RAWP or other sensitive or time critical information. However, such information will be included in the daily reports. Emergency conditions and changes to the RAWP will be communicated directly to the OER project manager by personal communication. Daily reports will be included as an Appendix in the Remedial Action Report.



ENVIRONMENTAL BUSINESS CONSULTANTS

DAILY STATUS REPORT

Prepared By: Enter Your Name Here

WEATHER	Snow		Rain		Overcast		Partly Cloudy	X	Bright Sun	
TEMP.	< 32		32-50		50-70	X	70-85		>85	

VCP Project No.:	16CVCP000M	E-Number Project No.:	16EHAN000M	Date:	01/01/2016
Project Name:	Name or Address				

Consultant: Person(s) Name and Company Name	Safety Officer: Person(s) Name and Company Name
General Contractor: Person(s) Name and Company Name	Site Manager/ Supervisor: Person(s) Name and Company Name
Work Activities Performed (Since Last Report): Provide details about the work activities performed.	
Working In Grid #: A1, B1, C1	
Samples Collected (Since Last Report): No samples collected or provide details	
Air Monitoring (Since Last Report): No air monitoring performed or provide details Prestart Conditions – PID = 0.0 ppm, Dust = 0.000 High Conditions – PID = 0.0 ppm, Dust = 0.000	
Problems Encountered: No problems encountered or provide details	



ENVIRONMENTAL BUSINESS CONSULTANTS

1808 MIDDLE COUNTRY ROAD
RIDGE, NY 11961

PHONE 631.504.6000
FAX 631.924.2870



ENVIRONMENTAL BUSINESS CONSULTANTS

Planned Activities for the Next Day/ Week:

Provide details about the work activities planned for the next day/ week.

Facility # Name/ Location Type of Waste Solid <u>Or</u> Liquid	Facility # Name Location Type of Waste Solid <u>Or</u> Liquid		Facility # Name Location Type of Waste Solid <u>Or</u> Liquid		Facility # Name Location Type of Waste Solid <u>Or</u> Liquid		Facility # Name Location Type of Waste Solid <u>Or</u> Liquid		##### ABC Facility New York, NY petroleum soils Solid	
(Trucks, Cu.Yds. <u>Or</u> Gallons)	Trucks	Cu. Yds. <u>Or</u> Gallons	Trucks	Cu. Yds. <u>Or</u> Gallons	Trucks	Cu. Yds. <u>Or</u> Gallons	Trucks	Cu. Yds. <u>Or</u> Gallons	Trucks	Cu. Yds.
Today									5	120
Total									25	600

NYC Clean Soil Bank		Receiving Facility: Name/ Address (Approved by OER)				
Tracking No.:	16CCSB000					
Today	Trucks 5	Cu. Yds. 25	Total	Trucks 120	Cu. Yds. 600	

Site Grid Map

Insert the site grid map here



ENVIRONMENTAL BUSINESS CONSULTANTS

Photo Log

Photo 1 – provide a caption	Insert Photo Here – Photo of the entire site
Photo 2 – provide a caption	Insert Photo Here – Photo of the work activities performed



ENVIRONMENTAL BUSINESS CONSULTANTS

1808 MIDDLE COUNTRY ROAD
RIDGE, NY 11961

PHONE 631.504.6000
FAX 631.924.2870



ENVIRONMENTAL BUSINESS CONSULTANTS

Appendix 4

Weekly / Monthly Report Template



ENVIRONMENTAL BUSINESS CONSULTANTS

**1808 MIDDLE COUNTRY ROAD
RIDGE, NY 11961**

**PHONE 631.504.6000
FAX 631.924.2870**



ENVIRONMENTAL BUSINESS CONSULTANTS

WEEKLY / MONTHLY STATUS REPORT

Prepared By: **Enter Your Name Here**

VCP Project No.:	16CVCP000M	E-Number Project No.:	16EHAN000M	Date:	01/01/2016
------------------	-------------------	-----------------------	-------------------	-------	-------------------

Project Name:	Name or Address
Project Updates (Since Last Report): Provide details about the work activities performed.	
Problems Encountered: No problems encountered or provide details	
Planned Activities for the Next three months: Provide details about the future work activities.	

Photo Log

Photo 1 – provide a caption	Insert Photo Here – Photo of the entire site
Photo 2 – provide a caption	Insert Photo Here – Photo of the work activities performed
Photo 3 – provide a caption	Insert Photo Here – Photo of the work activities performed



ENVIRONMENTAL BUSINESS CONSULTANTS

**1808 MIDDLE COUNTRY ROAD
RIDGE, NY 11961**

**PHONE 631.504.6000
FAX 631.924.2870**



ENVIRONMENTAL BUSINESS CONSULTANTS

Appendix 5

Soil Disposal and Trucking Log Sheet



ENVIRONMENTAL BUSINESS CONSULTANTS

**1808 MIDDLE COUNTRY ROAD
RIDGE, NY 11961**

**PHONE 631.504.6000
FAX 631.924.2870**

Soil Disposal and Trucking Log Sheet

[illegible]

Appendix 6

Excavation and Endpoint Sampling Diagrams



LOT 48

LOT 50

**REAR COURTYARD
REMOVE TOP 1 FT**

**AT-GRADE PORTION OF BUILDING
REMOVE TOP 2 to 3 FT**

**CELLAR
EXCAVATE TO 11 FT**

Excavate to 17ft
for Elevator Pit

LOT 17

LOT 11

SIDEWALK

EAST 28th STREET

KEY:

 Property Boundary

SCALE:

0 7.5 15

Scale 1 Inch = 15 feet

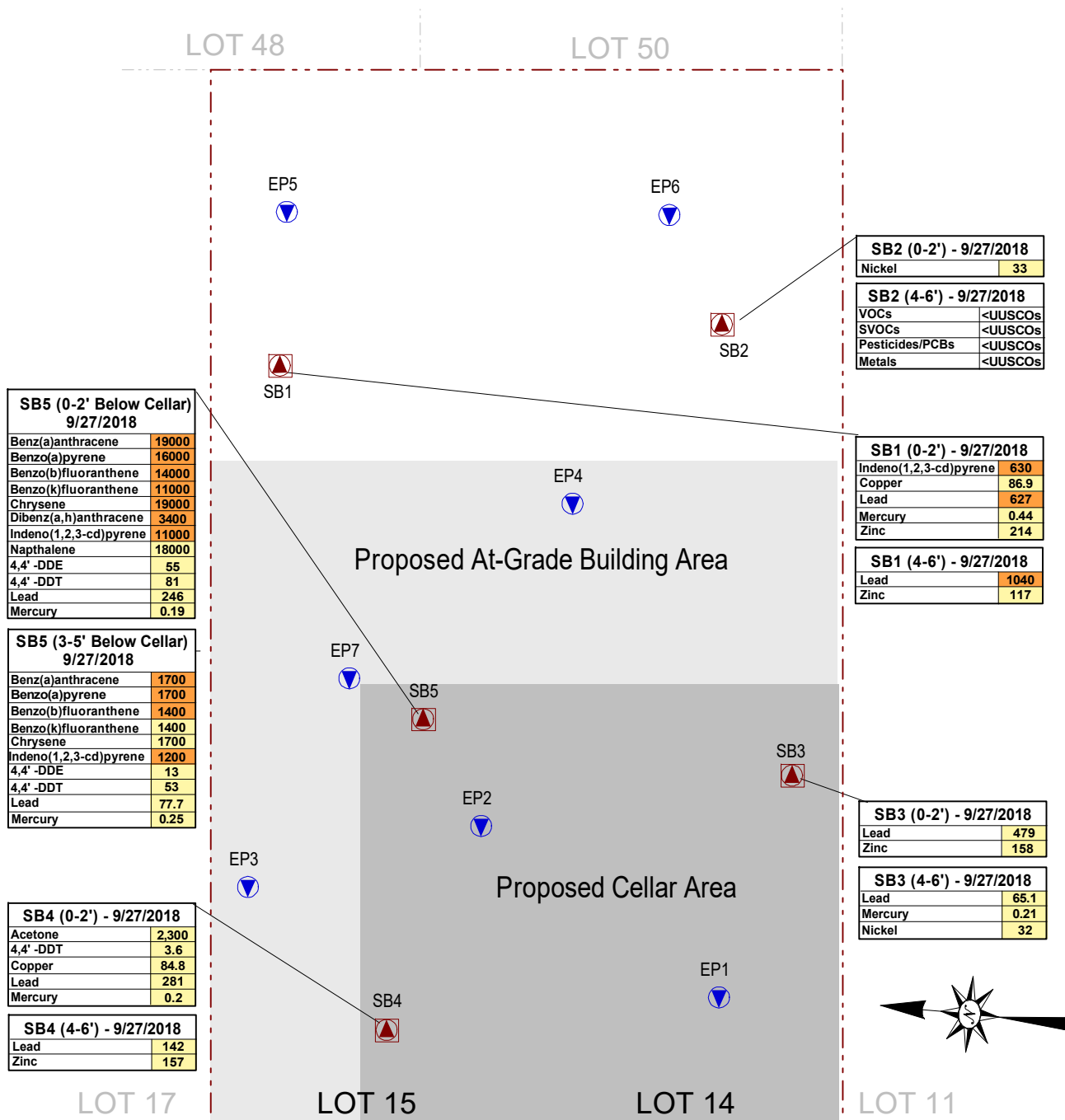



ENVIRONMENTAL BUSINESS CONSULTANTS

Appendix 7

RAWP Certification



ENVIRONMENTAL BUSINESS CONSULTANTS

**1808 MIDDLE COUNTRY ROAD
RIDGE, NY 11961**

**PHONE 631.504.6000
FAX 631.924.2870**

CERTIFICATION

I, Ariel Czemerinski, am currently a registered Professional Engineer licensed by the State of New York. I performed professional engineering services and had primary direct responsibility for designing the remedial program for the site located at 639 and 641 East 28th Street, Brooklyn, New York, site numbers 19TMP0245K, 19EH-A082K and VCP 21CVCP007K. I certify to the following:

- I have reviewed this document and the Stipulation List, to which my signature and seal are affixed.
- Engineering Controls developed for this remedial action were designed by me or a person under my direct supervision and designed to achieve the goals established in this Remedial Action Work Plan for this site.
- The Engineering Controls to be constructed during this remedial action are accurately reflected in the text and drawings of the Remedial Action Work Plan and are of sufficient detail to enable proper construction.
- This Remedial Action Work Plan (RAWP) has a plan for handling, transport and disposal of soil, fill, fluids and other materials removed from the property in accordance with applicable City, State and Federal laws and regulations. Importation of all soil, fill and other material from off-Site will be in accordance with all applicable City, State and Federal laws and requirements. This RAWP has provisions to control nuisances during the remediation and all invasive work, including dust and odor suppression.

Ariel Czemerinski

Name

076508

NYS PE License Number

A. Czemerinski

Signature

8/31/21

Date



I, Kevin Brussee, am a qualified Environmental Professional. I will have primary direct responsibility for implementation of the remedial program for site located at 639 and 641 East 28th Street, Brooklyn, New York, site numbers 19TMP0245K, 19EH-A082K and VCP 21CVCP007K. I certify to the following:

- This Remedial Action Work Plan (RAWP) has a plan for handling, transport and disposal of soil, fill, fluids and other materials removed from the property in accordance with applicable City, State and Federal laws and regulations. Importation of all soil, fill and other material from off-Site will be in accordance with all applicable City, State and Federal laws and requirements. This RAWP has provisions to control nuisances during the remediation and all invasive work, including dust and odor suppression.

KEVIN BRUSSEE

QEP Name

[Signature]

QEP Signature

8/31/21

Date